

OCT 24 1994

COMMISSION

**OTTAWA COUNTY REMONUMENTATION
LAND CORNER RECORDATION CERTIFICATE
Filing Requirement of Act 74, Mich. P.A. 1970**

RECORDED

94 OCT -7 PM 12:33

Dorothy S. Chalmers
REGISTER OF DEEDS
OTTAWA COUNTY, MI

For corners in

Ottawa

(County)

Located in:

Corner Code #

- | | | |
|---------------------------------------|--------------------------|------------------------|
| 1. Public Land Survey | T <u>6N</u> R <u>14W</u> | <u>M-4E1/4 COR</u> |
| | T _____ R _____ | <u>Sec. 12 Blendon</u> |
| | T _____ R _____ | _____ |
| | T _____ R _____ | _____ |
| 2. Property Controlling in Section | S _____ T _____ R _____ | _____ |
| | S _____ T _____ R _____ | _____ |
| 3. Miscellaneous Property in Sec. | S _____ T _____ R _____ | _____ |
| | S _____ T _____ R _____ | _____ |
| 4. Lot No. _____, Recorded Plat _____ | | |
| 5. Private Claims _____ | | |

Register of Deeds Stamp & File Number

	A	B	C	D	E	F	G	H	I	J	K	L	M
2	6	5	4	3	2								
3													
4	7	8	9	10	11	12							
5													
6	18	17	16	15	14	13							
7													
8	19	20	21	22	23	24							
9													
10	30	29	28	27	26	25							
11													
12	31	32	33	34	35	36							
13													

I, Randal D. Feenstra in a field survey on May 27, 19 94, do hereby certify that under requirements of P.A. 74, Michigan P.A. of 1970, the corner points mentioned in lines 1 and 2 above were in conformance with regulations and rules therefore as required in the current manual of survey instructions of the United States Department of the Interior, Bureau of Land Management or by a decree of a Court of Law and/or that the corner points mentioned in lines 3, 4 and 5 above were in conformance with the rules of the Michigan Board of Land Surveyors or by a Decree of a Court of Law, established, re-established, monumented, re-monumented, recovered, found as expressed below:

NOTE: Not more than 4 corners, all in the same town and range, may be recorded on this certificate.

A. Description of original monument and accessories and/or subsequent restoration:

GLO (1838) POST	L-2 Page 115 5/1973)	L-2 Page 193 6/1973)
30" White Oak N31°W 23.8	1/2" Rod	Long Flat Iron
28" Maple N54°W 15.8	SE Guy Pole 45.80'	SW Cor. Serv. Station Fnd NE 76.59'
Samuel Marrs	NW 36" Maple 84.13'	NW Cor Fr. Bldg SE 51.93'
2 Page 721 (1975)	NE, NW cor Citgd Sign Post 85.05'	Center St Sign Post SE 49.05'
2" Iron Pipe		Nail in guy pole SW 47.34'
Georgetown Twp. Cor. N 2.31'	SW Cor. Station NE 79.09'	Nail in PP WNW 120.52'
Guy Pole SE 45.80'		1/2" Iron rod S 2.31'
Maple NW 84.13'	Liber 5 Page 88 (1983)	
Cor. Citgo Sign NE 85.05	Cast Iron Monument	20" Poplar SW 66.68'; 5" Maple SE 75.86'
	Power Pole NE 49.20'	PP ESE 100.28'

B. Description of corner evidence found and/or method applied in restoring or reestablishing corner:
 Found: Cast Iron Monument in Monument Box- accepted as a careful and faithful perpetuation of the position of the original corner.
 Found Witnesses:

Nail SE side PP N40°E	49.21'
BT Spike S side Guy Pole	N70°W 120.45'
Pk Nail S side Guy Pole	N70°W 120.43'
Georgetown Cor.	S 2.35'

P.A. 345 OTTAWA COUNTY

PEER APPROVED 9/22/94

Gordon D. Hedewell

C. Description of monument for corner and accessories established to perpetuate locating the position of the corner:

M-4 Cast Iron Monument
 O.C. Remon. Nail & tag N side 18" Maple S35°E 75.66
 O.C. Remon. Nail & tag SE side PP N40°E 49.19'
 O.C. Remon. Nail & tag E side PP S30°W 97.81'
 O.C. Remon. Nail & tag S side Guy Pole N70°W 120.21'
 West Cor. Sec. 7 Georgetown Twp. S 2.35'
 CL of 48th Avenue and 2' S of Bauer

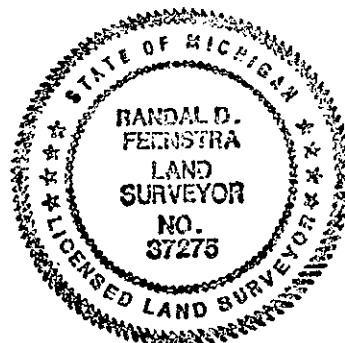

Signed by

Randal D. Feenstra

Date

May 27, 1994

Surveyor's Michigan License No. 37275