

SURVEY & REMONUMENTATION

OCT 24 1994

COMMISSION

OTTAWA COUNTY REMONUMENTATION
LAND CORNER RECORDATION CERTIFICATE
Filing Requirement of Act 74, Mich. P.A. 1970

RECORDED

94 OCT -7 PM 12:34

Dorothy Chellman
REGISTER OF DEEDS
OTTAWA COUNTY, MI

For corners in

Ottawa
(County)

Located In:

Corner Code #

- 1. Public Land Survey T 6N R 14W M-5 SE COR
T _____ R _____ Sec. 12 Blendon
T _____ R _____
T _____ R _____
- 2. Property Controlling S _____ T _____ R _____
in Section S _____ T _____ R _____
- 3. Miscellaneous S _____ T _____ R _____
Property in Sec. S _____ T _____ R _____
- 4. Lot No. _____, Recorded Plat _____
- 5. Private Claims _____

Register of Deeds Stamp & File Number

I, Randal D. Feenstra in a field survey on May 27, 19 94, do hereby certify that under requirements of P.A. 74, Michigan P.A. of 1970, the corner points mentioned in lines 1 and 2 above were in conformance with regulations and rules therefore as required in the current manual of survey instructions of the United States Department of the Interior, Bureau of Land Management or by a decree of a Court of Law and/or that the corner points mentioned in lines 3, 4 and 5 above were in conformance with the rules of the Michigan Board of Land Surveyors or by a Decree of a Court of Law; established, re-established, monumented, re-monumented, recovered, found as expressed below:

NOTE: Not more than 4 corners, all in the same town and range, may be recorded on this certificate.

A	B	C	D	E	F	G	H	I	J	K	L	M
2	6	5	4	3	2	1						
3												
4	7	8	9	10	11	12						
5												
6	18	17	16	15	14	13						
7												
8	19	20	21	22	23	24						
9												
10	30	29	28	27	26	25						
11												
12	31	32	33	34	35	36						
13												

A. Description of original monument and accessories and/or subsequent restoration:

0 (1838)	L-1 Page 783 (1972)	L-3 Page 79 (1976)
Sugar S 1/2°W 33.7	Found Iron	Cast Iron Monument
2" Black Ash N64°W 15.8	NE Cor Hse. SW 153.15'	PP N89°E 65.27'
OST	T Pole W 33.53'	NE Cor. Hse. S47°W 153.13
uel Marrs	PP E 64.81'	T Pole N86°W 33.52'
	T Iron N 4.62'	12" Twin Cherry N34°W 91.02'
		Georgetown Cor. N 4.62'

B. Description of corner evidence found and/or method applied in restoring or reestablishing corner:

Found; Cast Iron Monument in Monument Box -- accepted as a careful and faithful perpetuation of the original corner.

Found Witnesses:
Spike in S side PP W 33.06'
Nail & tag N side PP W 33.55'
Square spike N side PP W 33.56'
NE Cor. Hse S 50°W 152.21'
Georgetown Cor. N 4.62'

P.A. 345 OTTAWA COUNTY

PEER APPROVED 8/22/94

George P. Pedersen

C. Description of monument for corner and accessories established to perpetuate locating the position of the corner:

M-5 Cast Iron Monument
O.C. Remon. Nail & tag S side PP E 46.94'
O.C. Remon. Nail & tag W side Fence Post S65°W 58.01'
O.C. Remon. Nail & tag N side PP W 33.59'
O.C. Remon. Nail & tag E side 24" Maple S35°W 103.78'
NE Cor. Sec. 18 Georgetown Twp. N 4.62'
2' East of 48th Avenue

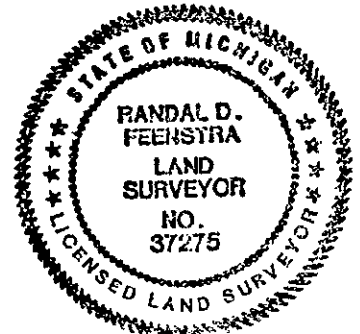

Signed by Randal D. Feenstra

Date May 27, 1994

Surveyor's Michigan License No. 37275