

REMONUMENTATION

NOV 19 1993

COMMISSION

LAND CORNER RECORDATION CERTIFICATE

Filing Requirement of Act 74, Mich. P.A. 1970
OTTAWA COUNTY REMONUMENTATION

RECORDED

393 SEP 29 PM 3:13

For corners in
OTTAWA
(County)

Located In: BLEADON TWP. Corner Code #:

1. Public Land Survey

T. 6N. R. 14W. M-7, NE Cor-24
T. 6N. R. 14W. K-8, W 1/2 Cor-24

2. Property Controlling
in Section

S. T. R.
S. T. R.

3. Miscellaneous
Property in Sec.

S. T. R.
S. T. R.

Regatta
REGISTER OF DEEDS
OTTAWA COUNTY, MI

Register of Deeds Stamp & File Number

4. Lot No. _____, Recorded Plat _____

5. Private Claims _____

	A	B	C	D	E	F	G	H	I	J	K	L	M
2	6		5		4		3		2		1		
3													
4	7		8		9		10		11		12		
5													
6	18		17		16		15		14		13		
7													
8	19		20		21		22		23		24		
9													
10	30		29		28		27		26		25		
11													
12	31		32		33		34		35		36		
13													

I, Randal D. Feenstra in a field survey on July 13, 19 93, do hereby certify that under requirements of P.A. 74, Michigan P.A. of 1970, the corner points mentioned in lines 1 and 2 above were in conformance with regulations and rules therefore as required in the current manual of survey instructions of the United States Department of the Interior, Bureau of Land Management or by a decree of a Court of Law and/or that the corner points mentioned in lines 3, 4 and 5 above were in conformance with the rules of the Michigan Board of Land Surveyors or by a Decree of a Court of Law; established, re-established, monumented, re-monumented, recovered, found as expressed below:

NOTE: Not more than 4 corners, all in the same town and range, may be recorded on this certificate.

A. Description of original monument and accessories and/or subsequent restoration:

M-7 = LCRC#'s L-3, P-26; L-5, P-125; L-5, P-273
K-8 = LCRC#'s L-1, P-329; L-4, P-353; L-5, P-281

B. Description of corner evidence found and/or method applied in restoring or reestablishing corner:

M-7 Found Cast Iron Monument in Box
And Witnesses Per
LCRC # L-5, P-273
K-8 Found Cast Iron Monument
And Witnesses
LCRC # L-5, P-281

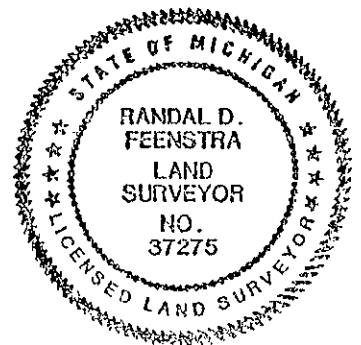

C. Description of monument for corner and accessories established to perpetuate locating the position of the corner:

M-7-Cast Iron Monument per L-5, P-273, Ottawa County, MI, and is accepted as a careful and faithful perpetuation of the position of the original corner.
O.C. Remon. Nail & Tag in P.Pole S40°W 61.80
O.C. Remon. Nail & Tag in Light Pole S55°E 30.16
O.C. Remon. Nail & Tag in 36" Oak N28°W 59.72
Georgetown Twp. Cor. (Cast Iron Monument in box) S0°E 13.23
CL. 48th Ave.- 0° West CL Tyler 13' South
K-8-Cast Iron Monument per L-5, P-281, Ottawa County, MI, and is accepted as a careful and faithful perpetuation of the position of the original corner.
O.C. Remon. Nail & Tag in P.Pole N90°E 33.21
O.C. Remon. Nail & Tag in P.Pole N20°W 116.00
SW cor bottom step to porch-Hse.#6808 N50°E 114.63
NE cor. concrete top of N'yly stone pillar N90°W 32.35
CL. 56th - 4'E

Signed by Randal D. Feenstra Date July 13, 1993

Surveyor's Michigan License No. 37275