

SURVEY &
REMONUMENTATION

FEB 18 1994

OTTAWA COUNTY REMONUMENTATION
LAND CORNER RECORDATION CERTIFICATE
Filing Requirement of Act 74, Mich. P.A. 1970

RECORDED

93 NOV -8 PM 1:58

Ryszard Chalkman
REGISTER OF DEEDS
OTTAWA COUNTY, MI

For corners in **COMMISSION**

<u>Ottawa</u> (County)	Located In:	Corner Code #
1. Public Land Survey	T <u>6N</u> R <u>14W</u>	<u>M-11, NE COR,</u> <u>SEC. 36, Blendon</u>
	T _____ R _____	_____
	T _____ R _____	_____
	T _____ R _____	_____
2. Property Controlling in Section	S _____ T _____ R _____	_____
	S _____ T _____ R _____	_____
3. Miscellaneous Property in Sec.	S _____ T _____ R _____	_____
	S _____ T _____ R _____	_____

Register of Deeds Stamp & File Number

4. Lot No. _____, Recorded Plat _____
5. Private Claims _____

	A	B	C	D	E	F	G	H	I	J	K	L	M
2	6		5		4		3		2		1		
3													
4	7		8		9		10		11		12		
5													
6	18		17		16		15		14		13		
7													
8	19		20		21		22		23		24		
9													
10	30		29		28		27		26		25		
11													
12	31		32		33		34		35		36		
13													

I, Randal D. Feenstra in a field survey on July 15, 19 93, do hereby certify that under requirements of P.A. 74, Michigan P.A. of 1970, the corner points mentioned in lines 1 and 2 above were in conformance with regulations and rules therefore as required in the current manual of survey instructions of the United States Department of the Interior, Bureau of Land Management or by a decree of a Court of Law and/or that the corner points mentioned in lines 3, 4 and 5 above were in conformance with the rules of the Michigan Board of Land Surveyors or by a Decree of a Court of Law; established, re-established, monumented, re-monumented, recovered, found as expressed below:

NOTE: Not more than 4 corners, all in the same town and range, may be recorded on this certificate.

A. Description of original monument and accessories and/or subsequent restoration:

M-11 = L.C.R.C.#'s L-3, P-115; L-5, P-88

B. Description of corner evidence found and/or method applied in restoring or reestablishing corner:

M-11 Found cast iron monument - accepted as a careful and faithful perpetuation of the Found witnesses per Liber 5, Page 88. position of the original corner.

P. Pole SW 50.46
30" oak SSW 84.73
Georgetown cor. N 4.00 feet

C. Description of monument for corner and accessories established to perpetuate locating the position of the corner:

M-11 - Cast iron monument
O.C. Remon. Nail & Tag in P. Pole S50°W 50.46'
O.C. Remon. Nail & Tag in P. Pole S50°E 54.40'
O.C. Remon. Nail & Tag in 30" oak S80°W 84.25'
Georgetown Twp. Corner N0°E 4.00'
CL of hydrant N30°E 50.73'
On CL 48th St., 2' south of CL Van Buren

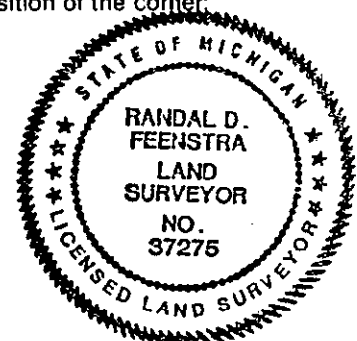

Signed by Randal D. Feenstra Date Sept. 29; 1993

Surveyor's Michigan License No. 37275