

1993
COMMISSION

OTTAWA COUNTY REMONUMENTATION
LAND CORNER RECORDATION CERTIFICATE
Filing Requirement of Act 74, Mich. P.A. 1970

RECORDED

93 DEC 15 AM 9:26

For corners in

Ottawa (County)	Located in:	Corner Code #
1. Public Land Survey	T 6N R 15W	D-7
	T _____ R _____	(S 1/4 cor. Sec.
	T _____ R _____	17, Olive Twp.)
	T _____ R _____	
2. Property Controlling in Section	S _____ T _____ R _____	
	S _____ T _____ R _____	
3. Miscellaneous Property in Sec.	S _____ T _____ R _____	
	S _____ T _____ R _____	

Douglas J. Koning
REGISTER OF DEEDS
OTTAWA COUNTY, MI

Register of Deeds Stamp & File Number

4. Lot No. _____, Recorded Plat _____
5. Private Claims _____

I, Douglas J. Koning, in a field survey on November 30, 1993, do hereby certify that under requirements of P.A. 74, Michigan P.A. of 1970, the corner points mentioned in lines 1 and 2 above were in conformance with regulations and rules therefore as required in the current manual of survey instructions of the United States Department of the Interior, Bureau of Land Management or by a decree of a Court of Law and/or that the corner points mentioned in lines 3, 4 and 5 above were in conformance with the rules of the Michigan Board of Land Surveyors or by a Decree of a Court of Law; established, re-established, monumented, re-monumented, recovered, found as expressed below:

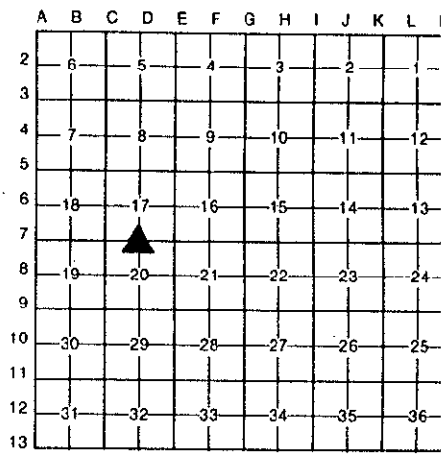

NOTE: Not more than 4 corners, all in the same town and range, may be recorded on this certificate.

A. Description of original monument and accessories and/or subsequent restoration:

L.C.R.C. L. 2 P. 371 1973	L.C.R.C. L. 6 P. 2 1989
D-7 Set Cast Iron Mon. Midway on line between Sec. Corners.	D-7 Set CIM
Most Northerly of 2 poles S45°E 195.11'	Screw in S side of 3 1/2" Steel Vent Pipe WNW 69.
Centerline Pipeline Ventpipe S70°W 66.23'	Centerline top of 12" CMP E End Culvert WSW 86.
E End Conc. Culvert S80°W 85.35'	Nail in W side of 4"X4" Wood post S 39.
	Most Northerly 2 PP SE 195.

B. Description of corner evidence found and/or method applied in restoring or reestablishing corner:

D-7 Found Cast Iron Mon. in Box	
Found Nail N side of most Northerly of 2 P Poles	S45°E 195.14'
Screw S side of steel gas vent pipe	WNW 69.96'
Nail in W side of 4"X4" wood post	S 39.04'

This marker is accepted as a careful and faithful perpetuation of the original corner.

C. Description of monument for corner and accessories established to perpetuate locating the position of the corner:

D-7 Cast Iron Mon in Box (in centerline E-W road)	
On line 0.10' W of Midpoint	
Set Nail and O.C. Remon Tag on Ely side PP	S30°E 195.87'
Set P.K. and O.C. Remon Tag Top Center E End 12" CMP	S60°W 87.17'
Found Screw in S side 3 1/2" Steel Gas Vent Pipe	N70°W 69.94'
Set Nail and O.C. Remon Tag in SW side PP	N60°W 262.52'
Set Nail and O.C. Remon Tag in S side PP	N85°W 311.20'

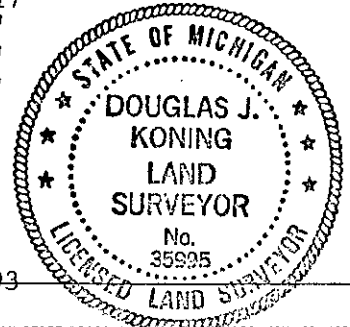

Signed by Douglas J. Koning
Surveyor's Michigan License No. 35995

Date December 6, 1993