

1993
 COUNTY OF OTTAWA

OTTAWA COUNTY REMONUMENTATION
 LAND CORNER RECORDATION CERTIFICATE
 Filing Requirement of Act 74, Mich. P.A. 1970

RECORDED

93 DEC 15 AM 9:26

Daphne K. Kellerman
 REGISTER OF DEEDS
 OTTAWA COUNTY, MI

For corners in

<u>Ottawa</u> (County)	Located In:	Corner Code #
1. Public Land Survey	T <u>6N</u> R <u>15W</u>	<u>E-6</u>
	T _____ R _____	(E 1/4 Cor. Sec.
	T _____ R _____	<u>17, Olive Twp.</u>)
	T _____ R _____	_____
2. Property Controlling in Section	S _____ T _____ R _____	_____
	S _____ T _____ R _____	_____
3. Miscellaneous Property in Sec.	S _____ T _____ R _____	_____
	S _____ T _____ R _____	_____

Register of Deeds Stamp & File Number

4. Lot No. _____, Recorded Plat _____
 5. Private Claims _____

I, Douglas J. Koning, in a field survey on November 30, 19 93, do hereby certify that under requirements of P.A. 74, Michigan P.A. of 1970, the corner points mentioned in lines 1 and 2 above were in conformance with regulations and rules therefore as required in the current manual of survey instructions of the United States Department of the Interior, Bureau of Land Management or by a decree of a Court of Law and/or that the corner points mentioned in lines 3, 4 and 5 above were in conformance with the rules of the Michigan Board of Land Surveyors or by a Decree of a Court of Law; established, re-established, monumented, re-monumented, recovered, found as expressed below:

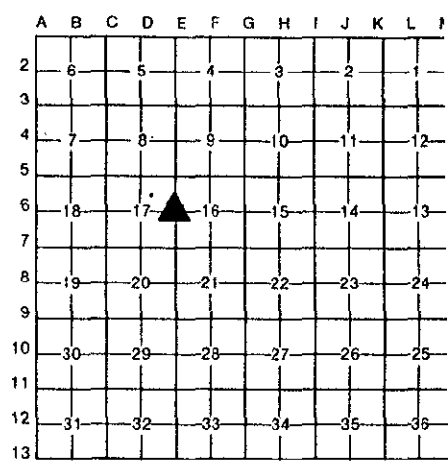

NOTE: Not more than 4 corners, all in the same town and range, may be recorded on this certificate.

A. Description of original monument and accessories and/or subsequent restoration:

L.C.R.C. L.2 P. 709	1974	L.C.R.C. L. 4 P. 249	1981
E-6 T. Pole	S55°W 36.11'	E-6 Set Cast Iron Monument	
14" W. Cherry	N70°W 53.60'	30" Maple	ESE 30.90'
30" Maple	S80°W 31.47'	30" Maple	SSW 121.77'
Guard Post	S30°E 24.30'	5" Sassafrass	W 57.15'
Guard Post	S45°W 8.85'	Tw. Cherry	NW 53.41'

B. Description of corner evidence found and/or method applied in restoring or reestablishing corner:

E-6 Found Cast Iron
 Nail and Tag N side 42" Maple ESE 30.93'
 Conc. Nail NE side Tw. Cherry NW 53.44'

This marker is accepted as a careful and faithful perpetuation of the original corner.

C. Description of monument for corner and accessories established to perpetuate locating the position of the corner:

E-6 Cast Iron Monument (10' S and 5' West of centerline "X")
 Set Nail and O.C. Remon Tag S side 14" Tw Cherry N70°W 53.29'
 Set Nail and O.C. Remon Tag E side 40" Oak S20°W 121.61'
 Set Nail and O.C. Remon Tag SW side P.Pole S50°E 127.23'
 Set Nail and O.C. Remon Tag N side 42" Maple S80°E 30.67'
 Set Nail and O.C. Remon Tag Top Center 36" CMP S75°E 23.65'

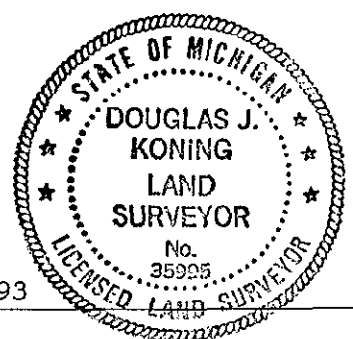

Signed by Douglas J. Koning Date December 6, 1993
 Surveyor's Michigan License No. 35995