

SURVEY & REMONUMENTATION

APR 05 1996

COMMISSION

**OTTAWA COUNTY REMONUMENTATION
LAND CORNER RECORDATION CERTIFICATE**

RECORDED
95 DEC 12 PM 4:50

For corners in

Filing Requirement of Act 74, Mich. P.A. 1970

Douglas J. Koning
REGISTER OF DEEDS
OTTAWA COUNTY, MI

Ottawa (County)	Located in:	Corner Code #
1. Public Land Survey	T 6N R 15W	E-11
	T _____ R _____	(SW cor., Sec. 28
	T _____ R _____	Olive Twp.)
	T _____ R _____	
2. Property Controlling in Section	S _____ T _____ R _____	
	S _____ T _____ R _____	
3. Miscellaneous Property in Sec.	S _____ T _____ R _____	
	S _____ T _____ R _____	
4. Lot No. _____, Recorded Plat _____		
5. Private Claims _____		

Register of Deeds Stamp & File Number

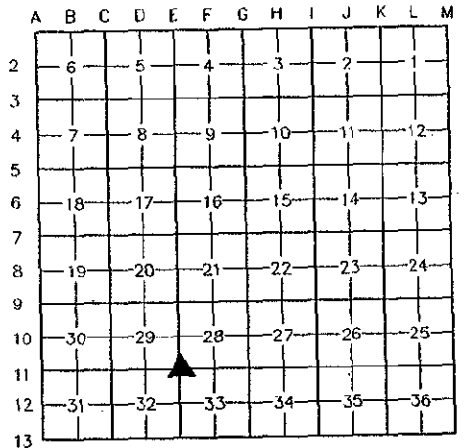

I, Douglas J. Koning, in a field survey on November 24, 1995, do hereby certify that under requirements of P.A. 74, Michigan P.A. of 1970, the corner points mentioned in lines 1 and 2 above were in conformance with regulations and rules therefore as required in the current manual of survey instructions of the United States Department of the Interior, Bureau of Land Management or by a decree of a Court of Law and/or that the corner points mentioned in lines 3, 4 and 5 above were in conformance with the rules of the Michigan Board of Land Surveyors or by a Decree of a Court of Law; established, re-established, monumented, re-monumented, recovered, found as expressed below:

NOTE: Not more than 4 corners, all in the same town and range, may be recorded on this certificate.

A. Description of original monument and accessories and/of subsequent restoration:

E-11 Government Notes	L.C.R.C. Liber 2, Page 85 March 1973	L.C.R.C. Liber 3, Page 211 November 1977
Calvin Britain D.S.	E-11 Found Iron Pipe	E-11 Set Cast Iron Monument
Set Post May 1832	Power Pole SE 74.53'	Power Pole SE 74.90'
Beech 10" S28°E 15 Links	Power Pole N80°W 180.81'	Centerline Street Sign SE 40.7'
Leo 12" S64°W 35 Links	Telephone Pole NW 102.11'	Telephone Pole NW 102.8'
Calvin Britain D.S.	Centerline end 36" Culvert SW 28.50'	
	Centerline end 36" Culvert SE 29.15'	
	Street Sign SE 40.35'	

B. Description of corner evidence found and/or method applied in restoring or reestablishing corner.

E-11 Found Cast Iron Monument (1" below surface Gravel Road)	
Street Sign	SE 40.67'
Centerline end 36" culvert	SW 28.37'
Centerline end 36" culvert	SE 28.90'
Found P.K. Nail NE side Power Pole	SE 76.83'
Centerline old Power Pole stump	SE 74.86'

P.A. 345 OTTAWA COUNTY
PEER APPROVED 12/11/95

Douglas J. Koning

This marker is accepted as a careful and faithful perpetuation of the original corner.

C. Description of monument for corner and accessories established to perpetuate locating the position of the corner.

E-11 Cast Iron Monument (in Centerline "X" of Roads)	
Set Remon Tag & Nail in SW side power pole	S40°E 61.95'
Set Remon Tag & Nail in SE side Guy Pole	N70°E 76.77'
Set Remon Tag & Nail in S side 10" Maple	N25°W 94.75'
Set Remon Tag & Nail in SE side power pole	N35°W 60.94'

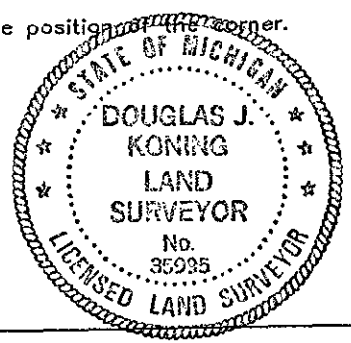

Signed by Douglas J. Koning
Surveyor's Michigan License No. 35995

Date 12-11-95