

SURVEY & REMONUMENTATION

APR 24 1995

COMMISSION

**OTTAWA COUNTY REMONUMENTATION
LAND CORNER RECORDATION CERTIFICATE**
Filing Requirement of Act 74, Mich. P.A. 1970

RECORDED

94 DEC 15 AM 11:45

Robert A. Kellman
REGISTER OF DEEDS
OTTAWA COUNTY, MI

For corners in

Ottawa

(County)

Located In:

Corner Code #

- | | | |
|---------------------------------------|--------------------------|------------------|
| 1. Public Land Survey | T <u>6N</u> R <u>15W</u> | G-4, W 1/4 Cor. |
| | T _____ R _____ | Sec. <u>10</u> |
| | T _____ R _____ | <u>OLIVE TWP</u> |
| | T _____ R _____ | |
| 2. Property Controlling in Section | S _____ T _____ R _____ | |
| | S _____ T _____ R _____ | |
| 3. Miscellaneous Property in Sec. | S _____ T _____ R _____ | |
| | S _____ T _____ R _____ | |
| 4. Lot No. _____, Recorded Plat _____ | | |
| 5. Private Claims _____ | | |

Register of Deeds Stamp & File Number

A	B	C	D	E	F	G	H	I	J	K	L	M
2	6	5	4	3	2	1						
3												
4	7	8	9	10	11	12						
5												
6	18	17	16	15	14	13						
7												
8	19	20	21	22	23	24						
9												
10	30	29	28	27	26	25						
11												
12	31	32	33	34	35	36						
13												

I, Randal D. Feenstra, in a field survey on December 8, 1994, do hereby certify that under requirements of P.A. 74, Michigan P.A. of 1970, the corner points mentioned in lines 1 and 2 above were in conformance with regulations and rules therefore as required in the current manual of survey instructions of the United States Department of the Interior, Bureau of Land Management or by a decree of a Court of Law and/or that the corner points mentioned in lines 3, 4 and 5 above were in conformance with the rules of the Michigan Board of Land Surveyors or by a Decree of a Court of Law; established, re-established, monumented, re-monumented, recovered, found as expressed below:

NOTE: Not more than 4 corners, all in the same town and range, may be recorded on this certificate.

A. Description of original monument and accessories and/or subsequent restoration:

- | | | | |
|--------------------------|---------------------------|----------------------------|--------------------|
| G.L.O. by Calvin Britain | L-1, P-369(1972) | L-3, P-381 (1979) | L-6, P-55(1990) |
| April, 1832 | IRON | 1/2" IRON | C.I.M. |
| Set POST | Triple Sycamore WSW 39.22 | Tri. Sycamore S75 W 39.22' | 44" Maple |
| 14" Beech N84 E 22 links | 30" Maple WNW 67.75 | St. Sign E 31.40' | P Pole SW 67.55 |
| 10" Birch N79 W 17 links | Tw. Cherry NNW 93.50 | Tw. Cherry N13 W 93.50' | 28" Maple NE 36.46 |
| | 30" Maple NNE 64.73 | 30" Maple N25 E 64.73' | |
| | 24" Maple NE 35.30 | | |
| | T.Pole NW 43.10 | | |
| | CL St. Sign E 31.40 | | |

B. Description of corner evidence found and/or method applied in restoring or reestablishing corner:

Found: C.I.M. in box and is accepted as a careful and faithful perpetuation of the position of the original corner.

Nail in W side 30" Maple NE 36.18'
Nail in SE side P. Pole SW 67.71'

C. Description of monument for corner and accessories established to perpetuate locating the position of the corner:

- G-4 C.I.M. in box
- O.C. Remon. Nail & Tag in W side 30" Maple N50 E 36.20'
O.C. Remon Nail & Tag in S side P.Pole N90 E 82.44'
O.C. Remon Nail & Tag in SE side P. Pole S30 W 67.60'
O.C. Remon Nail & Tag in S side 14" Maple N45 W 84.90'
On CL "X" Crosswell Street and 120th Avenue

P.A. 345 OTTAWA COUNTY
PEER APPROVED 12/12/94
 Gordon P. Hedewell

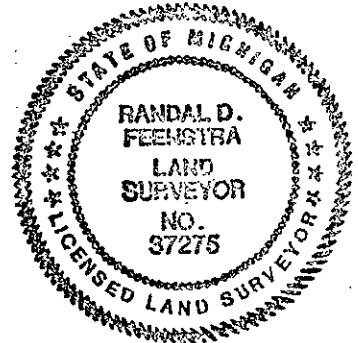

Signed by Randal D. Feenstra

Date December 8, 1994

Surveyor's Michigan License No. 37275