

SURVEY & REMONUMENTATION

JUN 28 1999

RECORDED

98 NOV -4 PM 2:31

Ray Habelt
REGISTER OF DEEDS
OTTAWA COUNTY, MI

SECTION

OTTAWA COUNTY REMONUMENTATION
LAND CORNER RECORDATION CERTIFICATE

For corners in Ottawa Located in: Corner Code #
(County)

- | | | |
|---------------------------------------|---|---------------------|
| 1. Public Land Survey | T <u>6N</u> R <u>R15W</u> | H-1 |
| | T <u> </u> R <u> </u> | (N 1/4 cor., Sec. 3 |
| | T <u> </u> R <u> </u> | Olive Twp.) |
| | T <u> </u> R <u> </u> | |
| 2. Property Controlling in Section | S <u> </u> T <u> </u> R <u> </u> | |
| | S <u> </u> T <u> </u> R <u> </u> | |
| 3. Miscellaneous Property in Sec. | S <u> </u> T <u> </u> R <u> </u> | |
| | S <u> </u> T <u> </u> R <u> </u> | |
| 4. Lot No. _____, Recorded Plat _____ | | |
| 5. Private Claims _____ | | |

Register of Deeds Stamp & File Number

	A	B	C	D	E	F	G	H	I	J	K	L	M
2	6	5	4	3	2	1							
3													
4	7	8	9	10	11	12							
5													
6	18	17	16	15	14	13							
7													
8	19	20	21	22	23	24							
9													
10	30	29	28	27	26	25							
11													
12	31	32	33	34	35	36							
13													

I, Douglas J. Koning, in a field survey on October, 1998, do hereby certify that under requirements of P.A. 74, Michigan P.A. of 1970, the corner points mentioned in lines 1 and 2 above were in conformance with regulations and rules therefore as required in the current manual of survey instructions of the United States Department of the Interior, Bureau of Land Management or by a decree of a Court of Law and/or that the corner points mentioned in lines 3, 4 and 5 above were in conformance with the rules of the Michigan Board of Land Surveyors or by a Decree of a Court of Law; established, re-established, monumented, re-monumented, recovered, found as expressed below:

NOTE: Not more than 4 corners, all in the same town and range, may be recorded on this certificate.

A. Description of original monument and accessories and/or subsequent restoration:

H-1 Government Notes did not set	L.C.R.C. Liber 1, Page 313, April 1972	L.C.R.C. Liber 6, Page 133, May 1991
	H-1 Found O.C.R.C. Marker	H-1 Cast Monument
	12" Oak NNW 33.36'	East 57.28' to 1/2" Iron
	Twin 18" Oak SSE 61.00'	N55°E 70.35' to Large Nail S side 24" Oak
	Twin 12" Oak SE 94.98'	S60°E 87.65' to Nail NE side 8" Maple
	18" Oak NE 69.83'	S15°W 40.58' to Nail NW side 12" Oak
	Centerline Gravel N 14'	S45°W 55.41' to Nail NW side 8" Cherry
		N45°W 59.40' to Nail SW side 18" Sassafras
	L.C.R.C. Liber 1, Page 139, November 1971	
	H-1 Robinson Corner East 57.48'	
	Nail in face of Twin Oak 20" Oak SSE 60.99'	
	Nail in face of Twin 12" Oak SE 95.05'	
	Nail in face of 18" Oak NE 69.80'	
	Nail in face of 14" Oak NW 33.36'	

B. Description of corner evidence found and/or method applied in restoring or reestablishing corner.

H-1 Found Cast Iron Monument in Monument Box (0.28' South of Township line)
 Found Large Nail S side 24" Oak N55°E 70.35'
 Found Nail in NW side 8" Cherry S45°W 55.41'
 Found Nail in SW side 18" Sassafras N45°W 59.40'

This corner was not monumented by the original GLO survey. This monument is accepted as the best available evidence of the position of the corner.

C. Description of monument for corner and accessories established to perpetuate locating the position of the corner

H-1 Cast Iron Monument 0.28' South of Township line in Monument Box
 Ottawa County Remon Cap and Iron (H-13, T7N, R15W) N90°E 57.51'
 Set Remon Tag & Nail in NE side 12" Oak S15°E 41.04'
 Set Remon Tag & Nail in SE side Twin 14" Oak (Base 24") N25°E 40.60'
 Set Remon Tag & Nail in SW side 26" Oak N25°W 34.51'
 Set Remon Tag & Nail in NW side 10" Cherry S45°W 55.34'
 Set Remon Tag & Nail in SW side 20" Sassafras S60°W 59.47'
 Monument in Centerline of East-West Road

\$11.00 CORNER
 Receipt #18213
 \$2.00 PHOTO
 Receipt #18213

(see sketch on back)

Signed by Douglas J. Koning Date 10-19-98
 Surveyor's Michigan License No. 35995

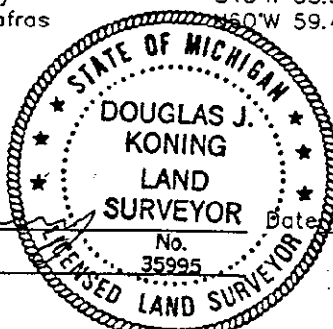

USA 004 PAGE 236

SURVEY &
REMONUMENTATION

JUN 28 1999

NO SCALE



SECTION

SECTION 3, 16N, R15W
OLIVE TOWNSHIP,

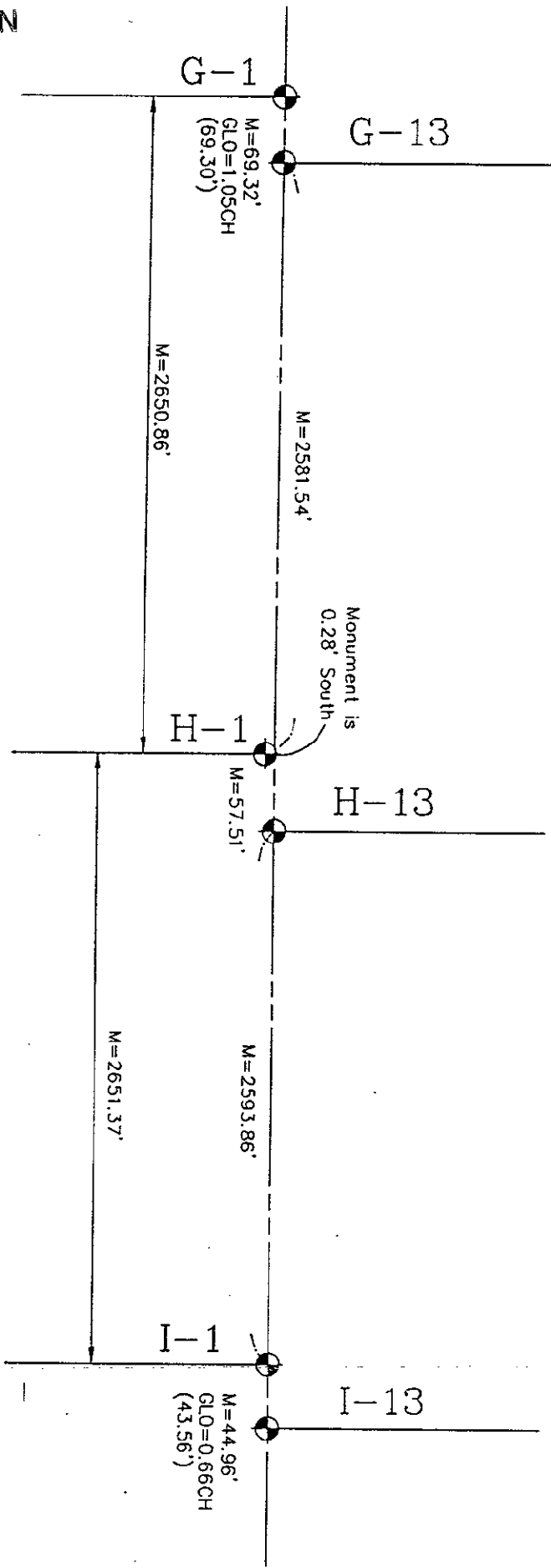

SECTION 34, 17N, R15W
ROBINSON TOWNSHIP