

FEB 24 2000

SECTION

OTTAWA COUNTY REMONUMENTATION  
LAND CORNER RECORDATION CERTIFICATE

*Doug Schiltan*  
REGISTER OF DEEDS  
OTTAWA COUNTY, MI

For corners in

Filing Requirement of Act 74, Mich. P.A. 1970

Ottawa (County)	Located in:	Corner Code #
1. Public Land Survey	T 6N R15W	K-1
	T R	(NW cor., Sec. 1
	T R	Olive Twp.)
	T R	
	T R	
2. Property Controlling in Section	S T R	
	S T R	
3. Miscellaneous Property in Sec.	S T R	
	S T R	

Register of Deeds Stamp & File Number

- 4. Lot No. \_\_\_\_\_, Recorded Plat \_\_\_\_\_
- 5. Private Claims \_\_\_\_\_

	A	B	C	D	E	F	G	H	I	J	K	L
2	6	5	4	3	2	1						
3												
4	7	8	9	10	11	12						
5												
6	18	17	16	15	14	13						
7												
8	19	20	21	22	23	24						
9												
10	30	29	28	27	26	25						
11												
12	31	32	33	34	35	36						
13												

I, Douglas J. Koning, in a field survey on August 26, 1999, do hereby certify that under requirements of P.A. 74, Michigan P.A. of 1970, the corner points mentioned in lines 1 and 2 above were in conformance with regulations and rules therefore as required in the current manual of survey instructions of the United States Department of the Interior, Bureau of Land Management or by a decree of a Court of Law and/or that the corner points mentioned in lines 3,4 and 5 above were in conformance with the rules of the Michigan Board of Land Surveyors or by a Decree of a Court of Law; established, re-established, monumented, re-monumented, recovered, found as expressed below:

NOTE: Not more than 4 corners, all in the same town and range, may be recorded on this certificate.

A. Description of original monument and accessories and/or subsequent restoration:

I-1 Government Notes Set Post May 1832 By Calvin Britain D.S. Hemlock 6" S39°E 10 Links Leo 4" S45°W 25 Links	L.C.R.C. Liber 3, Page 90, June 1976, (D. Greer) K-1 Cast Iron Monument Robinson Township corner 40" Cherry Telephone pole Telephone pole	E 89.10' SE 90.70' SW 50.34' NW 77.84'	L.C.R.C. Liber 6, Page 135, May 1991, (R. Milliron) K-1 Set Cast Monument East 89.11 to Robinsons corner N35E 57.77' to nail S side power pole NSW 72.50' to Se corner building N40W 104.93' to SE corner building S40W 50.41' to nail NW side wood post S20E 90.26' to Nail & Tag N side 36" Cherry
	L.C.R.C. Liber 5, Page 339, November 1988, (M. Rosema) K-1 Cast Iron Monument Nail & Tag #18435 in NW side 40" Cherry tree SE corner frame & metal building SW corner frame & metal building Robinson Corner (Cast Iron Monument)	SW 90.70' NNW 72.53' NW 104.98' E 89.17'	

B. Description of corner evidence found and/or method applied in restoring or reestablishing corner.

K-1 Cast Iron Monument in Box 0.51' South of Township line  
Robinson Corner (K-13, T7N, R15W) East 89.00'  
SE corner frame & metal building (foundation) NNW 72.28'  
SW corner frame & metal building (foundation) NW 104.78'

*9/13/99*  
*DK*

This marker is accepted as a careful and faithful perpetuation of the original corner.

C. Description of monument for corner and accessories established to perpetuate locating the position of the corner.

K-1 Cast Iron Monument in Mon box (0.51' South of township line)  
Set Remon Tag & Nail in SE side power pole N37°E 57.73'  
Set Remon Tag & Nail in S side 14" Pine N47°W 175.58'  
Set Remon Tag & Nail in SE side power pole S54°W 183.47'  
Set Remon Tag & Nail in N side power pole S55°E 186.67'  
Top centerline hydrant N79°E 128.53'  
Robinson Corner (K-13, T7N, R15W) East 89.00'

(see sketch on back)

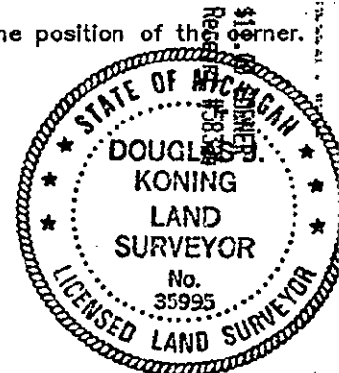

Signed by Douglas J. Koning  
Surveyor's Michigan License No. 35995

Date 9-13-99

Liber 4 Page 404

FEB 24 2000

SECTION

