

FEB 24 2000

RECORDED

OTTAWA COUNTY REMONUMENTATION

99 DEC -2 PM 1:14

SECTION

LAND CORNER RECORDATION CERTIFICATE
Filing Requirement of Act 74, Mich. P.A. 1970

Randal D. Feenstra
REGISTER OF DEEDS
OTTAWA COUNTY, MICH.

For corners in

Ottawa (County)	Located In: Olive Twp.	Corner Code #
	6N 15W	M-8 E 1/4 cor. Sec. 24
1. Public Land Survey	T___ R___	_____
	T___ R___	_____
	T___ R___	_____
	T___ R___	_____
2. Property Controlling in Section	S___ T___ R___	_____
	S___ T___ R___	_____
3. Miscellaneous Property in Sec.	S___ T___ R___	_____
	S___ T___ R___	_____

Register of Deeds Stamp & File Number

4. Lot No. _____, Recorded Plat _____
5. Private Claims _____

I, Randal D. Feenstra, in a field survey on Feb. 23, 1999 do hereby state that under requirements of P.A. 74, Michigan P.A. of 1970, the corner points mentioned in lines 1 and 2 above were in conformance with regulations and rules therefore as required in the current manual of survey instructions of the United States Department of the Interior, Bureau of Land Management or by a decree of a Court of Law and for that the corner points mentioned in lines 3, 4 and 5 above were in conformance with the rules of the Michigan Board of Land Surveyors or by a Decree of a Court of Law; established, re-established, monumented, recovered, found as expressed below:

	A	B	C	D	E	F	G	H	I	J	K	L	M
1													
2	6		5		4		3		2		1		
3													
4	7		8		9		10		11		12		
5													
6	18		17		16		15		14		13		
7													
8	19		20		21		22		23		24		
9													
10	30		29		28		27		26		25		
11													
12	31		32		33		34		35		36		
13													

NOTE: Not more than 2 corners, all in the same town and range, may be recorded on this certificate.

A. Description of original monument and accessories and/or subsequent restoration:

G.L.O.	L-1 P-385 1972	L-1 P-763 1972
Lucius Lyon	M-8 Found PK nail	M-8 Nail in bit. concrete at corner
Set H.M.P.	Nail in Face of P.P. NW 66.49'	St. Sign Post NW 49.86'
5" Birch N 80°W 19 links	Nail in Face of P.P. SE 50.94'	Nail in P. Pole NW 66.50'
	Nail in Face of 8" Maple SW 78.88'	Nail in P. Pole SE 50.92'
	St. Sign NW 50.56'	W 1/4 cor. sec. 19-6-14 N 75.83'
	Blendon Corner North 75.9'	

B. Description of corner evidence found and/or method applied in restoring or reestablishing corner:

M-8 Found: Broken Cast Iron Monument in Monument Box	
Found: SW brick house corner	138°0' 83.29'
Nail and Tag NW side 24" Maple	239°05' 90.06'
Cast Iron Monument in Monument Box (Blendon Corner)	N 75.90'

Accepted as a careful and faithful perpetuation of the position of the original corner

C. Description of monument for corner and accessories established to perpetuate locating the position of the corner:

M-8 Found: Broken Cast Iron Monument in Monument Box	
"X" cut in N end top of 36" concrete culvert	12°30' 106.44'
SW corner brick house	138°00' 83.29'
Set Ottawa County Nail & Tag NW side 24" Maple	239°05' 90.06'
SE corner house foundation	322°55' 154.51'
Centerline N-S bit. road (96th Ave.)	2.3°W
Centerline gravel road to W (Blair St.)	4°N
Cast Iron Monument in Monument Box (Blendon Corner)	N75.90'

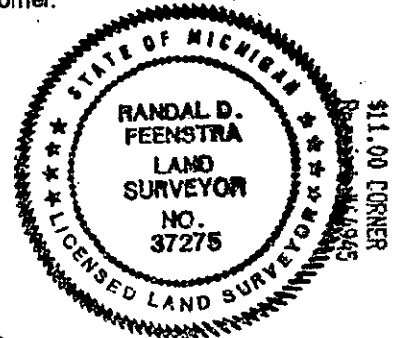

Signed by Randal D. Feenstra
Surveyor's Michigan License No. 37275

Date November 12, 1999

FEB 24 2000

SECTION

L-6 P-167 1991

M-8 Found 3/4" rod in Monument Box
P.P. SE 51.00'
P.P. NW 66.50'
12" Maple WSW 79.36'
8" Maple SW 78.88'

M-8 Set Cast Iron Monument
N to Blendon Corner 75.92'
P.P. NW 66.48'
16" Maple SW 89.81'
SE to SW brick house corner 73.16'