

FEB 24 2000

OTTAWA COUNTY REMONUMENTATION

RECORDED

LAND CORNER RECORDATION CERTIFICATE
Filing Requirement of Act 74, Mich. P.A. 1970

99 SEP -9 PM 12: 15

SECTION

For corners in
Ottawa

Located in:	Corner Code #
Olive Twp.	M-12 W 1/4 Cor. E. 1/4 Cor.
6N 15W	Sec. 36
T ___ R ___	_____
T ___ R ___	_____
T ___ R ___	_____
T ___ R ___	_____
S ___ T ___ R ___	_____
S ___ T ___ R ___	_____
S ___ T ___ R ___	_____
S ___ T ___ R ___	_____

Dany Scholtz
REGISTER OF DEEDS
OTTAWA COUNTY, MI

Register of Deeds Stamp & File Number

- 1. Public Land Survey
- 2. Property Controlling in Section
- 3. Miscellaneous Property in Sec.

4. Lot No. _____, Recorded Plat _____
5. Private Claims _____

I, Randal D. Feenstra, in a field survey on Feb. 11, 1999 do hereby state that under requirements of P.A. 74, Michigan P.A. of 1970, the corner points mentioned in lines 1 and 2 above were in conformance with regulations and rules therefore as required in the current manual of survey instructions of the United States Department of the Interior, Bureau of Land Management or by a decree of a Court of Law and/or that the corner points mentioned in lines 3, 4 and 5 above were in conformance with the rules of the Michigan Board of Land Surveyors or by a Decree of a Court of Law; established, re-established, monumented, recovered, found as expressed below:

NOTE: Not more than 2 corners, all in the same town and range, may be recorded on this certificate.

A	B	C	D	E	F	G	H	I	J	K	L	M
1												
2	6	5	4	3	2	1						
3												
4	7	8	9	10	11	12						
5												
6	18	17	16	15	14	13						
7												
8	19	20	21	22	23	24						
9												
10	30	29	28	27	26	25						
11												
12	31	32	33	34	35	36						
13												

A. Description of original monument and accessories and/or subsequent restoration:

G.L.O. by Lucius Lyon	L-1, P-665, 1972 (Roon)	L-6, P-10, 1989 (Joiner)
Set H.M.P.	M-12 Set pipe 1/2 way not on line	M-12 Set Cast Iron Monument
4" Pine N25°W 12 links	Telephone Pole WNW 48.89'	Nail NW side Telephone Pole WSW 50.85
4" Pine S22°W 23 links	NW Cor. E. Hdwl. SE 27.01'	Nail NE side Telephone Pole WNW 49.10
	Power Pole WSW 50.42'	Centerline top of Hydrant NE 51.83'
	Centerline 96th Ave. E 0.45'	Nail SW side Power Pole SE 59.95'
		Square Head Iron N 8.58'
		W 1/4 Cor. Sec. 31-6-14 N 15.04'

B. Description of corner evidence found and/or method applied in restoring or reestablishing corner:

M-12 Found: Cast Iron Monument in monument box	AZ 244°35'	50.68'
Found: Nail and Tag SE Side of Power Pole	North	15.12'
Found: Cast Iron Monument in monument box (Blendon Cor.)		

Accepted as a careful and faithful perpetuation of the position or the original corner.

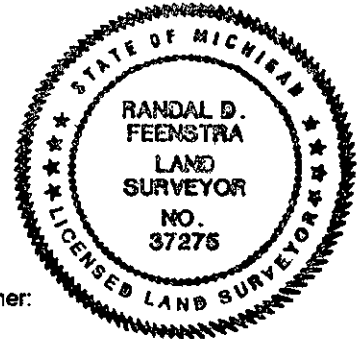

C. Description of monument for corner and accessories established to perpetuate locating the position of the corner:

M-12 Cast Iron Monument in monument box (See Sketch)		
Set Ottawa County Remon Nail & Tag in E side of Power Pole	AZ 23°30'	130.35'
Set Ottawa County Remon Nail & Tag in NE side of Power Pole	AZ 127°35'	64.27'
Set Ottawa County Remon Nail & Tag in SE side of Power Pole	AZ 244°35'	50.68'
Set Ottawa County Remon Nail & Tag in E side of Power Pole	AZ 347°40'	212.84'
CIM in monument box (Blendon Cor.) North		15.12'
Centerline N-S bituminous road (96th Ave.) East		0.7'
Centerline gravel road to West (Barry St.) North		3.0'

\$2.00 PHOTO
Receipt #56820

\$11.00 CORNER
Receipt #56820

Signed by *Randal D. Feenstra*
Surveyor's Michigan License No. 37275

Date May 14, 1999

FEB 24 2000

SECTION

