

FEB 24 2000

RECORDED

99 OCT 27 PM 1:50

Ottawa County Remonumentation  
LAND CORNER RECORDATION CERTIFICATE  
Filing Requirement of Act 74, Mich. P.A. 1970

*Harry H. Sibley*  
REGISTER OF DEEDS  
OF SEELY COUNTY, MI

SECTION

For corners in

Ottawa

(County)

Located In:

Corner Code #

1. Public Land Survey

T 7N R 13W

A-7

T R

NW. corner, Section 19

T R

Allendale Township

T R

2. Property Controlling in Section

S T R

S T R

3. Miscellaneous Property in Sec.

S T R

S T R

Register of Deeds Stamp & File Number

4. Lot No. \_\_\_\_\_, Recorded Plat \_\_\_\_\_  
5. Private Claims \_\_\_\_\_

I, Maurice J. Rosema, in a field survey on August 11, 19 99 do hereby state that under requirements of P.A. 74, Michigan P.A. of 1970, the corner points mentioned in lines 1 and 2 above were in conformance with regulations and rules therefore as required in the current manual of survey instructions of the United States Department of the Interior, Bureau of Land Management or by a decree of a Court of Law and /or that the corner points mentioned in lines 3, 4 and 5 above were in conformance with the rules of the Michigan Board of Land Surveyors or by a Decree of a Court of Law; established, re-established, monumented, recovered, found as expressed below:

NOTE: Not more than 2 corners, all in the same town and range, may be recorded on this certificate.

A	B	C	D	E	F	G	H	I	J	K	L	M
1												
2	6	5	4	3	2	1						
3												
4	7	8	9	10	11	12						
5												
6	18	17	16	15	14	13						
7												
8	19	20	21	22	23	24						
9												
10	30	29	28	27	26	25						
11												
12	31	32	33	34	35	36						
13												

A. Description of original monument and accessories and/or subsequent restoration:

- A-7
- GLO - 1832
- Lyon and Sibley D.S.
- Set post
- 10" Beech - N23°E
- 24 links
- 12" Beech - S37°E
- 53 links
- M-7, T7N, R14W - N 16 links

LCRC per Liber 4, Page 291.  
(Joiner - 1981)  
Set Cast Iron monument  
Fence Post - NW. 38.54'  
40" Maple - ENE. 25.91'  
Power pole - SSE. 83.50'  
SW house cor. - SE. 93.05'  
Allendale cor. - N 10.53'

B. Description of corner evidence found and/or method applied in restoring or reestablishing corner:

- A-7
- Found Cast iron monument in gravel road 0.3' below grade on township line
- Found Cast iron monument (M-7, T7N, R14W) - N. 10.53'
- Found nail and tag in NW. side Power pole - S20°E 83.57'
- SW. corner house fndn. - S62°E 93.10'

See sketch on back

I hereby accept this corner as a correct and accurate perpetuation of the position of the original corner.

C. Description of monument for corner and accessories established to perpetuate locating the position of the corner:

- A-7
- Cast iron monument
- Set nail and remonumentation tag in E. side of 12" Ash - S30°E 57.29'
- Found nail and remonumentation tag in N. side 36" Maple - N77°E 25.72'
- Found nail and remonumentation tag in S. side Railroad tie fence post - N70°W 38.61'
- Found nail and remonumentation tag in W. side Power pole - S20°E 83.82'
- NW. corner of house fndn. - S78°E 86.21'
- Cast iron monument (M-7, T7N, R14W) - N0°E 10.53'

9/13/99  
*YOT*

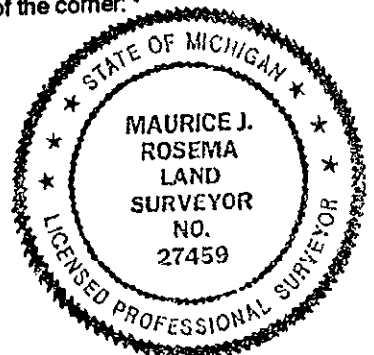

Receipt #61757

Signed by Maurice J. Rosema  
Surveyor's Michigan License No. 27459

Date September 11, 1999

FEB 24 2000

SECTION

T7N - R14W

T7N - R13W

