

FEB 24 2000

RECORDED

99 OCT 27 PM 1:50

Ottawa County Remonumentation
LAND CORNER RECORDATION CERTIFICATE
Filing Requirement of Act 74, Mich. P.A. 1970

SECTION

For corners in

Gregory J. Rosema
REGISTER OF DEEDS
OTTAWA COUNTY, MI

Ottawa (County)	Located In:	Corner Code #
1. Public Land Survey	T <u>7N</u> R <u>13W</u>	<u>A-8</u>
	T ___ R ___	<u>W. 1/4 corner, Sec. 19</u>
	T ___ R ___	<u>Allendale Township</u>
	T ___ R ___	_____
2. Property Controlling in Section	S ___ T ___ R ___	_____
	S ___ T ___ R ___	_____
3. Miscellaneous Property in Sec.	S ___ T ___ R ___	_____
	S ___ T ___ R ___	_____

Register of Deeds Stamp & File Number

4. Lot No. _____, Recorded Plat _____
5. Private Claims _____

I, Maurice J. Rosema, in a field survey on Sept. 11, 1999 do hereby state that under requirements of P.A. 74, Michigan P.A. of 1970, the corner points mentioned in lines 1 and 2 above were in conformance with regulations and rules therefore as required in the current manual of survey instructions of the United States Department of the Interior, Bureau of Land Management or by a decree of a Court of Law and /or that the corner points mentioned in lines 3, 4 and 5 above were in conformance with the rules of the Michigan Board of Land Surveyors or by a Decree of a Court of Law; established, re-established, monumented, recovered, found as expressed below:

NOTE: Not more than 2 corners, all in the same town and range, may be recorded on this certificate.

	A	B	C	D	E	F	G	H	I	J	K	L	M
1													
2	6		5		4		3		2		1		
3													
4	7		8		9		10		11		12		
5													
6	16		17		16		15		14		13		
7													
8	19		20		21		22		23		24		
9													
10	30		29		28		27		26		25		
11													
12	31		32		33		34		35		36		
13													

A. Description of original monument and accessories and/or subsequent restoration:
A-8
Not set by GLO
LCRC per Liber 2, Page 595 (Schumaker - 1974)
Mon. box over pointed stone
MBT pole - S25°E 52.13'
Traf. sign - N85°W 20.56'
St. sign - N45°E 35.44'
Rod in mon. box - N. 46.85'

LCRC per Liber 4, Page 199 (Joiner - 1981)
Set Cast iron mon.
Nail in wood post at T. ped. - NE. 43.99'
Nail in wood post at T. ped. - WNW. 62'
Street sign - NE. 35.51'
Allendale cor. - N. 46.85'

B. Description of corner evidence found and/or method applied in restoring or reestablishing corner:
A-8
Found Mag. Nail at corner A-8 on twp. line, replaced with 3/4" x 2' steel rod with remon. cap and mon. box
Found Cast iron mon. in mon. box - W 2.75'
Found nail in concrete at manhole (M-8, T7N, R14W) - N. 46.84'

9/13/99
YD7

See sketch on back.

This corner was not established by the original government surveyors. This monument is accepted as the best available evidence as to the position of the corner.

C. Description of monument for corner and accessories established to perpetuate locating the position of the corner:
A-8
3/4" x 2' steel rod with remonumentation cap in mon. box
Set nail and remonumentation tag in NW. side light pole - N30°E 81.79'
Found nail in concrete (M-8, T7N, R14W) - N. 46.84'
Set nail and remonumentation tag in NE. side Power pole - N27°W 82.84'
Set nail and remonumentation tag in S. side wood post at Tele. box - N75°W 65.00'
Face of brick sign base - S48°E 65.35'
On centerline of N.-S. bit. conc. road
Cast iron mon. in mon. box - W. 2.75'

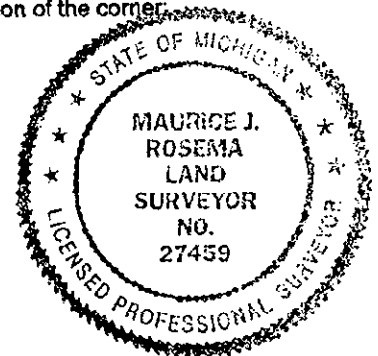

\$11.00 CORNER
Receipt #61757

Signed by *Maurice J. Rosema*
Surveyor's Michigan License No. 27459

Date September 11, 1999

FEB 24 2000

SECTION

T7N - R14W

T7N - R13W

