

FEB 24 2000

Ottawa County Remonumentation  
LAND CORNER RECORDATION CERTIFICATE  
Filing Requirement of Act 74, Mich. P.A. 1970

RECORDED  
99 OCT 27 PM 1:50

For corners in SECTION

*Gay Gilbert*  
REGISTER OF DEEDS  
OTTAWA COUNTY, MI

Ottawa (County)	Located In:	Corner Code #
1. Public Land Survey	T <u>7N</u> R <u>13W</u>	<u>B-3</u>
	T ___ R ___	<u>N¼ corner of Section 7</u>
	T ___ R ___	<u>Tallmadge Township</u>
	T ___ R ___	_____
2. Property Controlling in Section	S ___ T ___ R ___	_____
	S ___ T ___ R ___	_____
3. Miscellaneous Property in Sec.	S ___ T ___ R ___	_____
	S ___ T ___ R ___	_____

Register of Deeds Stamp & File Number

4. Lot No. \_\_\_\_\_, Recorded Plat \_\_\_\_\_  
5. Private Claims \_\_\_\_\_

I, Maurice J. Rosema, in a field survey on July 28, 1999 do hereby state that under requirements of P.A. 74, Michigan P.A. of 1970, the corner points mentioned in lines 1 and 2 above were in conformance with regulations and rules therefore as required in the current manual of survey instructions of the United States Department of the Interior, Bureau of Land Management or by a decree of a Court of Law and /or that the corner points mentioned in lines 3, 4 and 5 above were in conformance with the rules of the Michigan Board of Land Surveyors or by a Decree of a Court of Law; established, re-established, monumented, recovered, found as expressed below:

1	A	B	C	D	E	F	G	H	I	J	K	L	M
2		6		5		4		3		2		1	
3		●											
4		7		8		9		10		11		12	
5													
6		18		17		16		15		14		13	
7													
8		19		20		21		22		23		24	
9													
10		30		29		28		27		26		25	
11													
12		31		32		33		34		35		36	
13													

NOTE: Not more than 2 corners, all in the same town and range, may be recorded on this certificate.

A. Description of original monument and accessories and/or subsequent restoration:

B-3	LCRC per Liber 2, Page 121 (Englert - 1973)	LCRC per Liber 2, Page 523 (Clapp - 1974)	LCRC per Liber 3, Page 353 (Campbell - 1979)
GLO - 1838 Whitcomb D.S.	1" pipe	Cast iron monument	Cast iron monument
6" Beech - S27°W 10 links	12" Hickory - SE. 34.9'	12" Oak - SE. 34.30'	12" Hickory - SE. 34.90'
10" Pine - N30½°E 25 links	16" Hickory - SSE. 37.08'	10" Oak - NE. 61.48'	16" Hickory - SSE. 37.08'
(over)	20" Oak - NE. 61.65'	12" tw. Oak - NW. 32.50	20" Oak - NE. 61.65'

B. Description of corner evidence found and/or method applied in restoring or reestablishing corner:

B-3  
Found Cast iron monument on centerline of E.-W. gravel road 0.3' below grade  
Capped T-iron on S. right of way line - S. 33.04'  
Cast iron monument - E. 2661.16'  
Cast iron monument in monument box - W. 2303.14'

8/16/99  
*YDT*

I hereby accept this corner as a correct and accurate perpetuation of the position of the original corner.

C. Description of monument for corner and accessories established to perpetuate locating the position of the corner:

B-3  
Cast iron monument  
Set nail and remonumentation tag in SW. side 22" tw. Ash - N30°W 33.30'  
Set nail and remonumentation tag in W. side 13" tw. Ash - S2°E 27.76'  
Set nail and remonumentation tag in E. side 8" tw. Ash - S50°W 37.21'  
Set nail and remonumentation tag in S. side 30" Maple - N70°E 62.62'

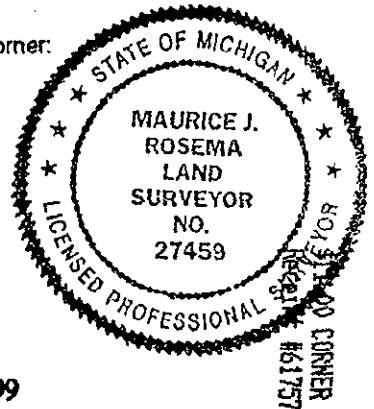

Signed by *Maurice J. Rosema*  
Surveyor's Michigan License No. 27459

Date August 16, 1999

Information from the files of Tru-Line Surveying P.C.

Cast iron monument

NE. corner of Section 7 (Cast iron mon.) - E. 2661.16'

NW. corner of Section 7 (Cast iron mon. in mon. box) - W. 2303.14'

FEB 24 2000

SECTION