

SURVEY & REMONUMENTATION

FEB 27 1998

Ottawa County Remonumentation
LAND CORNER RECORDATION CERTIFICATE
 Filing Requirement of Act 74, Mich. P.A. 1970

SECTION

For corners in

Ottawa (County)	Located In:	Corner Code #
1. Public Land Survey	7N 13W T___ R___ T___ R___ T___ R___ T___ R___	B-9 N 1/4 cor. Sec. 30
2. Property Controlling in Section	S___ T___ R___ S___ T___ R___	_____
3. Miscellaneous Property in Sec.	S___ T___ R___ S___ T___ R___	_____

4. Lot No. _____, Recorded Plat _____
 5. Private Claims _____

I, Maurice J. Rosema, in a field survey on Nov. 28, 1997 do hereby state that under requirements of P.A. 74, Michigan P.A. of 1970, the corner points mentioned in lines 1 and 2 above were in conformance with regulations and rules therefore as required in the current manual of survey instructions of the United States Department of the Interior, Bureau of Land Management or by a decree of a Court of Law and /or that the corner points mentioned in lines 3, 4 and 5 above were in conformance with the rules of the Michigan Board of Land Surveyors or by a Decree of a Court of Law; established, re-established, monumented, recovered, found as expressed below:

NOTE: Not more than 2 corners, all in the same town and range, may be recorded on this certificate.

	A	B	C	D	E	F	G	H	I	J	K	L	M
1													
2		6		5		4		3		2		1	
3													
4		7		8		9		10		11		12	
5													
6		10		17		16		15		14		13	
7													
8		19		20		21		22		23		24	
9		●											
10		30		29		28		27		26		25	
11													
12		31		32		33		34		35		36	
13													

RECORDED
 97 DEC -8 AM 11:29
Dan Schultz
 REGISTER OF DEEDS
 OTTAWA COUNTY, MI

Register of Deeds Stamp & File Number

A. Description of original monument and accessories and/or subsequent restoration:

B-9	From the files of Tru-Line Surveying P.C.
GLO - Britain - 1832 LCRC per L. 1, P. 671 (1972)	PK nail
post Large nail	St sign - SE 46.50'
24" Maple - N38°E 19 lks T pole - NW 71.28'	Nail in fc of P pole - NE 85.68'
36" Hemlock - S64°W P pole - NE 85.95'	PK nail in side wood post - SSW 50.85'
25 lks St sign - SE 46.42'	B-8 (CI mon.) - N 2681.27'
8" Maple - SE 66.88'	rod in mon. box - E 28.47'
T pole - SW 50.04'	

B. Description of corner evidence found and/or method applied in restoring or reestablishing corner:

B-9
 Found large nail 0.5' below bit. conc. road surface, replaced with 5/8" X 0.5' steel rod with OC remon. cap and mon. box
 Found nail in fc of leaning P pole - NE 86.10'
 Found bent iron rod in mon. box - E 28.60'
 Found PK nail in E side wood post - SSW 51.07'
 Found CI mon. at B-8 - N 2681.32'

I hereby accept this corner as a correct and accurate perpetuation of the position of the original corner.

P.A. 345 OTTAWA COUNTY
 PEER APPROVED 12-1-97

[Signature]

C. Description of monument for corner and accessories established to perpetuate locating the position of the corner:

B-9
 5/8" x 0.5' steel rod with OC remon. cap in mon. box
 Set nail and remon. tag in W side of P pole - N40°E 86.41'
 Set nail and remon. tag in NW side P pole - S38°W 54.65'
 Set nail and remon. tag in NE side RR tie fc post - S26°W 65.30'
 Set brass rivet and remon. tag in top of conc. box culvert - N52°E 56.85'
 Set brass rivet and remon. tag in top of conc. box culvert - S46°E 55.49'
 On centerline of N-S gravel road
 Centerline of E-W bit. conc. road - S 2'

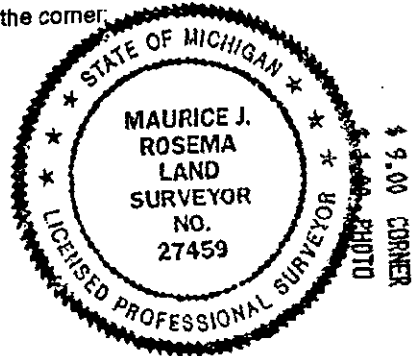

Signed by *[Signature]*
 Surveyor's Michigan License No. 27459

Date Dec. 1, 1997