

FEB 24 2000

RECORDED

Ottawa County Remonumentation
LAND CORNER RECORDATION CERTIFICATE
Filing Requirement of Act 74, Mich. P.A. 1970

99 OCT 27 PM 1:49

SECTION

For corners in

Ottawa

(County)

Located In:

Corner Code #

1. Public Land Survey

T 7NR 13W

C-2

T R

W 1/4 corner, Section 5

T R

Tallmadge Township

T R

2. Property Controlling in Section

S T R

S T R

3. Miscellaneous Property in Sec.

S T R

S T R

Gary Hill
REGISTER OF DEEDS
OTTAWA COUNTY MI

Register of Deeds Stamp & File Number

4. Lot No. _____, Recorded Plat _____
5. Private Claims _____

I, Maurice J. Rosema, in a field survey on July 28, 19 99 do hereby state that under requirements of P.A. 74, Michigan P.A. of 1970, the corner points mentioned in lines 1 and 2 above were in conformance with regulations and rules therefore as required in the current manual of survey instructions of the United States Department of the Interior, Bureau of Land Management or by a decree of a Court of Law and for that the corner points mentioned in lines 3, 4 and 5 above were in conformance with the rules of the Michigan Board of Land Surveyors or by a Decree of a Court of Law; established, re-established, monumented, recovered, found as expressed below:

NOTE: Not more than 2 corners, all in the same town and range, may be recorded on this certificate.

A. Description of original monument and accessories and/or subsequent restoration:

C-2
GLO - 1838 LCRC per Liber 4, Page 269
R. Whitcomb D.S. (Joiner - 1981)
Set post Cast iron monument
18" Beech - S88°W 14" Locust - NE. 25.87'
13 links Maple - SW. 57.51'
10" Beech - N68°E Power pole - E. 44.31'
34 links Power pole - WNW. 38.28'

LCRC per Liber 5, Page 206
(Rosema - 1985)
Cast iron monument
Nail in NW. side 12" Willow - NE. 25.87'
Nail in S. side 40" Maple - W. 27.55'
Nail in SE. side 40" Maple - SW. 57.47'
On centerline of N-S gravel road
On fence line to East

B. Description of corner evidence found and/or method applied in restoring or reestablishing corner:

C-2
Found Cast iron monument on centerline of N.-S. gravel road 0.8' below grade
Found nail and tag in NW. side 15" Willow - N44°E 25.85'
Found nail and tag in NE. side Power pole - N66°W 38.22'

I hereby accept this corner as a correct and accurate perpetuation of the position of the original corner.

C. Description of monument for corner and accessories established to perpetuate locating the position of the corner:

C-2
Cast iron monument
Set nail and remonumentation tag in S. side of 45" Maple - S90°W 27.67'
Set nail and remonumentation tag in NW. side 45" Maple - S34°W 56.30'
Set nail and remonumentation tag in S. side 7" Ash - S38°E 31.20'
Set nail and remonumentation tag in NW. side 15" Willow - N44°E 25.85'
Set nail and remonumentation tag in NE. side Power pole - N66°W 38.22'
On fence line to East

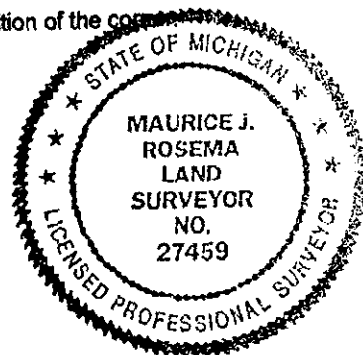

Signed by *Maurice J. Rosema*
Surveyor's Michigan License No. 27459

Date August 30, 1999

Receipt #61757