

SURVEY & REMONUMENTATION

FEB 27 1998

Ottawa County Remonumentation
LAND CORNER RECORDATION CERTIFICATE
 Filing Requirement of Act 74, Mich. P.A. 1970

SECTION

For corners in

Ottawa (County)	Located In:	Corner Code #
1. Public Land Survey	T <u>7N</u> R <u>13W</u>	E-1
	T <u>NE cor. Sec. 5</u>	
	T <u>Tallmadge Township</u>	
	T <u>_____</u>	
	T <u>_____</u>	
2. Property Controlling in Section	S <u>_____</u> T <u>_____</u> R <u>_____</u>	
	S <u>_____</u> T <u>_____</u> R <u>_____</u>	
3. Miscellaneous Property in Sec.	S <u>_____</u> T <u>_____</u> R <u>_____</u>	
	S <u>_____</u> T <u>_____</u> R <u>_____</u>	

RECORDED

97 DEC -8 AM 11:32

Mary Schell
 REGISTER OF DEEDS
 OTTAWA COUNTY, MI

Register of Deeds Stamp & File Number

4. Lot No. _____, Recorded Plat _____
 5. Private Claims _____

Maurice J. Rosema Mar. 12 97
 I, _____, in a field survey on _____, 19____ do hereby state that under requirements of P.A. 74, Michigan P.A. of 1970, the corner points mentioned in lines 1 and 2 above were in conformance with regulations and rules therefore as required in the current manual of survey instructions of the United States Department of the Interior, Bureau of Land Management or by a decree of a Court of Law and /or that the corner points mentioned in lines 3, 4 and 5 above were in conformance with the rules of the Michigan Board of Land Surveyors or by a Decree of a Court of Law; established, re-established, monumented, recovered, found as expressed below:

NOTE: Not more than 2 corners, all in the same town and range, may be recorded on this certificate.

	A	B	C	D	E	F	G	H	I	J	K	L	M
1													
2	6		5		4		3		2		1		
3													
4	7		8		9		10		11		12		
5													
6	18		17		16		15		14		13		
7													
8	19		20		21		22		23		24		
9													
10	30		29		28		27		26		25		
11													
12	31		32		33		34		35		36		
13													

A. Description of original monument and accessories and/or subsequent restoration:

E-1	GLO - Whitcomb D.S. (1838)	LCRC per L. 6, P. 25 (1989)	LCRC per L. 4, P. 351 (1982)	LCRC per L. 6, P. 92 (1990)
	post	CI mon.	CI mon.	CI mon.
	15" Ash - S65°E 43 lks.	SW cor. Sec. 33-8-13 - E 159.45'	T pole - SE 40.50'	T pole - SE 40.70'
	20" Beech - S39°W 46 lks.	PK in NE side T pole - SE 40.82'	12" Pine - NNE 49.28'	12" Pine - NE 83.78'
	E-13, T8N, R13W - E 2.60 ch.	24" poplar - NNW 44.62'	Street sign - SE 85.85'	14" Pine - NNE 49.50'
		P pole - NE 36.41'	Wright twp. cor. - E 159.42'	T pole -
		24" Oak - SW 79.72'		WSW 134.53'
		16" Poplar - NW 49.19'		

B. Description of corner evidence found and/or method applied in restoring or reestablishing corner:

E-1
 Found CI mon. 4.15' N of the township line, set a 5/8" x 2' steel rod with OC remon. cap in mon. box on township line between E-13 and E-13 (T8N, R13W)
 The following wit. are to the CI mon.
 Found PK nail in SE side 18" Pine - NE 83.80'
 Found PK nail in E side 15" Pine - NNE 49.49'
 Found nail in NE side P pole - SSE 40.66'
 Found CI mon. in mon. box - E 159.30'

P.A. 345 OTTAWA COUNTY
 PEER APPROVED 12-1-97
[Signature]

I hereby accept this corner as a correct and accurate perpetuation of the position of the original corner.

C. Description of monument for corner and accessories established to perpetuate locating the position of the corner:

E-1
 5/8" x 3' steel rod with OC remon. cap in mon. box
 Set nail and remon. tag in E side 15" Pine - N16°E 53.53'
 Set nail and remon. tag in NE side P pole - S47°E 37.70'
 Set nail and remon. tag in SE side 15" Pine - S58°E 86.02'
 Set nail and remon. tag in E side 12" Pine - N8°W 56.59'
 CI mon. - N 4.15'
 CI mon. in mon. box (E-13, T8N, R13W) - E 159.30'
 On centerline of E-W bit. conc. road
 Centerline of gravel road to S - W 3'

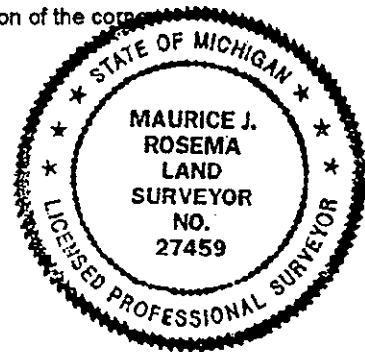

\$ 2.00 PHOTO
 \$ 11.00 CORNER

Signed by *[Signature]*
 Surveyor's Michigan License No. 27459

Date Dec. 1, 1997

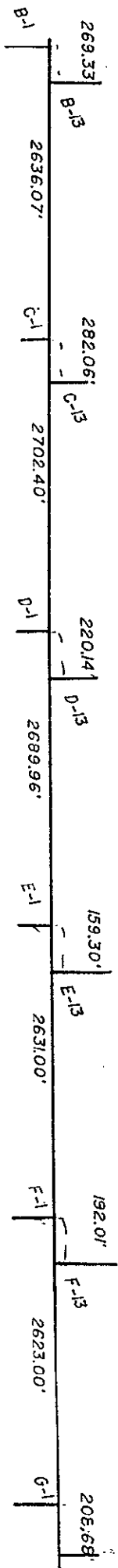
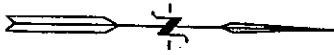

T8N, R13W

T7N, R13W

SURVEY &
REMONUMENTATION

FEB 27 1998

SECTION

