

RECORDED

99 OCT 27 PM 1:49

FEB 24 2000

Ottawa County Remonumentation  
LAND CORNER RECORDATION CERTIFICATE  
Filing Requirement of Act 74, Mich. P.A. 1970

*Dany Sublette*  
REGISTER OF DEEDS  
OTTAWA COUNTY, MI

For corners in SECTION

Ottawa (County)	Located In:	Corner Code #
1. Public Land Survey	T7N R13W	E-3
	T R	NW, corner of Section 9
	T R	Tallmadge Township
	T R	
2. Property Controlling in Section	S T R	
	S T R	
3. Miscellaneous Property in Sec.	S T R	
	S T R	

Register of Deeds Stamp & File Number

4. Lot No. \_\_\_\_\_, Recorded Plat \_\_\_\_\_  
5. Private Claims \_\_\_\_\_

I, Maurice J. Rosema, in a field survey on July 27, 1999 do hereby state that under requirements of P.A. 74, Michigan P.A. of 1970, the corner points mentioned in lines 1 and 2 above were in conformance with regulations and rules therefore as required in the current manual of survey instructions of the United States Department of the Interior, Bureau of Land Management or by a decree of a Court of Law and /or that the corner points mentioned in lines 3, 4 and 5 above were in conformance with the rules of the Michigan Board of Land Surveyors or by a Decree of a Court of Law, established, re-established, monumented, recovered, found as expressed below:

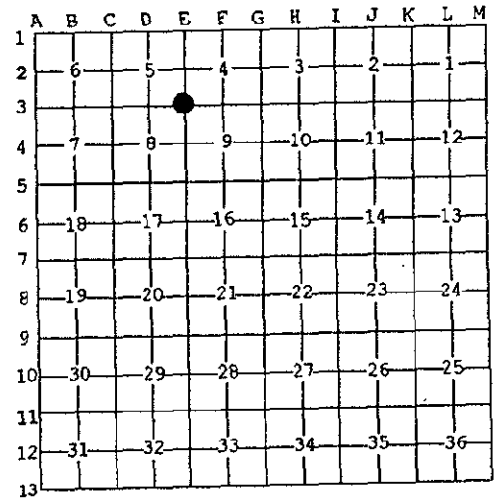

NOTE: Not more than 2 corners, all in the same town and range, may be recorded on this certificate.

A. Description of original monument and accessories and/or subsequent restoration:

E-3  
 GLO - 1838 LCRC per Liber 5, Page 344  
 R. Whitcomb D.S. (Joiner - 1988)  
 Set post Set C.I.M.  
 12" Beech - S53½°E PP - SW 43.64'  
 42 links 10" Elm - SE. 37.25'  
 14" Beech - N52°W TP - NE. 54.26'  
 10 links 12" Elm - NW. 101.04'

MAURICE J. ROSEMA

9/13/99  
*MJR*

B. Description of corner evidence found and/or method applied in restoring or reestablishing corner:

E-3  
 Found Cast iron monument on centerline of E.-W.-N. gravel roads 0.4' below grade  
 Found nail in NW. side Power pole - N67°E 54.50'  
 Found nail in SE. side Power pole - S32°W 43.45'

I hereby accept this corner as a correct and accurate perpetuation of the position of the original corner.

C. Description of monument for corner and accessories established to perpetuate locating the position of the corner:

E-3  
 Cast iron monument  
 Set nail and remonumentation tag in E. side mailbox post - S70°W 34.60'  
 Set nail and remonumentation tag in NW. side Power pole - N67°E 54.45'  
 Set nail and remonumentation tag in SE. side Power pole - 43.40'  
 Set nail and remonumentation tag in E. side 5" Maple - N28°W 103.00'  
 Set nail and remonumentation tag in SW. side 9" Apple - S59°E 50.00'

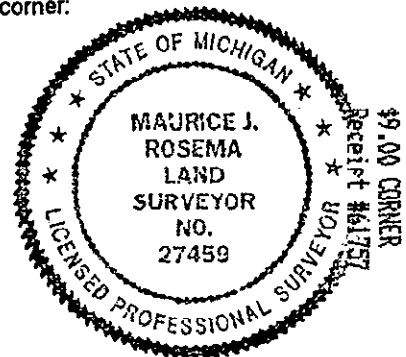

Signed by *Maurice J. Rosema*  
Surveyor's Michigan License No. 27459

Date August 30, 1999