

SURVEY & REMONUMENTATION

FEB 27 1998

Ottawa County Remonumentation

SECTION

LAND CORNER RECORDATION CERTIFICATE
Filing Requirement of Act 74, Mich. P.A. 1970

For corners in

Ottawa <small>(County)</small>	Located In:	Corner Code #
1. Public Land Survey	7N 13W	F-1 N 1/4 cor. Sec. 4
	T ___ R ___	_____
	T ___ R ___	_____
	T ___ R ___	_____
	T ___ R ___	_____
2. Property Controlling in Section	S ___ T ___ R ___	_____
	S ___ T ___ R ___	_____
3. Miscellaneous Property in Sec.	S ___ T ___ R ___	_____
	S ___ T ___ R ___	_____

RECORDED

97 DEC -8 AM 11:32

Maurice J. Rosema
REGISTER OF DEEDS
OTTAWA COUNTY, MI

Register of Deeds Stamp & File Number

4. Lot No. _____, Recorded Plat _____
5. Private Claims _____

Maurice J. Rosema Mar. 12 97
I, _____, in a field survey on _____, 19____ do hereby state that under requirements of P.A. 74, Michigan P.A. of 1970, the corner points mentioned in lines 1 and 2 above are in conformance with regulations and rules therefore as required in the current manual of survey instructions of the United States Department of the Interior, Bureau of Land Management or by a decree of a Court of Law and/or that the corner points mentioned in lines 3, 4 and 5 above were in conformance with the rules of the Michigan Board of Land Surveyors or by a Decree of a Court of Law; established, re-established, monumented, recovered, found as expressed below:

NOTE: Not more than 2 corners, all in the same town and range, may be recorded on this certificate.

	A	B	C	D	E	F	G	H	I	J	K	L	M
1													
2	6		5		4		3		2		1		
3													
4	7		8		9		10		11		12		
5													
6	18		17		16		15		14		13		
7													
8	19		20		21		22		23		24		
9													
10	30		29		28		27		26		25		
11													
12	31		32		33		34		35		36		
13													

A. Description of original monument and accessories and/or subsequent restoration:

F-1 GLO did not set this corner	LCRC per L 3, P 85 (1976) 2" iron Pear tree - NW 88.11' SE hse. cor. - NW 89.17' Wright twp cor. - E 192.69'	LCRC per L 6, P 25 (1989) CI mon. S 1/4 cor., Sec. 33-8-13 - E 192.09' SE hse. cor. - E 192.09' P pole - SSE 176.99' PK in SW side 12" Pear - NW 89.00' PK in W side fc post - NE 55.06'	LCRC per L 6, P 90 (1990) CI mon. P pole - NE 36.36' 20" tw Poplar - NW 49.23' 28" Oak - SW 79.72' 11" Pine - SSE 58.88'
------------------------------------	--	---	---

B. Description of corner evidence found and/or method applied in restoring or reestablishing corner:

Found CI monument 1.62' N of township line, set 5/8" x 2' steel rod and mon. box on twp line between E-13 and F-13 (T8N, R13W)
The following wit. are to the CI mon.
SE cor. hse. fnd. - NNW 89.14'
CI mon. in mon. box - E 192.01'

I hereby accept this corner as a correct and accurate position of the section corner.

P.A. 345 OTTAWA COUNTY
PEER APPROVED 12-1-97

Maurice J. Rosema

C. Description of monument for corner and accessories established to perpetuate locating the position of the corner:

F-1
5/8" x 2' steel rod in mon. box on twp. line (with OC Remon. cap)
Set nail and remon. tag in W side of P pole - N7° E 75.50'
Set nail and remon. tag in S side wood fc post - N68° E 83.71'
Set nail and remon. tag in W side wood fc post - N46° E 47.53'
SW cor. porch foundation (at ground level) - N41° W 91.89'
SE cor. hse. foundation - N4° W 90.76'
On centerline of E-W bit. conc. road
CI Mon. in mon. box - E 192.01'
CI Mon. - N 1.62'

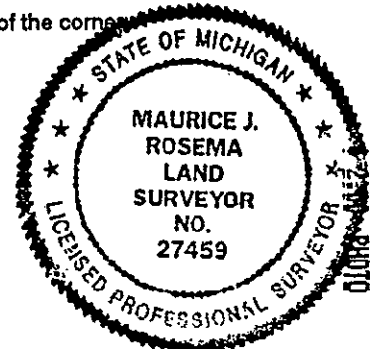

Signed by *Maurice J. Rosema*
Surveyor's Michigan License No. 27459

Date Dec. 1, 1997

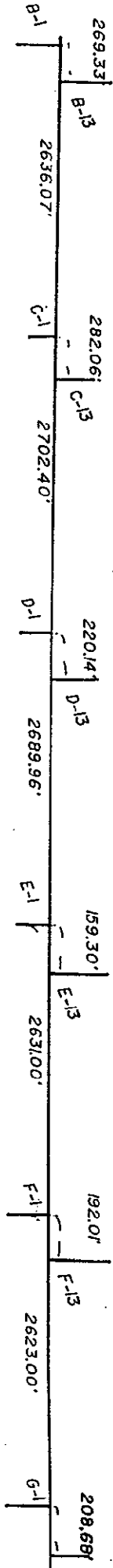
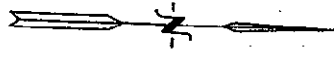

T8N, R13W

T7N, R13W

SURVEY &
REMONUMENTATION
FEB 27 1998
SECTION