

FEB 24 2000

RECORDED

99 OCT 27 PM 1:49

SECTION

Ottawa County Remonumentation
LAND CORNER RECORDATION CERTIFICATE
Filing Requirement of Act 74, Mich. P.A. 1970

For corners in

Ottawa

(County)

Located In:

Corner Code #

- 1. Public Land Survey T 7N R 13W G-9
T R NW. cor. Section 27
T R Tallmadge Township
T R
- 2. Property Controlling S T R
in Section S T R
- 3. Miscellaneous S T R
Property in Sec. S T R

Greg Schell
REGISTER OF DEEDS
OTTAWA COUNTY, MI

Register of Deeds Stamp & File Number

- 4. Lot No. _____, Recorded Plat _____
- 5. Private Claims _____

I, Maurice J. Rosema, in a field survey on Sept. 9, 1999 do hereby state that under requirements of P.A. 74, Michigan P.A. of 1970, the corner points mentioned in lines 1 and 2 above were in conformance with regulations and rules therefore as required in the current manual of survey instructions of the United States Department of the Interior, Bureau of Land Management or by a decree of a Court of Law and/or that the corner points mentioned in lines 3, 4 and 5 above were in conformance with the rules of the Michigan Board of Land Surveyors or by a Decree of a Court of Law; established, re-established, monumented, recovered, found as expressed below:

NOTE: Not more than 2 corners, all in the same town and range, may be recorded on this certificate.

A	B	C	D	E	F	G	H	I	J	K	L	M
1												
2	6	5	4	3	2	1						
3												
4	7	8	9	10	11	12						
5												
6	10	17	16	15	14	13						
7												
8	19	20	21	22	23	24						
9												
10	30	29	28	27	26	25						
11												
12	31	32	33	34	35	36						
13												

A. Description of original monument and accessories and/or subsequent restoration:

- G-9
GLO - 1838 LCRC per Liber 2, Page 615 LCRC per Liber 5, Page 331 LCRC per Liber 5, Page 233
R. Whitcomb D.S. (Hooth - 1974) (Joiner - 1988) (Rosema - 1985)
Set post Iron in mon. box Set C.I.M. Capped 1/2" iron in mon. box
6" Sugar - S46°E Guy pole - S60°E 65.67' P. pole - WSW 99.98' Nail in NW. side 15" Ash - NNE. 77.95'
7 links 6" Elm - S05°E 100.58' 10" Elm - E. 33.33' PK nail in S. side P. pole - NW. 82.29'
12" Lym. - N22°W P.P. - S40°W 71.88' 8" tw. Elm - NW. 76.62' Nail and MSHD tag
28 links T.P. - N45°E 68.88' (apparently recorded in SE. side P. pole - SW. 71.93'
incorrectly) Nail in SE. side 6" Ash - NE. 84.66'

B. Description of corner evidence found and/or method applied in restoring or reestablishing corner:

- G-9
Found 1/2" copper rod with copper cap in monument box, replaced copper rod with 3/4" x 3' steel rod with remonumentation cap
Found PK nail in S. side "old" Power pole - NW. 82.15'
On tree row to South

I hereby accept this corner as a correct and accurate perpetuation of the position of the original corner.

C. Description of monument for corner and accessories established to perpetuate locating the position of the corner:

- G-9
3/4" x 3' steel rod with remonumentation cap in monument box
Set nail and remonumentation tag in SE. side 15" Elm - N52°E 86.08'
Set nail and remonumentation tag in W. guy pole - N20°E 101.70'
Set nail and remonumentation tag in S. side "new" Power pole - N55°W 84.57'
Set nail and remonumentation tag in E. side 15" Oak - S0°E 105.00'
Centerline of E.-W. bit. conc. road - S. 2'
Centerline of gravel road to North - E. 7'

Signed by *Maurice J. Rosema*
Surveyor's Michigan License No. 27459

Date September 11, 1999

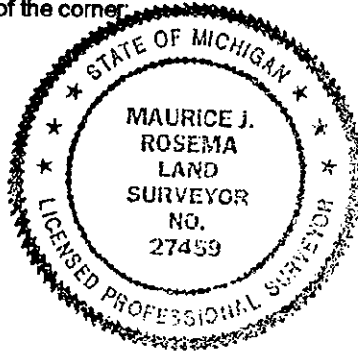

49.00 CORNER
Receipt #61757