

Ottawa County Remonumentation  
**LAND CORNER RECORDATION CERTIFICATE**  
 Filing Requirement of Act 74, Mich. P.A. 1970

RECORDED

96 DEC 18 PM 4:56

For corners in

Ottawa (County)	Located In:	Corner Code #
	7N 13W	I-11
1. Public Land Survey	T _____ R _____	(SW cor. _____)
	T _____ R _____	(Sec. 26) _____
	T _____ R _____	_____
	T _____ R _____	_____
2. Property Controlling in Section	S _____ T _____ R _____	_____
	S _____ T _____ R _____	_____
3. Miscellaneous Property in Sec.	S _____ T _____ R _____	_____
	S _____ T _____ R _____	_____

*D. J. ...*  
 REGISTER OF DEEDS  
 OTTAWA COUNTY, MI

Register of Deeds Stamp & File Number

4. Lot No. \_\_\_\_\_, Recorded Plat \_\_\_\_\_  
 5. Private Claims \_\_\_\_\_

	A	B	C	D	E	F	G	H	I	J	K	L	A
2	6		5		4		3		2		1		
3													
4	7		8		9		10		11		12		
5													
6	18		17		16		15		14		13		
7													
8	19		20		21		22		23		24		
9													
10	30		29		28		27		26		25		
11													
12	31		32		33		34		35		36		
13													

Maurice J. Rosema Nov. 29 96  
 I, \_\_\_\_\_, in a field survey on \_\_\_\_\_, 19 \_\_\_\_\_

do hereby certify that under requirements of P.A. 74, Michigan P.A. of 1970, the corner points mentioned in lines 1 and 2 above were in conformance with regulations and rules therefore as required in the current manual of survey instructions of the United States Department of the Interior, Bureau of Land Management or by a decree of a Court of Law and/or that the corner points mentioned in lines 3, 4 and 5 above were in conformance with the rules of the Michigan Board of Land Surveyors or by a Decree of a Court of Law; established, re-established, monumented, re-monumented, recovered, found as expressed below:

**NOTE: Not more than 4 corners, all in the same town and range, may be recorded on this certificate.**

A. Description of original monument and accessories and/or subsequent restoration:

I-11	Information from the files of Tru-Line Surveying P.C. (1993)	Information from the files of Nederveld Associates (1992)
GLO 1838 by Whitcomb Post	11" Beech - N60°E 31 lks	1/2" iron pipe
20" Pine - N21°W 30 lks	Nail and tag in N side 15" Maple - S65°W 30.26'	Nail in SW side 15" Oak - S 8.44'
(OVER)	Nail and tag in N side 5" Beech - S80°W 20.93'	Nail in S side 10" Oak - E 11.02'
	On downed wire fence E-W	Nail in E side 10" Oak - N 23.59'

B. Description of corner evidence found and/or method applied in restoring or reestablishing corner:

I-11  
 Found 1/2" iron pipe, replaced with 5/8" x 3' steel rod with remon. cap  
 Found nail in W side 17" Oak - S10°W 8.45'  
 Found nail in SW side 12" Oak - S77°E 11.01'  
 Found nail in N side 7" Beech - S85°W 20.97'  
 Found nail in N side 15" Maple - S55°W 30.25'  
 Found nail in SE side 8" Oak - N10°E 23.55'

P.A. 345 OTTAWA COUNTY  
 PEER APPROVED 12-9-96

I hereby accept this corner as a correct and accurate perpetuation of the position of the original corner.

*M.J.R.*

C. Description of monument for corner and accessories established to perpetuate locating the position of the corner:

I-11  
 5/8" x 3' steel rod with remon. cap  
 Nail and remon. tag in W side 17" Oak - S10°W 8.45'  
 Nail and remon. tag in SE side 11" Oak - N35°E 15.13'  
 Nail and remon. tag in SW side 12" Oak - S77°E 11.01'  
 Nail and remon. tag in E side 7" Beech - S80°W 20.98'  
 Nail and remon. tag in N side 15" Maple - S55°W 30.27'  
 Nail and remon. tag in SE side 8" Oak - N10°E 23.55'  
 On downed barbed wire fence E-W  
 E edge of swamp - W 76'±

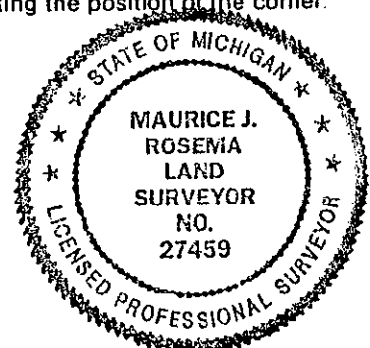

Signed by Maurice J. Rosema  
 Surveyor's Michigan License No. 27459

Date Dec. 9, 1996

Information from the files of All-Points Surveyors

$\frac{1}{2}$ " iron pipe

Nail in SW side 15" Oak - s'ly 8.44'

Nail in S side 10" Oak - E 11.02'

Nail in E side 10" Oak - N 23.59'

Information from the files of Williams and Works

15" Walnut - NW 8.00'

24" Pine SW 38.00'

8" tw Elm - E 21.10'

8" Hickory - W 18.00'

Information from the files of Consumers Power Co.

$\frac{1}{2}$ " iron