

SURVEY & MONUMENTATION

Ottawa County Remonumentation
APR 05 1996
LAND CORNER RECORDATION CERTIFICATE
COMMISSION Filing Requirement of Act 74, Mich. P.A. 1970

For corners in

| | | |
|------------------------------------------|----------------------------|---------------|
| <u>Ottawa</u> <small>(County)</small> | Located in: | Corner Code # |
| 1. Public Land Survey | T <u>T7N</u> R <u>R13W</u> | M-9 |
| | T _____ R _____ | (SE cor of |
| | T _____ R _____ | Section 24) |
| | T _____ R _____ | Tallmadge Twp |
| 2. Property Controlling in Section | S _____ T _____ R _____ | _____ |
| | S _____ T _____ R _____ | _____ |
| 3. Miscellaneous Property in Sec. | S _____ T _____ R _____ | _____ |
| | S _____ T _____ R _____ | _____ |

RECORDED

95 NOV 29 PM 1:44

Polycelia Robinson
 REGISTER OF DEEDS
 OTTAWA COUNTY, MI

Register of Deeds Stamp & File Number

4. Lot No. _____, Recorded Plat _____
 5. Private Claims _____

| A | B | C | D | E | F | G | H | I | J | K | L | M |
|----|----|----|----|----|----|----|---|---|---|---|---|---|
| 2 | 6 | 5 | 4 | 3 | 2 | 1 | | | | | | |
| 3 | | | | | | | | | | | | |
| 4 | 7 | 8 | 9 | 10 | 11 | 12 | | | | | | |
| 5 | | | | | | | | | | | | |
| 6 | 18 | 17 | 16 | 15 | 14 | 13 | | | | | | |
| 7 | | | | | | | | | | | | |
| 8 | 19 | 20 | 21 | 22 | 23 | 24 | | | | | | |
| 9 | | | | | | | | | | | | |
| 10 | 30 | 29 | 28 | 27 | 26 | 25 | | | | | | |
| 11 | | | | | | | | | | | | |
| 12 | 31 | 32 | 33 | 34 | 35 | 36 | | | | | | |
| 13 | | | | | | | | | | | | |

I, Maurice J. Rosema, in a field survey on March 3, 1995, do hereby certify that under requirements of P.A. 74, Michigan P.A. of 1970, the corner points mentioned in lines 1 and 2 above were in conformance with regulations and rules therefore as required in the current manual of survey instructions of the United States Department of the Interior, Bureau of Land Management or by a decree of a Court of Law and/or that the corner points mentioned in lines 3, 4 and 5 above were in conformance with the rules of the Michigan Board of Land Surveyors or by a Decree of a Court of Law; established, re-established, monumented, re-monumented, recovered, found as expressed below:

NOTE: Not more than 4 corners, all in the same town and range, may be recorded on this certificate.

A. Description of original monument and accessories and/or subsequent restoration:

- M-9
 GLO - 1837 (Noah Brookfield D.S.) L.C.R.C. recorded in Liber 2, L.C.R.C. recorded on
 18" Beech N24°W 25 lks page 763 - March 21, 1975 Nov. 2, 1984 (over)
 10" White Oak N19°W 82 lks (over)
- L.C.R.C. recorded in Liber 5, L.C.R.C. recorded as no. 2027 L.C.R.C. recorded as no.
 Page 173 - December 14, 1984 - August 27, 1981 5503 - Dec. 14, 1984
 (over) (over) (over)

B. Description of corner evidence found and/or method applied in restoring or reestablishing corner:

M-9
 Found C.I. monument in monument box NE 60.54'
 c/l top of hydrant

PA. 345 OTTAWA COUNTY
PEER APPROVED 11-20-95

Maurice J. Rosema *JDM*

I hereby accept this corner as a correct and accurate perpetuation of the position of the original corner.

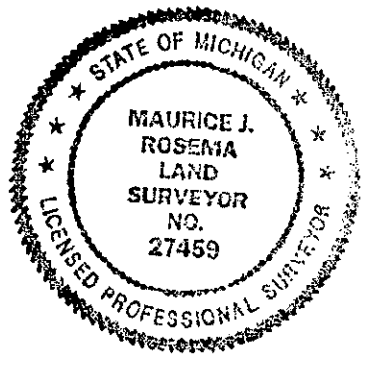

C. Description of monument for corner and accessories established to perpetuate locating the position of the corner:

- M-9
 C.I. monument in monument box
 Set nail and Ottawa County remon. tag in SE side P Pole N83°E 168.49'
 Found nail and Kent County remon. tag in wood post for sign post S60°W 88.94'
 Set nail and Ottawa County remon. tag in E side 8" Maple S12°W 91.11'
 c/l of top of hydrant N49°E 56.16'
 c/l of gas line pipe N9°W 56.16'
 c/l E-W bit. conc. road N 3'

Signed by *Maurice J. Rosema*
 Surveyor's Michigan License No. 27459

Date Oct. 19, 1995

M-9, T7N, R13W

L.C.R.C. recorded in Liber 2,
Page 763 - March 21, 1975
Iron in monument box
Top of gas vent
Top of gas vent and marker
MBT pole

S10°E 53.75'
N40°W 64.60'
N05°W 48.50'

L.C.R.C. recorded as no. 2027
- August 27, 1981
(recorded as A-9, T7N, R12W)

Kent County monument
KC nail and tag in W side MBT pole
KC nail and tag in W side of 10" Elm
c/l 3" steel post to 1000 gas line sign

N5°W 48.54'
N25°E 71.97'
N60°W 77.60'

L.C.R.C. recorded - November 02, 1984
Kent County monument

L.C.R.C. recorded in Liber 5,
Page 173 - December 14, 1984
C.I. monument

MBT
10" Elm
c/l steel gas line sign post
c/l pavement

N 48.54'
NNE 71.97'
WNW 77.60'
N 2'

L.C.R.C. recorded as no. 5503
- May 14, 1990 (recorded as A-9, T7N, R12W)

Kent County monument
c/l 3" steel post to 1000 gas line sign
top c/l of hydrant
Nail and remon tag in W side wood sign post
Nail and remon tag in W side tri 6" Maple
Top c/l of tele box
3' S of c/l E-W bit road
tree row to S

N60°W 77.60'
N60°E 60.70'
S60°W 90.03'
S20°W 63.80'
S10°E 44.90'

* 11.00 CORNER