

FEB 24 2000

RECORDED

99 OCT 27 PM 1:50

SECTION

Ottawa County Remonumentation
LAND CORNER RECORDATION CERTIFICATE
Filing Requirement of Act 74, Mich. P.A. 1970

For corners in

Ottawa

(County)

Located in:

Corner Code #

- 1. Public Land Survey T 7N R 14W A-6
 T R W. 1/4 corner of Section 18
 T R Allendale Township
 T R _____
- 2. Property Controlling S T R _____
 in Section S T R _____
- 3. Miscellaneous S T R _____
 Property in Sec. S T R _____

[Signature]
REGISTER OF DEEDS
OTTAWA COUNTY, MI

Register of Deeds Stamp & File Number

- 4. Lot No. _____, Recorded Plat _____
- 5. Private Claims _____

	A	B	C	D	E	F	G	H	I	J	K	L	M
1													
2	6		5		4		3		2		1		
3													
4	7		8		9		10		11		12		
5													
6	18		17		16		15		14		13		
7													
8	19		20		21		22		23		24		
9													
10	30		29		28		27		26		25		
11													
12	31		32		33		34		35		36		
13													

I, Maurice J. Rosema, in a field survey on July 28, 1999 do hereby state that under requirements of P.A. 74, Michigan P.A. of 1970, the corner points mentioned in lines 1 and 2 above were in conformance with regulations and rules therefore as required in the current manual of survey instructions of the United States Department of the Interior, Bureau of Land Management or by a decree of a Court of Law and /or that the corner points mentioned in lines 3, 4 and 5 above were in conformance with the rules of the Michigan Board of Land Surveyors or by a Decree of a Court of Law, established, re-established, monumented, recovered, found as expressed below:

NOTE: Not more than 2 corners, all in the same town and range, may be recorded on this certificate.

A. Description of original monument and accessories and/or subsequent restoration:

A-6
Not set by GLO LCRC per Liber 2, Page 826
 (Clapp - 1975)
 Cast iron monument
 Robinson Twp. corner - N 54.10'
 Power pole - NNE. 101.96'
 28" Oak - NNE. 20.88'
 16" Oak - W. 23.67'

Information from the files
of Tru-Line Surveying P.C.
Cast iron monument (A-5) - N. 2676.17'
Cast iron monument (A-7) - S. 2671.99'
Cast iron monument (M-6, T7N, R15W)
- N. 53.82'

B. Description of corner evidence found and/or method applied in restoring or reestablishing corner:

A-6
Found Cast iron monument 0.93' E. of township line, set 3/4" X 3' steel rod and remonumentation cap on township line
Cast iron mon. (A-5) - N. 2676.17'
Cast iron mon. (A-7) - S. 2671.99'
Cast iron mon. (M-6, T7N, R15W) - N. 53.85'

9/13/99
[Signature]

See sketch on back.

This position not established by original government surveyors. This monument is accepted as the best available evidence to the position of the corner.

C. Description of monument for corner and accessories established to perpetuate locating the position of the corner:

A-6
3/4" X 3' steel rod with remonumentation cap
Set nail and remonumentation tag in W. side of 50" Oak - N13°E 21.06'
Set nail and remonumentation tag in N. side 30" Oak - S65°W 23.31'
Set nail and remonumentation tag in N. side 7" Oak - N72°W 23.24'
Set nail and remonumentation tag in NE. side 7" Pine - S62°E 24.89'
Centerline of NE. - SW. gravel road - N0°W 50'
Centerline of N-S gravel drive - E. 43'
Cast iron monument - E. 0.93'
Cast iron mon. (M-6, T7N, R15W) - N. 53.85'

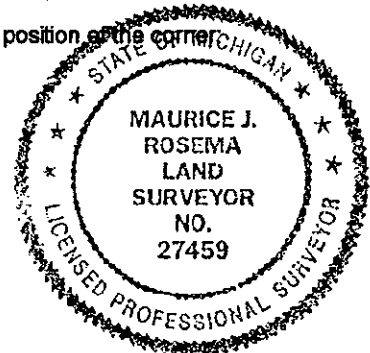

\$11.00 CORNER
Receipt #61757

Signed by *[Signature]*
Surveyor's Michigan License No. 27459

Date August 16, 1999

FEB 24 2000

SECTION

