

APR 05 1996

Ottawa County Remonumentation
LAND CORNER RECORDATION CERTIFICATE
Filing Requirement of Act 74, Mich. P.A. 1970

COMMISSION

For corners in

Ottawa _____ (County)	Located In:	Corner Code #
1. Public Land Survey	T <u>7N</u> R <u>14W</u>	B-13
	T _____ R _____	(S $\frac{1}{2}$ cor. of
	T _____ R _____	Section 31)
	T _____ R _____	Allendale Twp
2. Property Controlling in Section	S _____ T _____ R _____	_____
	S _____ T _____ R _____	_____
3. Miscellaneous Property in Sec.	S _____ T _____ R _____	_____
	S _____ T _____ R _____	_____
4. Lot No. _____, Recorded Plat _____		
5. Private Claims _____		

RECORDED

95 NOV 29 PM 1:47

Dorothy K. Carlsson
REGISTER OF DEEDS
OTTAWA COUNTY, MI

Register of Deeds Stamp & File Number

Maurice J. Rosema, in a field survey on Sept. 13, 19 95, do hereby certify that under requirements of P.A. 74, Michigan P.A. of 1970, the corner points mentioned in lines 1 and 2 above were in conformance with regulations and rules therefore as required in the current manual of survey instructions of the United States Department of the Interior, Bureau of Land Management or by a decree of a Court of Law and/or that the corner points mentioned in lines 3, 4 and 5 above were in conformance with the rules of the Michigan Board of Land Surveyors or by a Decree of a Court of Law; established, re-established, monumented, re-monumented, recovered, found as expressed below:

A	B	C	D	E	F	G	H	I	J	K	L
2	6	5	4	3	2						
3											
4	7	8	9	10	11						
5											
6	18	17	16	15	14						
7											
8	19	20	21	22	23	2					
9											
10	30	29	28	27	26	2					
11											
12	31	32	33	34	35	3					
13											

NOTE: Not more than 4 corners, all in the same town and range, may be recorded on this certificate.

A. Description of original monument and accesspries and/or subsequent restoration:
 B-13
 GLO - 1837 (John Mullett D.S.) L.C.R.C. recorded in Liber 4, L.C.R.C. recorded in Liber 6, Page 137 - December 10, 1980 6, Page 130 - May 24, 1991
 6" Beech is 1/4 Section post (over) (over)
 L.C.R.C. recorded in Liber 2, L.C.R.C. recorded in Liber 5, Page 583 - Sept. 20, 1974 Page 338 - November 18, 1988
 (over) (over)

B. Description of corner evidence found and/or method applied in restoring or reestablishing corner:
 B-13
 Found C.I. Monument in monument box
 Found C.I. Monument in monument box W 21.35'

PA. 345 OTTAWA COUNTY
PEER APPROVED 11-20-95

M. J. Rosema

I hereby accept this corner as a correct and accurate perpetuation of the position of the original corner.

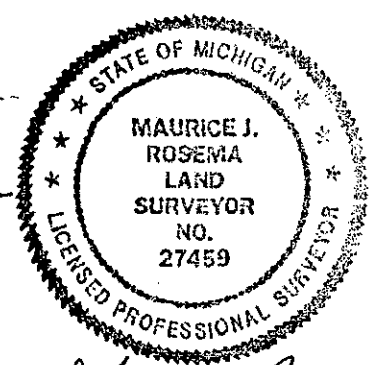

C. Description of monument for corner and accessories established to perpetuate locating the position of the corner:
 B-13
 C.I. Monument in monument box
 Set nail and Ottawa County remon. tag in E side P pole S4°W 48.40'
 Set nail and Ottawa County remon. tag in top of wood post S33°W 48.10'
 c/l street sign N50°E 48.78'
 Set nail and Ottawa County remon. tag in NE side P pole N62°W 134.55'
 Set nail and Ottawa County remon. tag in NE side P pole N31°W 112.74'
 C.I. Monument in monument box W 21.35'
 On c/l E-W bit. conc. road
 On c/l bit. conc. road to N

Signed by *M. J. Rosema* Date October 21, 1995
 Surveyor's Michigan License No. 27459

B-13, T7N, R14W

L.C.R.C. recorded in Liber 2, Page 283
- September 20, 1974

Steel bar	
PP	S 48.00'
T pole	N70°E 79.43'
24" Maple	N70°E 97.01'

L.C.R.C. recorded in Liber 4, page 137
- December 10, 1980

C.I. Monument	
Guy pole	ENE 79.42'
Tele ped	NW 42.24'
Fc post	SW 30.81'
St sign	SE 29.30'5'
Blendon corner	W 21.32'

L.C.R.C. recorded in Liber 5, Page 338
- November 18, 1988

C.I. Monument	
Nail and tag in face of wood post	ENE 79.47'
Nail and tag in face of P pole	S 48.00'
PK nail in NE side wood post at T box	NW 42.33'
c/l st sign	SE 29.41'

L.C.R.C. recorded in Liber 6, Page 130
- May 24, 1991

Cast Monument	
Blendon corner	W 21.30'
Nail in W side P pole	N35°W 112.61'
NE corner pole barn	S30°E 117.22'
Nail and tag in N side P pole	S5°W 47.95'
PK nail in top of second post	S40°W 42.69'

* 11.00 CORNER