

SURVEY & REMONUMENTATION

FEB 27 1998

SECTION

Ottawa County Remonumentation LAND CORNER RECORDATION CERTIFICATE Filing Requirement of Act 74, Mich. P.A. 1970

For corners in

Ottawa (County)	Located in:	Corner Code #
1. Public Land Survey	7N 14W T___ R___ T___ R___ T___ R___ T___ R___	D-9 N 1/4 cor. Sec. 29
2. Property Controlling in Section	S___ T___ R___ S___ T___ R___	_____
3. Miscellaneous Property in Sec.	S___ T___ R___ S___ T___ R___	_____

RECORDED

97 DEC -8 AM 11:29

[Signature]
REGISTER OF DEEDS
OTTAWA COUNTY, MI

Register of Deeds Stamp & File Number

4. Lot No. _____, Recorded Plat _____
5. Private Claims _____

Maurice J. Rosema, in a field survey on Nov. 28, 1997 do hereby state that under requirements of P.A. 74, Michigan P.A. of 1970, the corner points mentioned in lines 1 and 2 above were in conformance with regulations and rules therefore as required in the current manual of survey instructions of the United States Department of the Interior, Bureau of Land Management or by a decree of a Court of Law and/or that the corner points mentioned in lines 3, 4 and 5 above were in conformance with the rules of the Michigan Board of Land Surveyors or by a Decree of a Court of Law; established, re-established, monumented, recovered, found as expressed below:

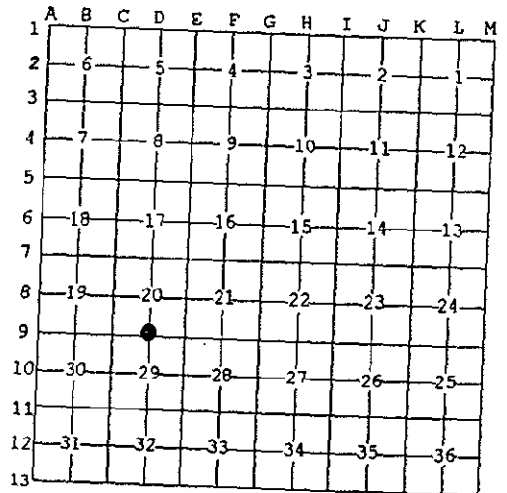

NOTE: Not more than 2 corners, all in the same town and range, may be recorded on this certificate.

A. Description of original monument and accessories and/or subsequent restoration:

- D-9
- GLO - Britain 1832 post 10" Hemlock - N80°W 12 lks 6" Beech - S60°E 18 lks
- LCRC per L. 2, P. 373 (1973) 1/2" pipe in mon. box
- LCRC per L. 6, P 188 (1991) angle iron in mon. box
- P pole - NW 92.85', 11" Ash - NE 115.52', Tele Ped post - SW 69.85', St sign - SE 55.92'
- LCRC per L. 4, P. 90 (1990) L - iron
- PK in NE side TP - SE 71.74'
- PK in NW side TP - SW 69.85'
- c/l M-45 - S 1.5'
- LCRC per L. 5, P. 225 (1985) angle iron
- c/l M-45 - S 1.5'
- PK in N side post at T box - SW 69.85'
- c/l st sign - SE 55.96'
- c/l top of conc. mon. - NE 94.08'
- c/l N-S road - E 4'

B. Description of corner evidence found and/or method applied in restoring or reestablishing corner:

- D-9
- Found angle iron in mon. box, replace iron with 5/8" X 2' steel rod with OC remon. cap
- Centerline of st. sign - SE 55.92'
- Centerline of M-45 bit. conc. - S 1.5'

P.A. 345 OTTAWA COUNTY

PEER APPROVED 12-1-97

[Signature]

I hereby accept this corner as a correct and accurate perpetuation of the position of the original corner.

C. Description of monument for corner and accessories established to perpetuate locating the position of the corner:

- D-9
- 5/8" x 2' steel rod with OC remon. cap in mon. box
- Set nail and remon. tag in E side P pole - N20°W 92.35'
- Set nail and remon. tag in E side P pole - S29°E 54.79'
- Set nail and remon. tag in NW side wood post at T box - S65°W 69.82'
- Centerline of st. sign (at base) - S33°E 55.91'
- Centerline of M-45 bit. conc. - S 1.5'
- On centerline of N-S gravel road

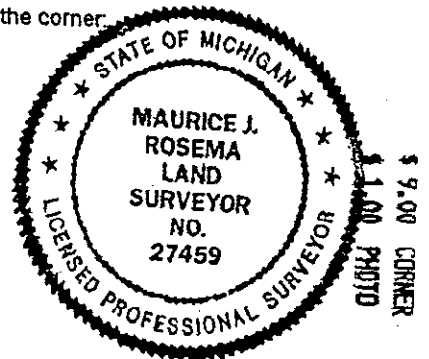

Signed by *[Signature]*
Surveyor's Michigan License No. 27459

Date Dec. 1, 1997