

**SURVEY &  
REMONUMENTATION**

DEC 01 1998

**SECTION**

**Ottawa County Remonumentation  
LAND CORNER RECORDATION CERTIFICATE  
Filing Requirement of Act 74, Mich. P.A. 1970**

For corners in

<u>Ottawa</u> <small>(County)</small>	Located In:	Corner Code #
1. Public Land Survey	T <u>7N</u> R <u>14W</u>	<u>E-4</u>
	T ___ R ___	<u>W 1/4 cor. Sec. 9</u>
	T ___ R ___	<u>Allendale Twp</u>
	T ___ R ___	_____
2. Property Controlling in Section	S ___ T ___ R ___	_____
	S ___ T ___ R ___	_____
3. Miscellaneous Property in Sec.	S ___ T ___ R ___	_____
	S ___ T ___ R ___	_____

**RECORDED**  
98 JUL 24 PM 1:47

*Gary S. Miller*  
REGISTER OF DEEDS  
OTTAWA COUNTY, MI

Register of Deeds Stamp & File Number

4. Lot No. \_\_\_\_\_, Recorded Plat \_\_\_\_\_  
5. Private Claims \_\_\_\_\_

	A	B	C	D	E	F	G	H	I	J	K	L	M
1													
2	6		5		4		3		2		1		
3													
4	7		8		9		10		11		12		
5													
6	18		17		16		15		14		13		
7													
8	19		20		21		22		23		24		
9													
10	30		29		28		27		26		25		
11													
12	31		32		33		34		35		36		
13													

I, Maurice J. Rosema, in a field survey on June 13, 1998 do hereby state that under requirements of P.A. 74, Michigan P.A. of 1970, the corner points mentioned in lines 1 and 2 above were in conformance with regulations and rules therefore as required in the current manual of survey instructions of the United States Department of the Interior, Bureau of Land Management or by a decree of a Court of Law and/or that the corner points mentioned in lines 3, 4 and 5 above were in conformance with the rules of the Michigan Board of Land Surveyors or by a Decree of a Court of Law; established, re-established, monumented, recovered, found as expressed below:

NOTE: Not more than 2 corners, all in the same town and range, may be recorded on this certificate.

A. Description of original monument and accessories and/or subsequent restoration:

E-4  
GLO survey notes - 1832  
(Noah Brookfield)  
8" W Ash at corner

B. Description of corner evidence found and/or method applied in restoring or reestablishing corner:

E-4  
Found no evidence of the corner  
Set 5/8" x 3' steel rod with OC remon. cap at mid-point and on line between  
E-3 (a C.I. mon.) and E-5 (a C.I. mon.)

I hereby accept the position of the steel rod with OC remon. cap as a careful perpetuation of the position of the original corner.

C. Description of monument for corner and accessories established to perpetuate locating the position of the corner:

E-4  
5/8" x 3' steel rod with OC remon. cap  
Set nail and remon. tag in NE side 6" Ash - S76°E 13.27'  
Set nail and remon. tag in N side 6" Ash - N89°E 33.73'  
Set nail and remon. tag in NW side 6" Willow clump - N0°W 12.61'  
Set nail and remon. tag in N side 4" Ash - N55°W 15.65'  
Centerline of E-W dirt lane - N 123'  
South edge of water of the Grand River - N 365'  
E-3 - N 2614.24'  
E-5 - S 2614.24'

PA. 345 OTTAWA COUNTY  
PEER APPROVED 6-15-98  
*M.J. Rosema*

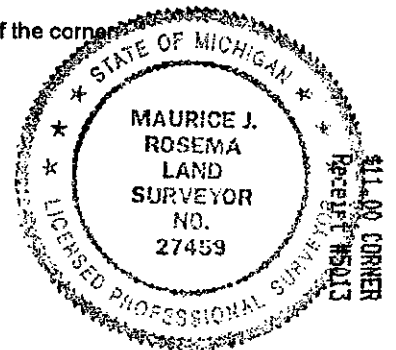

Signed by *Maurice J. Rosema*  
Surveyor's Michigan License No. 27459

Date June 13, 1998

SURVEY &  
REMONUMENTATION

DEC 01 1998

SECTION

