

SURVEY & RE-MONUMENTATION

Ottawa County Remonumentation

RECORDED

APR 24 1995

LAND CORNER RECORDATION CERTIFICATE
Filing Requirement of Act 74, Mich. P.A. 1970

94 DEC 15 AM 11:53

COMMISSION

For corners in

Richard P. Hedewell
 REGISTER OF DEEDS
 OTTAWA COUNTY, MI

Ottawa (County)	Located In:	Corner Code #
1. Public Land Survey	T <u>7N</u> R <u>14W</u>	<u>E-7</u>
	T _____ R _____	_____
	T _____ R _____	_____
	T _____ R _____	_____
2. Property Controlling in Section	S _____ T _____ R _____	_____
	S _____ T _____ R _____	_____
3. Miscellaneous Property in Sec.	S _____ T _____ R _____	_____
	S _____ T _____ R _____	_____

Register of Deeds Stamp & File Number

4. Lot No. _____, Recorded Plat _____
 5. Private Claims _____

	A	B	C	D	E	F	G	H	I	J	K	L	M
2	6	5	4	3	2	1							
3													
4	7	8	9	10	11	12							
5													
6	18	17	16	15	14	13							
7													
8	19	20	21	22	23	24							
9													
10	30	29	28	27	26	25							
11													
12	31	32	33	34	35	36							
13													

Maurice J. Rosema Oct. 4 1994

I, _____, in a field survey on _____, 19 _____, do hereby certify that under requirements of P.A. 74, Michigan P.A. of 1970, the corner points mentioned in lines 1 and 2 above were in conformance with regulations and rules therefore as required in the current manual of survey instructions of the United States Department of the Interior, Bureau of Land Management or by a decree of a Court of Law and/or that the corner points mentioned in lines 3, 4 and 5 above were in conformance with the rules of the Michigan Board of Land Surveyors or by a Decree of a Court of Law; established, re-established, monumented, re-monumented, recovered, found as expressed below:

NOTE: Not more than 4 corners, all in the same town and range, may be recorded on this certificate.

A. Description of original monument and accessories and/or subsequent restoration:
 E-7

- GLO - 1832 by Noah Brookfield for Calvin Britain D.S. 7" Beech - S77°E .15 ch.
- Englert - 1972 per L.C.R.C. rec. in L. 1, P. 611 (over)
- Greer - 1976 per L.C.R.C. rec. in L. 3, P. 88 (over)
- 6" Walnut - N28°W .15 ch.
- VanKooten - 1973 per L.C.R.C. rec. in L. 2, P. 187 (over)
- Joiner - 1980 per L.C.R.C. rec. in L. 4, P. 125 (over)

B. Description of corner evidence found and/or method applied in restoring or reestablishing corner:
 E-7

Found C.I. mon. (in gravel road 0.9' below grade)

I hereby accept this corner as a correct and accurate perpetuation of the position of the original corner.

PA. 345 OTTAWA COUNTY
 PEER APPROVED 12/12/94
Richard P. Hedewell

C. Description of monument for corner and accessories established to perpetuate locating the position of the corner:

- E-7
- C.I. mon.
- Set nail and remon. tag in W. side 22' Ash - N10°W 33.79'
- Set nail and remon. tag in SE. side 10" Pine - S22°E 38.24'
- Set nail and remon. tag in N. side Power pole - N83°E 87.03'
- Set nail and remon. tag in E. side 7" Pine - S30°W 36.75'

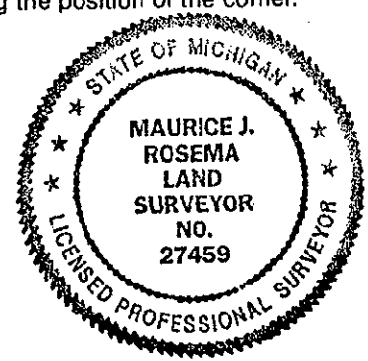

Dec. 10, 1994

Signed by *Maurice J. Rosema* Date _____
 Surveyor's Michigan License No. 27459

Part A - continued

Englert - 1972 per L.C.R.C. rec. in L. 1, P. 611

5/8" rod

16" Ash - NNW. 33.78'

Fence post - NW. 55.79'

14" Apple - SW. 61.20'

14" Oak - SE. 43.55'

VanKooten - 1973 per L.C.R.C. rec. in L. 2, P. 187

1/2" solid rod

Nail in side 12" Ash - NNW. 33.79'

Nail in side 10" Apple - SW. 61.24'

Nail in side 18" Ash - SSE. 49.61'

Greer - 1976 per L.C.R.C. rec. in L. 3, P. 88

5/8" steel rod

14" Oak - SE. 43.58'

14" Apple - SW. 61.20'

Fence post - NW. 55.82'

16" Ash - NNW. 33.82'

18" Willow - SE. 49.61'

Joiner - 1980 per L.C.R.C. rec. in L. 4, P. 125

C.I. mon.

17" Ash - NNW. 33.92'

14" Apple - SW. 61.16'

24" Willow - SE. 49.64'

DATE #
OWNER
CODE #
HSSM