

APR 24 1995

Ottawa County Remonumentation

RECORDED

COMMISSION

LAND CORNER RECORDATION CERTIFICATE
Filing Requirement of Act 74, Mich. P.A. 1970

94 DEC 15 AM 11:51

For corners in

Ottawa
(County)

Located In:

Corner Code #

- | | | |
|------------------------------------|--------------------------|-------------|
| 1. Public Land Survey | T <u>7N</u> R <u>14W</u> | <u>E-11</u> |
| | T _____ R _____ | _____ |
| | T _____ R _____ | _____ |
| | T _____ R _____ | _____ |
| 2. Property Controlling in Section | S _____ T _____ R _____ | _____ |
| | S _____ T _____ R _____ | _____ |
| 3. Miscellaneous Property in Sec. | S _____ T _____ R _____ | _____ |
| | S _____ T _____ R _____ | _____ |

Dorothy Robinson
REGISTER OF DEEDS
OTTAWA COUNTY, MI

Register of Deeds Stamp & File Number

4. Lot No. _____, Recorded Plat _____
5. Private Claims _____

Maurice J.
Rosema

Jan. 2 94

I, _____, in a field survey on _____, 19 _____, do hereby certify that under requirements of P.A. 74, Michigan P.A. of 1970, the corner points mentioned in lines 1 and 2 above were in conformance with regulations and rules therefore as required in the current manual of survey instructions of the United States Department of the Interior, Bureau of Land Management or by a decree of a Court of Law and/or that the corner points mentioned in lines 3, 4 and 5 above were in conformance with the rules of the Michigan Board of Land Surveyors or by a Decree of a Court of Law; established, re-established, monumented, re-monumented, recovered, found as expressed below:

NOTE: Not more than 4 corners, all in the same town and range, may be recorded on this certificate.

A. Description of original monument and accessories and/or subsequent restoration:

E-11

GLO - 1832 signed by Noah Brookfield for Calvin Britain D.S. 20" Sugar - S62°E .48 ch. 20" Walnut - N52°W .36 ch.

VanKooten - 1980 per L.C.R.C. rec. in L. 4, P. 91 T-iron P.K. in E. side T. pole - N. 47.8' Nail in SW. side fc. post - SE. 47.5' Nail in N. side 10" Maple clump - ESE. 77.2'

Joiner - 1981 per L.C.R.C. rec. in L. 4, P. 192 (over)

B. Description of corner evidence found and/or method applied in restoring or reestablishing corner:

E-11

Found C.I. mon. 0.5' below grade
Found spike in W. side P. pole - N2°W 47.52'

14,345 OTTAWA COUNTY
PEER APPROVED 4/18/94
Marcy D. Hedewell

I hereby accept this corner as a correct and accurate perpetuation of the position of the original corner.

C. Description of monument for corner and accessories established to perpetuate locating the position of the corner:

E-11

C.I. mon.
On centerline of N.-S. gravel road
Set nail and remon. tag in W. side T. post - S40°E 45.84'
Set nail and remon. tag in W. side P. pole - N2°W 47.52'
Set nail and remon. tag in E. side wood fc. post - N51°E 36.45'
Set nail and remon. tag in N. side 40" Ash - S76°E 137.15'
Set nail and remon. tag in S. side wood fc. post - N40°W 62.58'

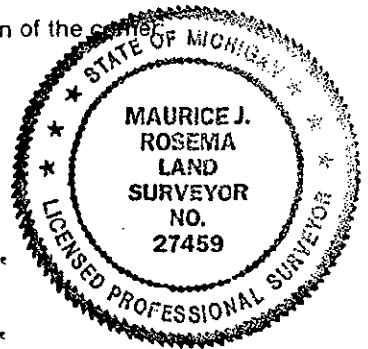

Signed by *Maurice J. Rosema* Date April 18, 1994
Surveyor's Michigan License No. 27459

Part A - continued

Joiner - 1981 per L.C.R.C. rec.
in L. 4, P. 192

Corner fc. post - SE. 47.56'

11" Cherry - ESE. 77.11'

Power pole - N. 47.55'

Fc. post - NE. 27.14'

CODE #
OWNER
PAGE #
4228