

**SURVEY &
REMONUMENTATION**

DEC 01 1998

Ottawa County Remonumentation

SECTION

LAND CORNER RECORDATION CERTIFICATE
Filing Requirement of Act 74, Mich. P.A. 1970

For corners in

<u>Ottawa</u> <small>(County)</small>	Located In:	Corner Code #
1. Public Land Survey	T <u>7N</u> R <u>14W</u>	<u>F-1</u>
	T ___ R ___	N 1/4 cor. Sec. 4
	T ___ R ___	Polkton Twp
2. Property Controlling in Section	T <u>8N</u> R <u>14W</u>	<u>F-13</u>
3. Miscellaneous Property in Sec.	S ___ T ___ R ___	_____
	S ___ T ___ R ___	_____
	S ___ T ___ R ___	_____
	S ___ T ___ R ___	_____

RECORDED
98 JUL 24 PM 1:47

M. J. Rosema
REGISTER OF DEEDS
OTTAWA COUNTY, MI

Register of Deeds Stamp & File Number

4. Lot No. _____, Recorded Plat _____
5. Private Claims _____

I, Maurice J. Rosema, in a field survey on Jan. 28, 1998 do hereby state that under requirements of P.A. 74, Michigan P.A. of 1970, the corner points mentioned in lines 1 and 2 above were in conformance with regulations and rules therefore as required in the current manual of survey instructions of the United States Department of the Interior, Bureau of Land Management or by a decree of a Court of Law and/or that the corner points mentioned in lines 3, 4 and 5 above were in conformance with the rules of the Michigan Board of Land Surveyors or by a Decree of a Court of Law; established, re-established, monumented, recovered, found as expressed below:

NOTE: Not more than 2 corners, all in the same town and range, may be recorded on this certificate.

	A	B	C	D	E	F	G	H	I	J	K	L	M
1													
2	6		5		4		3		2		1		
3													
4	7		8		9		10		11		12		
5													
6	10		17		16		15		14		13		
7													
8	19		20		21		22		23		24		
9													
10	30		29		28		27		26		25		
11													
12	31		32		33		34		35		36		
13													

A. Description of original monument and accessories and/or subsequent restoration:

F-1
This corner was not set by GLO
LCRC rec. in Liber 3, Page 572 (1997 by Vugteveen)
(rec. as F-13, T8N, R14W) C.I. mon.
nail and OC remon. tag in SE side 38" Maple - 70.50' (no AZ stated)
nail and OC remon. tag in NE side 30" Oak - AZ 112° 51.36'
nail and OC remon. tag in NW side 60" Oak - AZ 247° 58.61'
nail and OC remon. tag in E side 22" Walnut - AZ 344° 85.72'
Centerline of E-W road - S 2'
On centerline of road to N

B. Description of corner evidence found and/or method applied in restoring or reestablishing corner:

F-1
Found C.I. mon. 0.5' below grade
Found nail and remon. tag in N side 34" Oak - SE 51.43'
Found nail and remon. tag in N side 48" Oak - WSW 58.64'
Found nail and remon. tag in E side 20" Walnut - NNW 85.81'
At centerline of E-W-N gravel roads

FILED APPROVED 6-15-98
M. J. Rosema

I hereby accept the C.I. mon. as the position of the corner.

C. Description of monument for corner and accessories established to perpetuate locating the position of the corner:

F-1
C.I. mon.
Found nail and remon. tag in N side 34" Oak - S64°E 51.43'
Found nail and remon. tag in N side 48" Oak - S72°W 58.64'
Found nail and remon. tag in E side 20" Walnut - N11°W 85.81'
Set nail and remon. tag in E side 10" Walnut - S30°E 35.23'
Set nail and remon. tag in NE side 8" Walnut - S25°E 57.73'
This corner is common with F-13, T8N, R14W
At centerline of E-W-N gravel roads

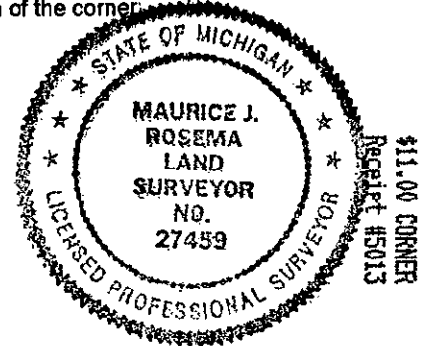

Signed by *Maurice J. Rosema*
Surveyor's Michigan License No. 27459

Date June 13, 1998

SURVEY &
REMONUMENTATION

DEC 01 1998

SECTION

