

FEB 24 2000

RECORDED

99 OCT 27 PM 1:50

SECTION

Ottawa County Remonumentation
LAND CORNER RECORDATION CERTIFICATE
Filing Requirement of Act 74, Mich. P.A. 1970

Larry Mullett
REGISTER OF DEEDS
OTTAWA COUNTY, MICH.

For corners in

Ottawa

(County)

Located In:

Corner Code #

1. Public Land Survey

T7N R14W

G-2

T R

W 1/4 corner, Section 3

T R

Polkton Township

T R

2. Property Controlling
in Section

S T R

S T R

3. Miscellaneous
Property in Sec.

S T R

S T R

Register of Deeds Stamp & File Number

4. Lot No. _____, Recorded Plat _____

5. Private Claims _____

	A	B	C	D	E	F	G	H	I	J	K	L	M
1													
2	6		5		4		3		2		1		
3													
4	7		8		9		10		11		12		
5													
6	18		17		16		15		14		13		
7													
8	19		20		21		22		23		24		
9													
10	30		29		28		27		26		25		
11													
12	31		32		33		34		35		36		
13													

Maurice J. Rosema, in a field survey on Oct. 16, 1999 do hereby state that under requirements of P.A. 74, Michigan P.A. of 1970, the corner points mentioned in lines 1 and 2 above were in conformance with regulations and rules therefore as required in the current manual of survey instructions of the United States Department of the Interior, Bureau of Land Management or by a decree of a Court of Law and /or that the corner points mentioned in lines 3, 4 and 5 above were in conformance with the rules of the Michigan Board of Land Surveyors or by a Decree of a Court of Law; established, re-established, monumented, recovered, found as expressed below:

NOTE: Not more than 2 corners, all in the same town and range, may be recorded on this certificate.

A. Description of original monument and accessories and/or subsequent restoration:

G-2

GLO - 1837

Ottawa County Surveyor Records (no date)

J. Mullett D.S.

fence East - West - North

Set post

Center of Sec. 3 - E 2613'

8" Sugar - S22°W

West 1/4 corner of Sec. 4 - W 5334.00'

12 links

8" Sugar - N30°E

45 links

B. Description of corner evidence found and/or method applied in restoring or reestablishing corner:

G-2

No corner found, this corner lies in a plowed field

Set a 3/4" x 3' steel rod with remon. cap on line with fence to East (as shown on back)

I hereby accept this corner as a correct and accurate perpetuation of the position of the original corner.

C. Description of monument for corner and accessories established to perpetuate locating the position of the corner:

G-2

3/4" x 3' steel rod with remonumentation cap 1' below grade in plowed field

Set nail and remonumentation tag in E side twin 6" Hickory - N2°E 658.55'

Set nail and remonumentation tag in E side twin 6" Oak - N9°E 660.56'

Set nail and remonumentation tag in E side 8" oak - N15°E 664.93'

Set nail and remonumentation tag in E side 6" Hickory - N25°E 701.72'

10/18/99
MJR

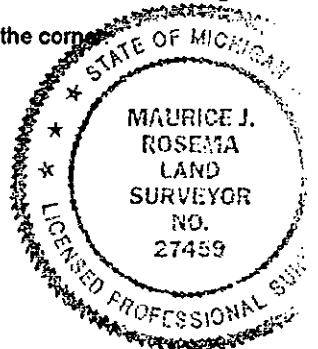

\$11.00 CORNER
Receipt #61757

Signed by *M. Rosema*
Surveyor's Michigan License No. 27459

Date October 16, 1999

FEB 24 2000

SECTION

