

FEB 24 2000

SECTION

Ottawa County Remonumentation
LAND CORNER RECORDATION CERTIFICATE
Filing Requirement of Act 74, Mich. P.A. 1970

RECORDED

99 OCT 27 PM 1:49

For corners in
Ottawa
(County)

Located In: Corner Code #

- 1. Public Land Survey
T 7N R 14W G-10
T R W 1/4 cor. Section 27
T R Allendale Township
T R
- 2. Property Controlling in Section
S T R
- 3. Miscellaneous Property in Sec.
S T R
S T R

Gay Schultz
REGISTER OF DEEDS
OTTAWA COUNTY, MI

Register of Deeds Stamp & File Number

- 4. Lot No. _____, Recorded Plat _____
- 5. Private Claims _____

	A	B	C	D	E	F	G	H	I	J	K	L	M
1													
2	6		5		4		3		2		1		
3													
4	7		8		9		10		11		12		
5													
6	18		17		16		15		14		13		
7													
8	19		20		21		22		23		24		
9													
10	30		29		28		27		26		25		
11													
12	31		32		33		34		35		36		
13													

Maurice J. Rosema, in a field survey on Sept. 11, 1999 do hereby state that under requirements of P.A. 74, Michigan P.A. of 1970, the corner points mentioned in lines 1 and 2 above were in conformance with regulations and rules therefore as required in the current manual of survey instructions of the United States Department of the Interior, Bureau of Land Management or by a decree of a Court of Law and /or that the corner points mentioned in lines 3, 4 and 5 above were in conformance with the rules of the Michigan Board of Land Surveyors or by a Decree of a Court of Law; established, re-established, monumented, recovered, found as expressed below:

NOTE: Not more than 2 corners, all in the same town and range, may be recorded on this certificate.

A. Description of original monument and accessories and/or subsequent restoration:

- G-10
GLO - 1832
Britain D.S.
11" Beech at corner
- LCRC per Liber 2, Page 369 (Roon - 1973)
T fence post
Fence West - N. 1'
Fence East - S. 3'
10" Ash - NW. 12.44'
24" Ash - W. 55.38'
30" Ash - S. 32.09'
- LCRC per Liber 3, Page 311 (Campbell - 1978)
1/2" solid rod
10" Pine - N37°E 52.94'
24" Maple - S41°W 47.34'
T. pole - N85°W 28.11'
- LCRC per Liber 5, Page 240 (Rosema - 1986)
T fence post
Nail in fc 30" Ash - S. 32.10'
PK in fc 24" Ash - S. 55.27'
Nail in S. side 30" Maple - E. 54.48'
Nail in E. side 15" Maple - NNE. 32.25'
Nail in N. side 24" Ash - W. 56.10'

B. Description of corner evidence found and/or method applied in restoring or reestablishing corner:

- G-10
Found Cast iron monument on tree row to S. and on E.-W. fence line
Found nail in N. side 30" Ash - S. 32.04'
Found nail in S. side 30" Maple - E. 54.56'
Centerline of 20" Maple - NNE. 32'
Centerline of 24" Ash - W. 56'

I hereby accept this corner as a correct and accurate perpetuation of the position of the original corner.

C. Description of monument for corner and accessories established to perpetuate locating the position of the corner:

- G-10
Cast iron monument
Set nail and remonumentation tag in E. side 30" Ash - S0°E 33.95'
Set nail and remonumentation tag in S. side 30" Maple - S84°E 54.46'
Set nail and remonumentation tag in E. side 20" Maple - N19°W 32.20'
Set nail and remonumentation tag in N. side 24" Ash - N90°W 56.07'

9/13/99
YDZ

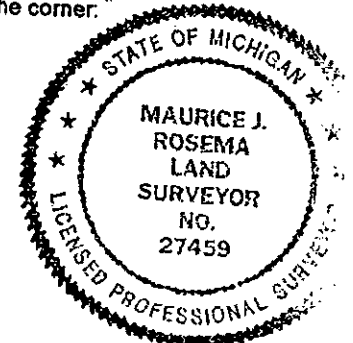

72-00-00000
Receipt #61757

Signed by Maurice J. Rosema
Surveyor's Michigan License No. 27459

Date September 11, 1999