

SURVEY & REMONUMENTATION

APR 24 1995

Ottawa County Remonumentation
LAND CORNER RECORDATION CERTIFICATE
 Filing Requirement of Act 74, Mich. P.A. 1970

RECORDED

94 DEC 15 AM 11:56

COMMISSION

Dorothy Hillman
 REGISTER OF DEEDS
 OTTAWA COUNTY, MI

For corners in

Ottawa

(County)

Located In:

Corner Code #

- | | | |
|------------------------------------|--------------------------|-------------|
| 1. Public Land Survey | T <u>7N</u> R <u>14W</u> | <u>G-12</u> |
| | T _____ R _____ | _____ |
| | T _____ R _____ | _____ |
| | T _____ R _____ | _____ |
| 2. Property Controlling in Section | S _____ T _____ R _____ | _____ |
| | S _____ T _____ R _____ | _____ |
| 3. Miscellaneous Property in Sec. | S _____ T _____ R _____ | _____ |
| | S _____ T _____ R _____ | _____ |

Register of Deeds Stamp & File Number

4. Lot No. _____, Recorded Plat _____
 5. Private Claims _____

	A	B	C	D	E	F	G	H	I	J	K	L	M
2	6		5		4		3		2		1		
3													
4	7		8		9		10		11		12		
5													
6	18		17		16		15		14		13		
7													
8	19		20		21		22		23		24		
9													
10	30		29		28		27		26		25		
11													
12	31		32		33		34		35		36		
13													

Maurice J. Rosema

Oct. 17, 1994

I, _____, in a field survey on _____, 1994, do hereby certify that under requirements of P.A. 74, Michigan P.A. of 1970, the corner points mentioned in lines 1 and 2 above were in conformance with regulations and rules therefore as required in the current manual of survey instructions of the United States Department of the Interior, Bureau of Land Management or by a decree of a Court of Law and/or that the corner points mentioned in lines 3, 4 and 5 above were in conformance with the rules of the Michigan Board of Land Surveyors or by a Decree of a Court of Law; established, re-established, monumented, re-monumented, recovered, found as expressed below:

NOTE: Not more than 4 corners, all in the same town and range, may be recorded on this certificate.

A. Description of original monument and accessories and/or subsequent restoration:

- G-12
 GLO - 1832 by Noah Brookfield for Calvin Britain D.S.
 10" Hemlock - N32°E .18 ch.
 10" Beech - S54°W .17 ch.
 Bonnema - 1972 per L.C.R.C. rec. in L. 1, P. 311 (over)
 Joiner - 1981 per L.C.R.C. rec. in L. 4, P. 195 (over)

B. Description of corner evidence found and/or method applied in restoring or reestablishing corner:

- G-12
 Found C.I. mon. (0.3' below grade)
 Found nail in SW. side 24" Beech - S37°E 37.88'
 Found nail in S. side 23" Ash - N78°E 51.35'
 Found nail in NW. side 29" Beech - N36°E 58.28'

I hereby accept this corner as a correct and accurate perpetuation of the position of the original corner.

PA. 345 OTTAWA COUNTY
 PEER APPROVED 12/12/94
M. J. Rosema

C. Description of monument for corner and accessories established to perpetuate locating the position of the corner:

- G-12
 C.I. mon.
 Set nail and remon. tag in SW. side 24" Beech - S37°E 37.88'
 Set nail and remon. tag in S. side 23" Ash - N78°E 51.35'
 Set nail and remon. tag in NW. side 29" Beech - N36°E 58.28'
 Set nail and remon. tag in NE. side 7" Maple - N30°W 57.25'

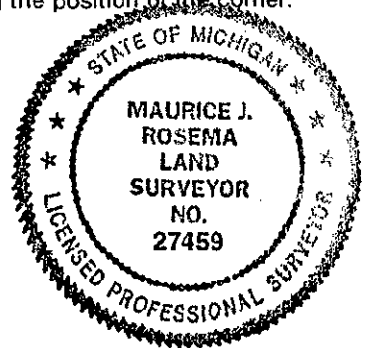

Signed by *M. J. Rosema* Date Dec. 10, 1994

Surveyor's Michigan License No. 27459

FORM APPROVED BY MICHIGAN STATE BOARD OF LAND SURVEYORS, JAN. 26, 1971
 REVISED MAY 14, 1975
 REVISED JAN., 1993

Part A - continued

Bonnema - 1972 per L.C.R.C. rec. in L. 1, P. 311

L-iron

30" Beech - NE. 57.47'

20" Ash - ENE. 50.8'

22" Beech - SE. 36.9'

Joiner - 1981 per L.C.R.C. rec. in L. 4, P. 195

C.I. mon.

29" Beech - NE. 58.29'

23" tree - ENE. 51.44'

24" Beech - SE. 37.82'

10" tree - NW. 56.86'

MSR
3000
3000
3000

100
100
100