

SURVEY & REMONUMENTATION

DEC 01 1998

Ottawa County Remonumentation

LAND CORNER RECORDATION CERTIFICATE
Filing Requirement of Act 74, Mich. P.A. 1970

SECTION

For corners in

<u>Ottawa</u> (County)	Located In:	Corner Code #
1. Public Land Survey	T <u>7N</u> R <u>14W</u>	<u>I-1</u> NW cor. Sec. 2 Polkton Twp
	T ___ R ___	___
	T ___ R ___	___
	T ___ R ___	___
2. Property Controlling in Section	S ___ T <u>8N</u> R <u>14W</u>	<u>I-13</u>
	S ___ T ___ R ___	___
3. Miscellaneous Property in Sec.	S ___ T ___ R ___	___
	S ___ T ___ R ___	___

RECORDED
98 JUL 24 PM 1:45

Mary Schiele
REGISTER OF DEEDS
OTTAWA COUNTY, MI

Register of Deeds Stamp & File Number

4. Lot No. _____, Recorded Plat _____
5. Private Claims _____

Maurice J. Rosema Jan. 28 98
I, _____, in a field survey on _____, 19____ do hereby state that under requirements of P.A. 74, Michigan P.A. of 1970, the corner points mentioned in lines 1 and 2 above were in conformance with regulations and rules therefore as required in the current manual of survey instructions of the United States Department of the Interior, Bureau of Land Management or by a decree of a Court of Law and /or that the corner points mentioned in lines 3, 4 and 5 above were in conformance with the rules of the Michigan Board of Land Surveyors or by a Decree of a Court of Law; established, re-established, monumented, recovered, found as expressed below:

NOTE: Not more than 2 corners, all in the same town and range, may be recorded on this certificate.

	A	B	C	D	E	F	G	H	I	J	K	L	M
1													
2	6	5	4	3	2	1							
3													
4	7	8	9	10	11	12							
5													
6	18	17	16	15	14	13							
7													
8	19	20	21	22	23	24							
9													
10	30	29	28	27	26	25							
11													
12	31	32	33	34	35	36							
13													

A. Description of original monument and accessories and/or subsequent restoration:

<p>I-1 GLO survey notes - 1837 by surveyor Mullett post 32" B Oak - S56°E 16 links</p>	<p>LCRC rec in Liber 1, Page 729 (1972 - Spicer) 3/4" iron nail and tag in c/l MBT pole - S75°W 74.6' nail and tag in c/l guy pole - S75°E 75.3' SW cor brick bldg. - N40°E 100.4'</p>	<p>LCRC rec. in Liber 1, Page 477 (1994 - Schiele) (rec. as I-13, T8N, R14W) SW cor. brick fc. to hse. #6365 - N18°E 160.13' nail and OC remon. tag in SE side 8" Maple - N18°E 160.13' nail and OC remon. tag in SE side 8" Maple - N40°E 37.40' nail and OC remon. tag in W side wood post - S10°E 26.22' nail and OC remon. tag in SW side 22" Hickory - - N35°W 35.55'</p>
--	--	--

B. Description of corner evidence found and/or method applied in restoring or reestablishing corner:

I-1
Found C.I. mon. in E-W gravel road 0.3' below grade
Found nail and remon. tag in SE side 9" Maple - NE 93.37'
Found nail and remon. tag in W side wood post - SSE 26.24'
Found nail and remon. tag in SW side 22" Hickory - NW 35.55'
Found nail and remon. tag in SE side 8" Maple - NE 37.41'
Centerline of E-W gravel road - S 4'

Occupation line to S - E 7' +/-
c/l E-W gravel road - S 3'

I hereby accept the position of the C.I. mon. as a careful perpetuation of the position of the original corner.

C. Description of monument for corner and accessories established to perpetuate locating the position of the corner:

I-1
C.I. mon.
Found nail and remon. tag in Se side 9" Maple - N77°E 93.37'
Found nail and remon. tag in W side 0.5' x 0.5' wood post - S9°E 26.24'
Found nail and remon. tag in SW side 22" Hickory - N33°W 35.55'
Found nail and remon. tag in SE side 8" Hickory - N45°E 37.41'
Centerline of E-W gravel road - S 4'
This corner is common with I-13, T8N, R14W

REGISTER APPROVED 6-15-98
M.J.R.

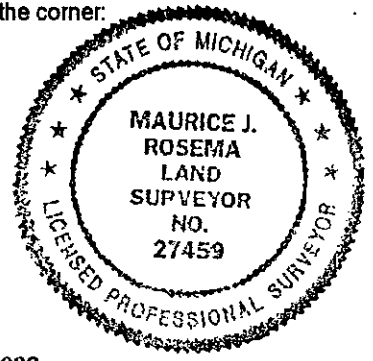

Signed by *Maurice J. Rosema*
Surveyor's Michigan License No. 27459

Date June 13, 1998

SURVEY &
REMONUMENTATION

DEC 01 1998

SECTION

