

SURVEY & REMONUMENTATION

Ottawa County Remonumentation

APR 24 1995

LAND CORNER RECORDATION CERTIFICATE
Filing Requirement of Act 74, Mich. P.A. 1970

RECORDED

94 DEC 15 AM 11:52

COMMISSION

For corners in

Ottawa
(County)

Located In:

Corner Code ##

- | | | |
|------------------------------------|--------------------------|------------|
| 1. Public Land Survey | T <u>7N</u> R <u>14W</u> | <u>I-7</u> |
| | T _____ R _____ | _____ |
| | T _____ R _____ | _____ |
| | T _____ R _____ | _____ |
| 2. Property Controlling in Section | S _____ T _____ R _____ | _____ |
| | S _____ T _____ R _____ | _____ |
| 3. Miscellaneous Property in Sec. | S _____ T _____ R _____ | _____ |
| | S _____ T _____ R _____ | _____ |

D. J. Hallman
REGISTER OF DEEDS
OTTAWA COUNTY, MI

Register of Deeds Stamp & File Number

4. Lot No. _____, Recorded Plat _____
5. Private Claims _____

Maurice J.
Rosema

Oct. 11 94

I, _____, in a field survey on _____, 19 _____, do hereby certify that under requirements of P.A. 74, Michigan P.A. of 1970, the corner points mentioned in lines 1 and 2 above were in conformance with regulations and rules therefore as required in the current manual of survey instructions of the United States Department of the Interior, Bureau of Land Management or by a decree of a Court of Law and/or that the corner points mentioned in lines 3, 4 and 5 above were in conformance with the rules of the Michigan Board of Land Surveyors or by a Decree of a Court of Law; established, re-established, monumented, re-monumented, recovered, found as expressed below:

NOTE: Not more than 4 corners, all in the same town and range, may be recorded on this certificate.

	A	B	C	D	E	F	G	H	I	J	K	L	M
2	6	5	4	3	2	1							
3													
4	7	8	9	10	11	12							
5													
6	18	17	16	15	14	13							
7													
8	19	20	21	22	23	24							
9													
10	30	29	28	27	26	25							
11													
12	31	32	33	34	35	36							
13													

A. Description of original monument and accessories and/or subsequent restoration:

I-7

- | | | |
|--|--|--|
| GLO - 1832 signed by Noah Brookfield for Calvin Britain D.S.
10" Elm - N84°W .9 ch.
10" Walnut - N89°E .32 ch. | Rosema - 1984 per L.C.R.C. rec. in L. 5, P. 150 (over)
Rosema - 1988 per L.C.R.C. rec. in L. 5, P. 317 (over) | Joiner - 1991 per L.C.R.C. rec. in L. 6, P. 156 (over) |
|--|--|--|

B. Description of corner evidence found and/or method applied in restoring or reestablishing corner:

I-7

- Found C.I. mon.
Found nail in W. side 10" Apple - S37°E 123.57'

RIA: 045 OTTAWA COUNTY
PEER APPROVED
Walter D. Wederfeld

I hereby accept this corner as a correct and accurate perpetuation of the position of the original corner.

C. Description of monument for corner and accessories established to perpetuate locating the position of the corner:

I-7

- C.I. mon.
Set nail and remon. tag in W. side 10" Apple - S37°E 123.57'
Set nail and remon. tag in SE. side wood fence post - N64°W 38.25'
Set nail and remon. tag in S. side wood fence post - S84°E 29.49'
Set nail and remon. tag in W. side 22" Ash - N19°W 31.30'

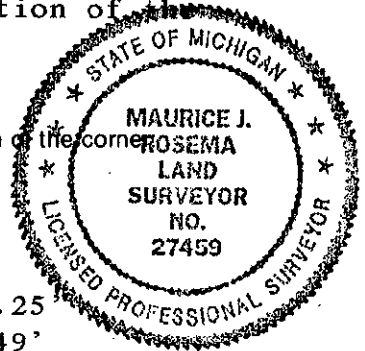

Signed by *Maurice J. Rosema*
Surveyor's Michigan License No. 27459

Nov. 19, 1994

Part A - continued

Rosema - 1984 per L.C.R.C. rec. in L. 5, P. 150

T-fence post

Nail in NW. side tri. 12" Willow - NNE. 49.13'

Nail and tag in N. side 30" Maple - W. 30.45'

Nail in W. side cor. wood fence post - E. 30.63'

Rosema - 1988 per L.C.R.C. rec. in L. 5, P. 317

Capped 1/2" rerod

Nail and tag in E. side 20" Elm - NNW. 31.49'

Nail and tag in N. side 15" Elm - WNW. 53.48'

On fence line to E.

N.-S. fence line - W. 49'

On old fence line to S.

Joiner - 1991 per L.C.R.C. rec. in L. 6, P. 156

C.I. mon.

Fence post - NW. 38.54'

RR spike in 20" tree - NNW. 30.50'

Fence post - E. 30.61'

10" Apple - SE. 123.61'

2000
120 N
9.00
120 N