

RECORDED

93 DEC 15 AM 9:28

Ottawa County remonumentation

LAND CORNER RECORDATION CERTIFICATE

Filing Requirement of Act 74, Mich. P.A. 1970

REGISTER OF DEEDS  
OTTAWA COUNTY, MI

For corners in  
Ottawa

(County)	Located In:	Corner Code #
1. Public Land Survey	T <u>7N</u> R <u>14W</u>	<u>J-5</u>
	T _____ R _____	_____
	T _____ R _____	_____
	T _____ R _____	_____
2. Property Controlling in Section	S _____ T _____ R _____	_____
	S _____ T _____ R _____	_____
3. Miscellaneous Property in Sec.	S _____ T _____ R _____	_____
	S _____ T _____ R _____	_____

Register of Deeds Stamp & File Number

4. Lot No. \_\_\_\_\_, Recorded Plat \_\_\_\_\_  
5. Private Claims \_\_\_\_\_

	A	B	C	D	E	F	G	H	I	J	K	L	M
2	6	5	4	3	2	1							
3													
4	7	8	9	10	11	12							
5													
6	18	17	16	15	14	13							
7													
8	19	20	21	22	23	24							
9													
10	30	29	28	27	26	25							
11													
12	31	32	33	34	35	36							
13													

I, Maurice J. Rosema, in a field survey on July 13, 19 93, do hereby certify that under requirements of P.A. 74, Michigan P.A. of 1970, the corner points mentioned in lines 1 and 2 above were in conformance with regulations and rules therefore as required in the current manual of survey instructions of the United States Department of the Interior, Bureau of Land Management or by a decree of a Court of Law and/or that the corner points mentioned in lines 3, 4 and 5 above were in conformance with the rules of the Michigan Board of Land Surveyors or by a Decree of a Court of Law; established, re-established, monumented, re-monumented, recovered, found as expressed below:

NOTE: Not more than 4 corners, all in the same town and range, may be recorded on this certificate.

A. Description of original monument and accessories and/or subsequent restoration:

J-5 Medema and VanKooten Assoc. - 1972 per L.C.R.C. recorded in Liber 1, Page 463 Iron at c/l x of gravel Nail in P. pole - SE 168.68' Nail in T. pole - SE 40.05' c/l st. sign post - SE 34.3' Nail in P. pole - NE 165.45' Nail in 36" Maple - NNW 278.32'	Joiner - 1981 per L.C.R.C. recorded in Liber 4, Page 220 C.I.M. St. sign - ESE 34.50' c/l hydrant - S# 46.83' Warning sign - NE 46.95'	Tru-Line surveying - 1984 and 1988 (unrecorded) P.K. nail in SW side wood post at T. box - SE 38.04' Yield sign (at base) - WSW 59.23' P.K. nail in NW side P. pole - NE 166.02' c/l top of hydrant - SE 46.85' at c/l x of gravel roads
--	--	---

B. Description of corner evidence found and/or method applied in restoring or reestablishing corner:

J-5 C.I. monument  
Centerline of top of hydrant - S27°E 46.82'  
Found P.K. nail in SW side T. box post - S49°E 38.02'  
Found P.K. nail in NW side P. pole - N44°E 166.05'  
Centerline of "Yield" sign - N76°E 46.44'

(NOTE: This corner was found and witnessed prior to road construction. During construction the C.I. monument was removed, I replaced it with 5/8" x 36" steel rod and O.C. remon. cap after construction).

I hereby accept this corner as a correct and accurate perpetuation of the position of the original section corner.

C. Description of monument for corner and accessories established to perpetuate locating the position of the corner

J-5 5/8" x 36" steel rod and O.C. remon. cap  
Centerline of "Dead end" sign - N18°E 46.98'  
Centerline of Tele. Ped. (at base) - S60°W 60.20'  
Set nail and O.C. remon. tag in NW side P. pole - N44°E 165.93'  
Center of top hydrant - S27°E 46.82'  
Centerline of "Yield" sign (at base) - N76°E 46.44'  
Set nail and O.C. remon. tag in SW side T. box post - S49°E 38.00'  
At centerline "x" of gravel road E and N and bit. conc. road S and W

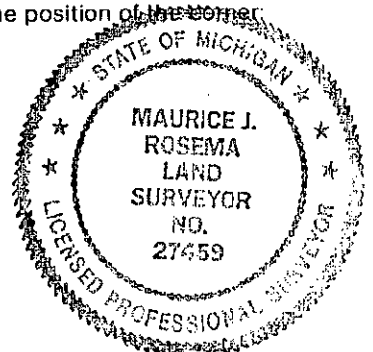

Signed by Maurice J. Rosema  
Surveyor's Michigan License No. 27459

Date September 3, 1993