

APR 05 1996

Ottawa County Remonumentation

COMMISSION

LAND CORNER RECORDATION CERTIFICATE
Filing Requirement of Act 74, Mich. P.A. 1970

For corners in

<u>Ottawa</u> <small>(County)</small>	Located In:	Corner Code #
1. Public Land Survey	T <u>7N</u> R <u>14W</u>	M-7
	T _____ R _____	(SE cor. of
	T _____ R _____	Section 13)
	T _____ R _____	Allendale Twp
2. Property Controlling in Section	S _____ T _____ R _____	_____
	S _____ T _____ R _____	_____
3. Miscellaneous Property in Sec.	S _____ T _____ R _____	_____
	S _____ T _____ R _____	_____

RECORDED

95 NOV 29 PM 1:37

D. J. ...
REGISTER OF DEEDS
OTTAWA COUNTY, MI

Register of Deeds Stamp & File Number

4. Lot No. _____, Recorded Plat _____
5. Private Claims _____

A	B	C	D	E	F	G	H	I	J	K	L	M
2	6	5	4	3	2	1						
3												
4	7	8	9	10	11	12						
5												
6	16	17	16	15	14	13						
7												
8	19	20	21	22	23	24						
9												
10	30	29	28	27	26	25						
11												
12	31	32	33	34	35	36						
13												

I, Maurice J. Rosema, in a field survey on Sept. 8, 1995,
do hereby certify that under requirements of P.A. 74, Michigan P.A. of 1970, the corner points mentioned
in lines 1 and 2 above were in conformance with regulations and rules therefore as required in the
current manual of survey instructions of the United States Department of the Interior, Bureau of Land
Management or by a decree of a Court of Law and/or that the corner points mentioned in lines 3, 4 and 5
above were in conformance with the rules of the Michigan Board of Land Surveyors or by a Decree of a
Court of Law; established, re-established, monumented, re-monumented, recovered, found as
expressed below:

**NOTE: Not more than 4 corners, all in the same town and range, may be recorded
on this certificate.**

A. Description of original monument and accessories and/or subsequent restoration:

M-7	GLO - 1837 (John Mullett D.S.)	L.C.R.C. recorded in Liber	L.C.R.C. recorded in Liber
18" Beech	S12 $\frac{1}{2}$ °W 52 lks	3, Page 361 - July 3, 1979	4, page 289 - Jan. 5, 1982
24" Beech	N66°W 37 lks	T-iron	C.I. Monument
		T-iron	Fc post
		W 33.00'	W 36.61'
		Fc post	SE 25.09'
		S80°W 35.2'	40" Maple
		S30°E 93.55'	P pole
		S 10.5'	SSE 93.42'
			SW cor hse
			SE 97.92'
			Tallmadge cor
			S 10.53'

B. Description of corner evidence found and/or method applied in restoring or reestablishing corner:

M-7
Found C.I. Monument
Found T-iron
Found nail in N side 48" Maple
Found C.I. Monument

P.A. 345 OTTAWA COUNTY

N82°W 32.96' PEER APPROVED 11/20/95
S77°E 25.08'
S 10.53'

MJR

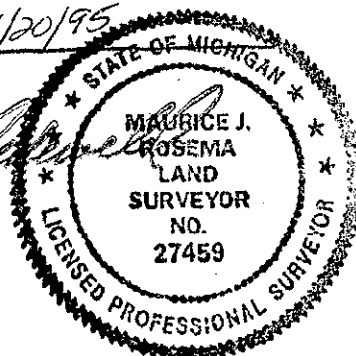

I hereby accept this corner as a correct and accurate
perpetuation of the position of the original corner.

C. Description of monument for corner and accessories established to perpetuate locating the position of the corner:

M-7
C.I. Monument
Set nail and Ottawa County remon. tag in N side 48" Maple
Set nail and Ottawa County remon. tag in W side P pole
C.I. Monument
T-iron
Set nail and Ottawa County remon. tag in S side wood fc post
c/l N-S gravel road

S77°E 25.08'
S15°E 93.73'
S0°E 10.53'
N82°W 32.96'
N83°W 36.85'
W 4'

Signed by *Maurice J. Rosema* Date October 21, 1995
Surveyor's Michigan License No. 27459