

Ottawa County remonumentation
 LAND CORNER RECORDATION CERTIFICATE
 Filing Requirement of Act 74, Mich. P.A. 1970

RECORDED

93 DEC 15 AM 9:23

D. J. ...
 REGISTER OF DEEDS
 OTTAWA COUNTY, MI

SURVEY &
 REMONUMENTATION

DEC 05 2000

SECTION
 Register of Deeds Stamp & File Number

For corners in

Ottawa (County)	Located In:	Corner Code #
1. Public Land Survey	T <u>7N</u> R <u>14W</u>	<u>M-12</u>
	T _____ R _____	_____
	T _____ R _____	_____
	T _____ R _____	_____
2. Property Controlling in Section	S _____ T _____ R _____	_____
	S _____ T _____ R _____	_____
3. Miscellaneous Property in Sec.	S _____ T _____ R _____	_____
	S _____ T _____ R _____	_____

4. Lot No. _____, Recorded Plat _____
 5. Private Claims _____

I, Maurice J. Rosema in a field survey on July 31, 19 93, do hereby certify that under requirements of P.A. 74, Michigan P.A. of 1970, the corner points mentioned in lines 1 and 2 above were in conformance with regulations and rules therefore as required in the current manual of survey instructions of the United States Department of the Interior, Bureau of Land Management or by a decree of a Court of Law and/or that the corner points mentioned in lines 3, 4 and 5 above were in conformance with the rules of the Michigan Board of Land Surveyors or by a Decree of a Court of Law; established, re-established, monumented, re-monumented, recovered, found as expressed below:

NOTE: Not more than 4 corners, all in the same town and range, may be recorded on this certificate.

A. Description of original monument and accessories and/or subsequent restoration:

M-12 Clapp - 1972 per L.C.R.C.
 recorded in Liber 6, Page 163
 "T" iron in mon. box
 Section corner - S. 49.86'
 Street sign - SE. 38.15'
 P. pole - SW. 194.70'
 iron on shoulder - NW. 54.10'

Clapp - 1972 per L.C.R.C.
 recorded in Liber 1, Page 797
 "T" iron
 P.K. (Georgetown corner) - S. 49.93'
 T. pole - SE. 45.95'
 28" Oak - NW. 109.30'
 center of street sign - SW. 50.69'

MVK - 1974 per L.C.R.C.
 recorded in Liber 2, Page 477
 "T" iron
 P.K. in N. side T. pole - ESE. 46.44'
 Spk. in W. side 30" Oak - NNW. 110.50'
 Iron - S. 49.87'

B. Description of corner evidence found and/or method applied in restoring or reestablishing corner:

M-12 Found C.I. monument in monument box
 Georgetown corner (C.I. monument in monument box) - S00°E 49.86'
 Center of street sign - S60°E 38.15'
 Found re-rod on gravel shoulder of road - N23°W 54.10'

I hereby accept this corner as a correct and accurate perpetuation of the position of the original section corner.

C. Description of monument for corner and accessories established to perpetuate locating the position of the corner:

M-12 C.I. monument in monument box
 Set nail and O.C. remon. tag in top of tele. box post - S29°E 84.75'
 Set nail and O.C. remon. tag in E. side P. pole - S14°W 194.64'
 Set nail and O.C. remon. tag in top of split-rail fence post - S85°W 53.35'
 Georgetown corner (C.I. monument in monument box) - S00°E 49.86'
 Center of street sign - S60°E 38.15'
 Centerline of gravel road to East - S 47'
 Centerline of N-S bit. conc. road - W 2'

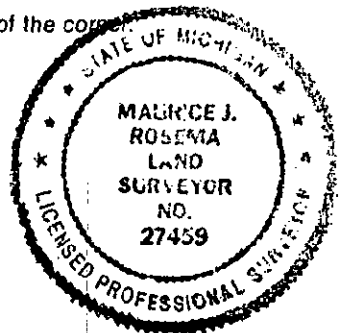

Signed by Maurice J. Rosema
 Surveyor's Michigan License No. 27459

Date October 02, 1993

FORM APPROVED BY MICHIGAN STATE BOARD OF LAND SURVEYORS, JAN. 28, 1971
 REVISED MAY 14, 1975
 REVISED JAN., 1983