

SURVEY & REMONUMENTATION

DEC 01 1998

SECTION

**OTTAWA COUNTY REMONUMENTATION
LAND CORNER RECORDATION CERTIFICATE
Filing Requirement of Act 74, Mich. P.A. 1970**

For corners in

<u>Ottawa</u> <small>(County)</small>	Located In:	Corner Code #
1. Public Land Survey	T <u>7</u> N R <u>16</u> W	L-1
	T _____ R _____	_____
	T _____ R _____	_____
	T _____ R _____	_____
2. Property Controlling in Section	S _____ T _____ R _____	North 1/4 corner
	S _____ T _____ R _____	Section 1
3. Miscellaneous Property in Sec.	S _____ T _____ R _____	Spring Lake Twp
	S _____ T _____ R _____	_____

RECORDED

98 JUL 24 PM 1:45

Greg Subella
REGISTER OF DEEDS
OTTAWA COUNTY, MI

Register of Deeds Stamp & File Number

4. Lot No. _____, Recorded Plat _____
5. Private Claims _____

	A	B	C	D	E	F	G	H	I	J	K	L	M
1													
2	6	5	4	3	2	1							
3													
4	7	8	9	10	11	12							
5													
6	18	17	16	15	14	13							
7													
8	19	20	21	22	23	24							
9													
10	30	29	28	27	26	25							
11													
12	31	32	33	34	35	36							
13													

I, Steve Lampen, in a field survey on June 4 1998, do hereby certify that under requirements of P.A. 74, Michigan P.A. of 1970, the corner points mentioned in lines 1 and 2 above were in conformance with regulations and rules therefore as required in the current manual of survey instructions of the United States Department of the Interior, Bureau of Land Management or by a decree of a Court of Law and/or that the corner points mentioned in lines 3, 4 and 5 above were in conformance with the rules of the Michigan Board of Land Surveyors or by a Decree of a Court of Law; established, re-established, monumented, re-monumented, recovered, found as expressed below:

NOTE: Not more than 4 corners, all in the same town and range, may be recorded on this certificate.

A. Description of original monument and accessories and/or subsequent restoration:

L-1
GLO - not monumented by the original GLO survey. GLO-Mullett - 1837 West on South side of Section 36, T8N, R16W L-1 is shown on Borck's Supervisor's Plat No. 1 1930.
GLO-Britain - 1832 East on South side of Section 36, T8N, R16W 40.00 set QR Sec. post 45.40 to Grand River and set post 23.50 to Grand River and set meander post. 54.50 over River to old post on left bank.

PA. 345 OTTAWA COUNTY

PLAT APPROVED

6-15-98

SD

B. Description of corner evidence found and/or method applied in restoring or reestablishing corner:

L-1
L-1 was not monumented by the original GLO survey. Did not find monumentation at L-1 from Borck's Supervisor's Plat No. 1.
Re-established the North and South position of the GLO MP position on the West side of the Grand River by measuring the Platted distance of 343.00 ft North of a found concrete monument on the East line of Lot 17, Block 2 of Borok's Supervisor's Plat No. 1, at the extension of the South line of Lake Avenue.
Re-established the East and West position of the GLO MP by proportionate measure between K-1 and M-1.
Established L-1 on the section line between the GLO MP and M-1 and mid-way between K-1 and M-1.
Set an Ottawa County Remonumentation iron and cap at L-1 and is accepted as the best position of the corner.
See sketch on back.

C. Description of monument for corner and accessories established to perpetuate locating the position of the corner:

L-1 Ottawa County Remonumentation iron and cap
Azimuth = Michigan State Plane Grid Direction
Remonumentation tag in North side 10" Poplar 240° 45' 233.25
Remonumentation tag in North 16" Willow 293° 32' 458.15
Remonumentation tag in South Twin 20" Maple 300° 57' 644.60
Remonumentation tag in Southeast 12" Poplar 309° 43' 929.18
L-13 T8N, R16W 270° 46' 67.62

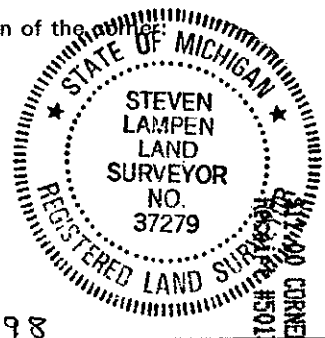

Signed by Steven Lampen
Surveyor's Michigan License No. 37279

Date JULY 20, 1998

FORM APPROVED BY MICHIGAN STATE BOARD OF LAND SURVEYORS, JAN. 28, 1971

REVISED MAY 14, 1975
REVISED JAN., 1983
ADAPTED FOR WORD PROCESSING MARCH, 1993

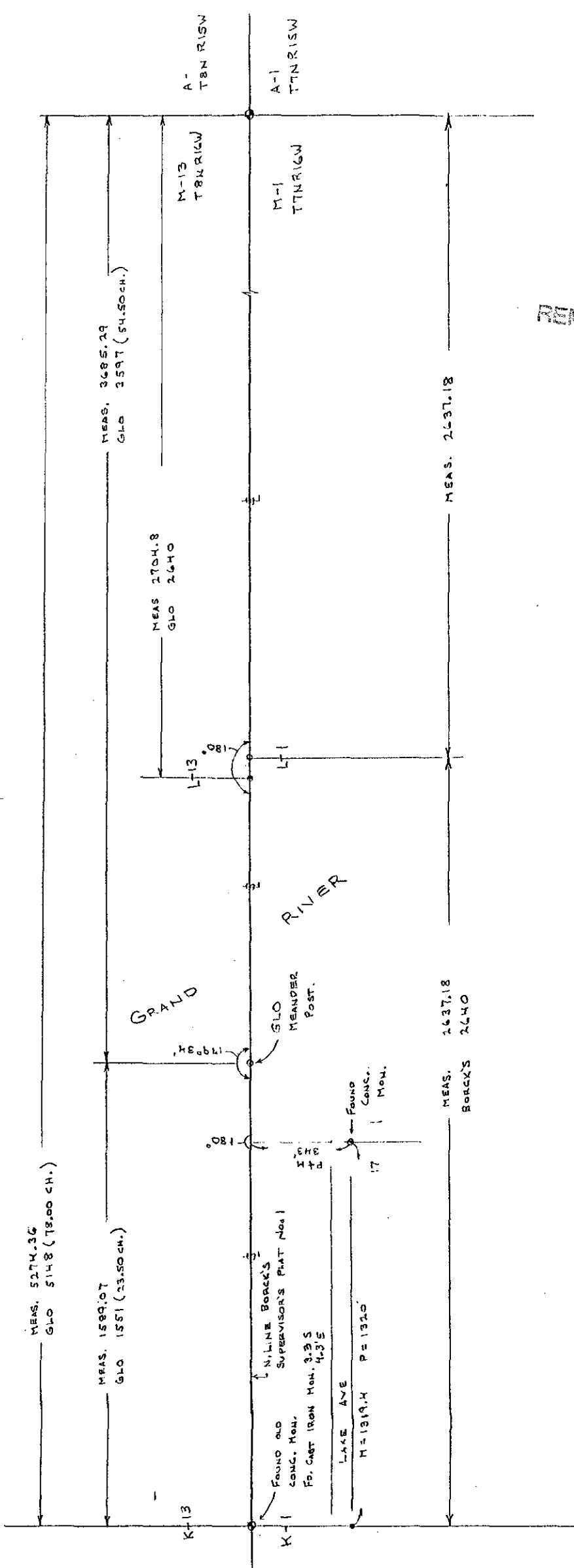

SURVEY &
REMONUMENTATION

DEC 01 1998

SECTION