

SURVEY & REMONUMENTATION

JUN 28 1999

OTTAWA COUNTY REMONUMENTATION

RECORDED

99 NOV -4 PM 2: 32

SECTION

LAND CORNER RECORDATION CERTIFICATE
Filing Requirement of Act 74, Mich. P.A. 1970

Randy H. Vugteveen
REGISTER OF DEEDS
OTTAWA COUNTY, MI

For corners in
OTTAWA

(County)

Located in: Corner Code #
T 8N R 13W C-1 NE Cor Sec 6
T R Wright Twp
T R
T R
T R
S T R
S T R
S T R
S T R

1. Public Land Survey

2. Property Controlling in Section

3. Miscellaneous Property in Sec.

4. Lot No. _____, Recorded Plat _____
5. Private Claims _____

Register of Deeds Stamp & File Number

A	B	C	D	E	F	G	H	I	J	K	L	M
1												
2	6	5	4	3	2	1						
3												
4	7	8	9	10	11	12						
5												
6	10	17	16	15	14	13						
7												
8	19	20	21	22	23	24						
9												
10	30	29	28	27	26	25						
11												
12	31	32	33	34	35	36						
13												

I, Randal J. Vugteveen, in a field survey on September 29, 1998 do hereby state that under requirements of P.A. 74, Michigan P.A. of 1970, the corner points mentioned in lines 1 and 2 above were in conformance with regulations and rules therefore as required in the current manual of survey instructions of the United States Department of the Interior, Bureau of Land Management or by a decree of a Court of Law and/or that the corner points mentioned in lines 3, 4 and 5 above were in conformance with the rules of the Michigan Board of Land Surveyors or by a Decree of a Court of Law; established, re-established, monumented, recovered, found as expressed below:

NOTE: Not more than 2 corners, all in the same town and range, may be recorded on this certificate.

A. Description of original monument and accessories and/or subsequent restoration:

C-1
Set Post 79 links
East of Post
18" Sugar S7°E 38 Links
7" Ironwood S5°W 13 Links

Liber 3 Page 66
Clapp Jan 1976
Set Cast Iron Monument
Fence Post N 28.90'
14" Hickory SSW 97.55'
Centerline of Street Sign SW 59.55'
Telephone Pole WSW 70.71'
Chester Cor W 52.14'

Liber 6 Page 100 Joiner Oct 1990
C-1 Found Cast Iron Monument
Telephone Pole SW 70.65'
Post N 28.85'
18" Hickory SW 97.45'
Chester Cor W 52.02'

B. Description of corner evidence found and/or method applied in restoring or reestablishing corner:

C-1
Found Cast Iron Monument in Monument Box
Found Nail West side post N5°W 28.85'
Found Cast Iron Monument in Monument Box at Chester Corner W 52.03'
Found Nail SE Side Power Pole S67°W 70.56'

Accepted Cast Iron Monument as a careful and faithful perpetuation of the position of the original corner.

C. Description of monument for corner and accessories established to perpetuate locating the position of the corner:

C-1
Cast Iron Monument in Monument Box 0.21' North of Town Line, Witnesses to Monument
Set Remon Tag and Nail West side fence post N5°W 28.85'
Set Remon Tag and Nail SE side Power Pole S67°W 70.56'
Set Remon Tag and Nail top of East end 14" CMP S5°E 148.85'
Set Remon Tag and Nail North side Cherry Clump S85°E 265.14'
Found Cast Iron Monument in Monument Box at Chester Corner West 52.03'
Centerline "X" West 27'

Signed by *Randal J. Vugteveen*
Surveyor's Michigan License No. 28429

Date October 19, 1998

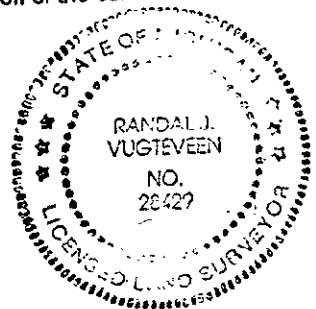

411.00 CORNER
Receipt #18213
\$2.00 PHOTO
Receipt #18213

SURVEY &
REMONUMENTATION

JUN 28 1999

SECTION

CHESTER TWP

WRIGHT TWP

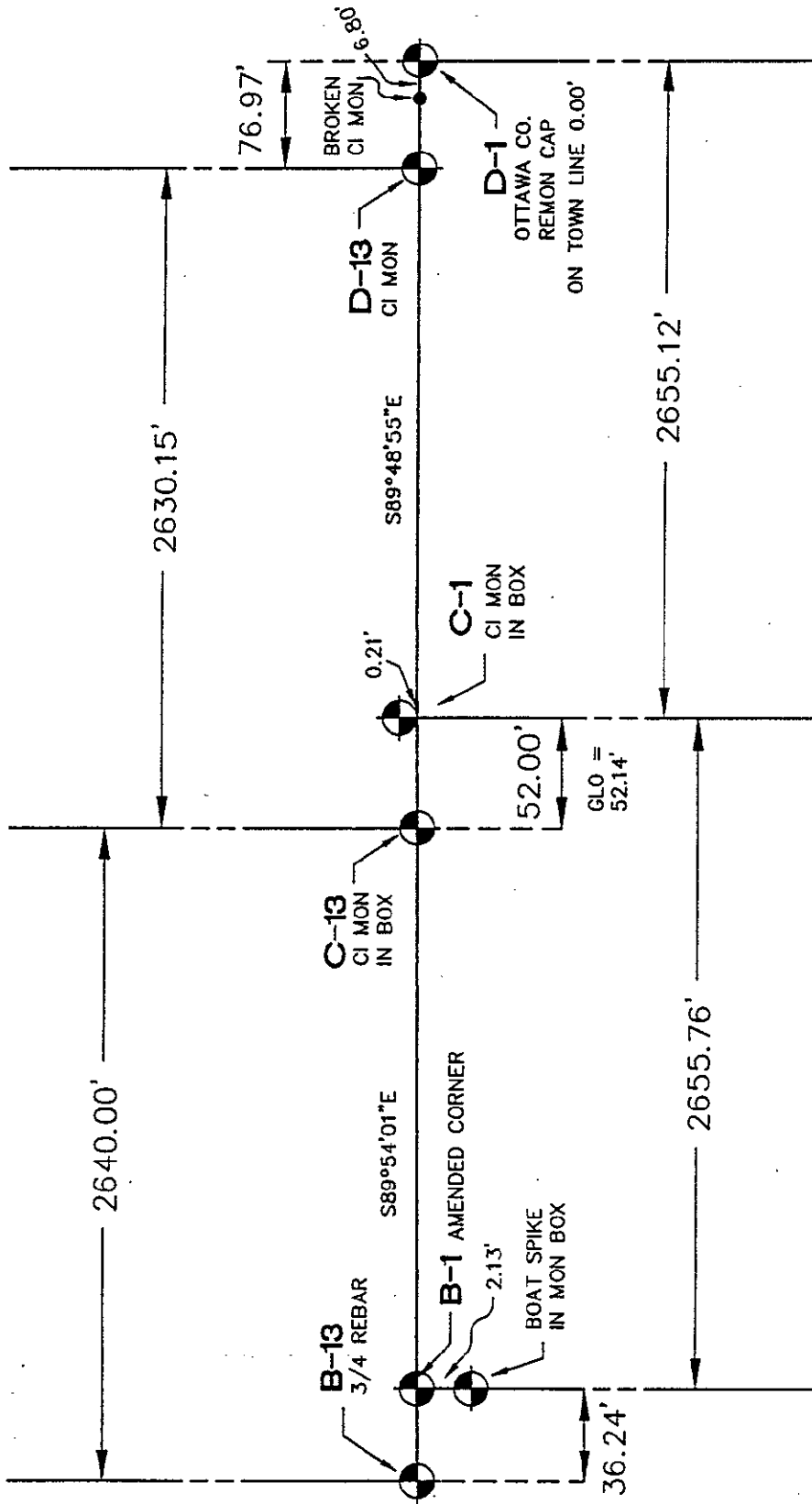

NO SCALE

By *Randal J. Vugteveen*
Randal J. Vugteveen Licensed Professional Surveyor No. 28429

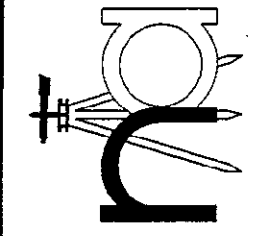

nederveld associates, inc.
engineering • surveying
Grand Rapids Location, Ph. (616) 669-5190 Fax 669-6699
P.O. Box 10, 5570 32nd Avenue, Hudsonville, Michigan 49426
Holland Location, Ph. (616) 393-0449 Fax 392-3540
575 E. 16th Street, Holland, Michigan 49423
Norton Shores Location, Ph. (616) 733-4114 Fax 733-5303
374 Seminole Road, Norton Shores, Michigan 49444
File No. 980002 Date: 10-9-98 by CM

Scale 1" =
D = Description dimension
M = Measured dimension
P = Platted dimension
• = Set Iron stake
O = Found Iron stake
— X — Fence Line