

SURVEY & REMONUMENTATION

APR 05 1996 **OTTAWA COUNTY REMONUMENTATION**
LAND CORNER RECORDATION CERTIFICATE
COMMISSION Filing Requirement of Act 74, Mich. P.A. 1970

For corners in
Ottawa (County)
 Located In: _____ Corner Code # _____

1. Public Land Survey T8N R14W K-13
 T _____ R _____ SW cor. Sec. 36,
 T _____ R _____ Polkton Twp.
 T _____ R _____

2. Property Controlling S _____ T _____
 in Section S _____ T _____
 3. Miscellaneous S _____ T _____
 Property in Sec. S _____ T _____ R _____

4. Lot No. _____, Recorded Plat _____
 5. Private Claims _____

RECORDED
 95 DEC 12 AM 11:51
Richard L. Williams
 REGISTER OF DEEDS
 OTTAWA COUNTY, MI
Register of Deeds Stamp & File Number

I, Steven Lampen, in a field survey on November 15, 1995, do hereby certify that under requirements of P.A. 74, Michigan P.A. of 1970, the corner points mentioned in lines 1 and 2 above were in conformance with regulations and rules therefore as required in the current manual of survey instructions of the United States Department of the Interior, Bureau of Land Management or by a decree of a Court of Law and/or that the corner points mentioned in lines 3, 4 and 5 above were in conformance with the rules of the Michigan Board of Land Surveyors or by a Decree of a Court of Law; established, re-established, monumented, re-monumented, recovered, found as expressed below:

1	A	B	C	D	E	F	G	H	I	J	K	L	M
2	6	5	4	3	2	1							
3													
4	7	8	9	10	11	12							
5													
6	18	17	16	15	14	13							
7													
8	19	20	21	22	23	24							
9													
10	30	29	28	27	26	25							
11													
12	31	32	33	34	35	36							
13													

NOTE: Not more than 4 corners, all in the same town and range, may be recorded on this certificate.

- A. Description of original monument and accessories and/or subsequent restoration:
 K-13
 GLO Survey Notes 1837, Surveyor - John Mullett Set post
 8" Beech N 48° E 8 links
 12" Maple N 33° W 40 links
- No LCRC recorded
 Old Records of JK & A
 Found steel bar used by Englert in 1973
 9" Maple N 2.90'
 13" Maple NW 14.35'
 10" Maple S 5.0'

Survey in L 8-P 192
 Found cast iron mon.
 10" Cherry N 49° E 15.44'
 15" Maple N 80° E 24.16'
 15" Maple S 42° E 24.70'
 10" Maple S 30° W 5.21'

See page 2

- B. Description of corner evidence found and/or method applied in restoring or reestablishing corner:
 K-13

P.A. 345 OTTAWA COUNTY
PEER APPROVED 11/20/95

Stephen P. Lampen

Found cast iron monument
 11" Maple AZ 0° 3'±
 15" Maple AZ 180° 5'±
 Nail & tag R.L.S. #14091 N face 18" Maple AZ 144° 24.67'
 Nail & tag R.L.S. #14091 S face 16" Maple AZ 80° 24.09'
 Face of 14" Maple AZ 306° 14.5'±
 E-W fence line to W
 N-S fence line to N

Accepted cast iron monument as a careful and faithful perpetuation of the position of the original corner.

- C. Description of monument for corner and accessories established to perpetuate locating the position of the corner:
 K-13

Cast iron monument
 O. C. Remonumentation tag & nail E face 24" Maple AZ 350 32.27'
 O. C. Remon. tag & nail N face 18" Maple AZ 144° 25.27'
 O. C. Remon. tag & nail S face 16" Maple AZ 80° 24.95'
 O. C. Remon. tag & nail E face 15" Maple AZ 180° 4.74'

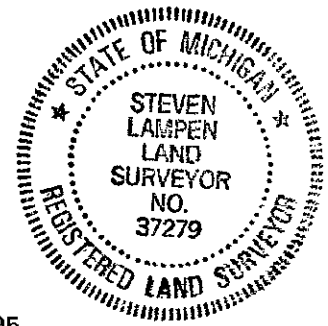

Signed by Steven Lampen Date November 17, 1995
 Surveyor's Michigan License No. 37279

FORM APPROVED BY MICHIGAN STATE BOARD OF LAND SURVEYORS, JAN. 28, 1971
 REVISED MAY 14, 1976
 REVISED JAN., 1983
 ADAPTED FOR WORD PROCESSING MARCH, 1983

A. Cont'd

K-13 (Recorded as K-1, T7N, R14W)
LCRC I 2-P 61
August 6, 1973
5/8" rod in fence corner
9" Maple N 2.90'
13" Maple NW 14.35'
10" Maple S 5.00'

K-13 (Recorded as K-1, T7N, R14W)
LCRC L 4-P 48
April 14, 1980
Found iron, set cast iron mon.
9" Maple N 2.90'
13" Maple NW 14.45'
14" Maple ENE 24.18'
14" Maple SE 24.75'

\$ 11.00 CORNER