

FEB 24 2000

OTTAWA COUNTY REMONUMENTATION
LAND CORNER RECORDATION CERTIFICATE
Filing Requirement of Act 74, Mich. P.A. 1970

RECORDED
99 SEP 23 PM 3: 21

For corners in SECTION

Dan Sullivan
REGISTER OF DEEDS
OTTAWA COUNTY, MI

<u>Ottawa</u> (County)	Located In:	Corner Code #
	Crockery Township	
1. Public Land Survey	T <u>8</u> N R <u>15</u> W	F-1
	T ___ R ___	North 1/4
	T ___ R ___	Corner
	T ___ R ___	Section 4
2. Property Controlling in Section	S ___ T ___ R ___	___
	S ___ T ___ R ___	___
3. Miscellaneous Property in Sec.	S ___ T ___ R ___	___
	S ___ T ___ R ___	___

Register of Deeds Stamp & File Number

4. Lot No. _____, Recorded Plat _____
5. Private Claims _____

I, Carl P. Englert, in a field survey on 5/28, 19 99 do hereby state that under requirements of P.A. 74, Michigan P.A. of 1970, the corner points mentioned in lines 1 and 2 above were in conformance with regulations and rules therefore as required in the current manual of survey instructions of the United States Department of the Interior, Bureau of Land Management or by a decree of a Court of Law and/or that the corner points mentioned in lines 3, 4 and 5 above were in conformance with the rules of the Michigan Board of Land Surveyors or by a Decree of a Court of Law; established, re-established, monumented, recovered, found as expressed below.

NOTE: Not more than 2 corners, all in the same town and range, may be recorded on this certificate.

	A	B	C	D	E	F	G	H	I	J	K	L	M
1													
2	6		5		4		3		2		1		
3													
4	7		8		9		10		11		12		
5													
6	18		17		16		15		14		13		
7													
8	19		20		21		22		23		24		
9													
10	30		29		28		27		26		25		
11													
12	31		32		33		34		35		36		
13													

A. Description of original monument and accessories and/or subsequent restoration:

F-1 No Corner Set, F-13, T9N, R15W Set by Mullett, 1837, Common to F-1, T8N, R15W
Set 1/4 Section Post
Beech 13" N89°E 37 Links
Beech 15" N45°W 22 Links

Muskegon County Tie Book
1/2" Iron
NW 70.58' SW Cor. Hse.
S 32.75' Fence Post
SW T.P. 40.90'
N 33.86' 10" Pine
NW 59.05' SW Cor. Fr. Hse.

See Other Side

B. Description of corner evidence found and/or method applied in restoring or reestablishing corner:

F-1 Found Cast Iron Monument in Monument Box in Road Centerline on Occupation Lines North and South (Monument has Broken Top)
Found 15" Pine North 33.86'
Found 34" Maple NW 59.23'± (No Nail)
Found 10" Red Pine N 60°E 61.04'

Accepted as a careful and faithful perpetuation of the original position of the corner

C. Description of monument for corner and accessories established to perpetuate locating the position of the corner:

F-1 4" Harrison Cast Iron Monument in Monument Box
O.C. Remon Tag and Nail in W Side 15" Pine N 4°W 33.70'
O.C. Remon Tag and Nail in S Side 10" Pine N60°E 60.84'
O.C. Remon Tag and Nail in NW Side Tele. Pole S48°W 42.26'
O.C. Remon Tag and Nail in SW Side 34" Maple N57°W 59.10'

8/16/99
YDZ

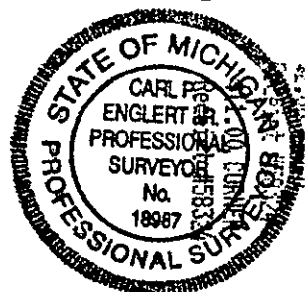

Signed by Carl P. Englert
Surveyor's Michigan License No. 18987

Date 8/13/1999

FEB 24 2000

SECTION

F-1, T8N, R15W

LCRC Liber 1134, Page 261, Muskegon County Records
 Mr. Schiele, April, 1978 recorded as F-13, T9N, R15W
 Found 1/2" Steel Bar in Mon. Box
 Fence Post South 32.71'
 10" Pine North 33.86'
 Tel. Pole SW 40.90'
 SW Cor. House NW 70.58'
 SE Cor. House NW 59.05'

LCRC Liber 5, Page 47 Mr. Joiner, May, 1983
 Found Iron Bar in Mon. Box, Set C.I.M.
 Tele. Pole SW 40.70'
 11" Pine N 34.00'
 26" Maple NW 59.23'
 9" Maple WNW 80.65'

LCRC Liber 1810, Page 43, Muskegon County Remon. Records,
 Mr. Vallier, December, 1994, recorded as F-13, T9N, R13W
 Found Cast Iron Monument with County Survey Cap in Mon.
 Box (Also E-1, T8N, R15W)
 S50°W 42.30' Nail W. Side 6" Aspen
 S12°W 48.66' Nail N. Side P.Pole
 N 33.97' Nail W. Side 12" Red Pine
 N52°W 59.23' Nail S. Side 28" Maple
 N15°W 58.86' SE Corner House No. 6000
 N65°E 61.04' Nail S. Side 8" Red Pine

T9N, R15W

Sec. 33

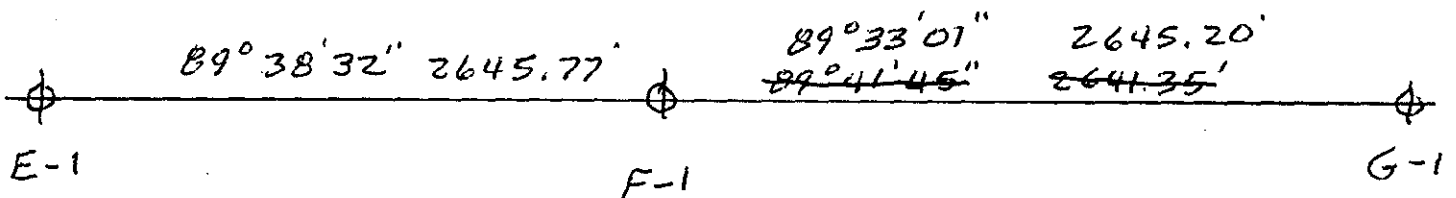

Sec 4

T8N, R15W

