

OTTAWA COUNTY REMONUMENTATION

RECORDED

LAND CORNER RECORDATION CERTIFICATE
Filing Requirement of Act 74, Mich. P.A. 1970

93 DEC 15 AM 9:31

For corners in

Ottawa

(County)

Located in:

Corner Code #

Crockery Township

- 1. Public Land Survey
T 8N R 15W K-9
T ___ R ___ SW Corner
T ___ R ___ Section 24
T ___ R ___
- 2. Property Controlling
in Section S ___ T ___ R ___
S ___ T ___ R ___
- 3. Miscellaneous
Property in Sec. S ___ T ___ R ___
S ___ T ___ R ___

Richard Williams
REGISTER OF DEEDS
OTTAWA COUNTY, MI

SURVEY &
REMONUMENTATION

DEC 05 2000

Register of Deeds, Stamp & File Number

- 4. Lot No. _____, Recorded Plat _____
- 5. Private Claims _____

Carl P. Englert Jr.

I, _____, in a field survey on July 9, 19 93, do hereby certify that under requirements of P.A. 74, Michigan P.A. of 1970, the corner points mentioned in lines 1 and 2 above were in conformance with regulations and rules therefore as required in the current manual of survey instructions of the United States Department of the Interior, Bureau of Land Management or by a decree of a Court of Law and/or that the corner points mentioned in lines 3, 4 and 5 above were in conformance with the rules of the Michigan Board of Land Surveyors or by a Decree of a Court of Law; established, re-established, monumented, re-monumented, recovered, found as expressed below:

	A	B	C	D	E	F	G	H	I	J	K	L	M
2	6	5	4	3	2								
3													
4	7	8	9	10	11	12							
5													
6	18	17	16	15	14	13							
7													
8	19	20	21	22	23	24							
9													
10	30	29	28	27	26	25							
11													
12	31	32	33	34	35	36							
13													

NOTE: Not more than 4 corners, all in the same town and range, may be recorded on this certificate.

A. Description of original monument and accessories and/or subsequent restoration:

- I-9 L.C.R.C. Liber 5, Page 177, 12/27/84
Fd. 1/2" Bar & 1" pipe, Set C.I.M.
44" Oak E 48.28'
22" Basswood SW 36.22'
P.P. WNW 53.83'
16" Pine NNW 63.92'
- L.C.R.C. Liber 6, Page 243, 1/25/93
Fd. C.I.M. Top broken off.
N 20 degrees W 63.81' 14" White Pine
N 77 degrees W 53.85' P.P.
S 09 degrees E 121.00' 54" Oak
S 17 degrees W 111.77' 38" Basswood

B. Description of corner evidence found and/or method applied in restoring or reestablishing corner:

- K-9 Found 4" Harrison Mon. with top broken off and accepted as a careful and faithful perpetuation of the position of the original corner.
- N 20 degrees W 63.81' 14" White Pine
S 09 degrees E 121.00' 54" Oak
S 17 degrees W 111.77' 35" Basswood
N 77 degrees W 53.85' P.P.
East 44" Oak 48.28'

C. Description of monument for corner and accessories established to perpetuate locating the position of the corner:

- K-9 Replaced broken Harrison Mon. with 3' long 3/4" Iron Bar with O.C. Remon. Cap
O.C. Remon. Tag & Nail in S side 45" Oak S 89 degrees E 48.77'
O.C. Remon. Tag & Nail in W side 54" Oak S 10 degrees E 120.99'
O.C. Remon. Tag & Nail in E side 36" Basswood S 12 degrees W 111.75'
O.C. Remon. Tag & Nail in N side P.P. N 80 degrees W 53.77'
O.C. Remon. Tag & Nail in NW side 16" White Pine N 23 degrees 63.70'
(E.D.M.)

Signed by Carl P. Englert Jr.
Surveyor's Michigan License No. 18987

Date November 3, 1993

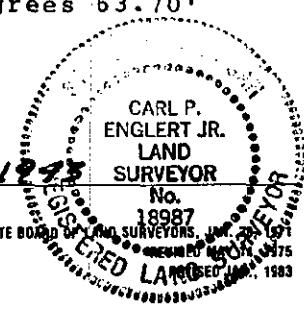

FORM APPROVED BY MICHIGAN STATE BOARD OF LAND SURVEYORS, 1975