

FEB 24 2000

RECORDED

OTTAWA COUNTY REMONUMENTATION 99 SEP 23 PM 3: 21  
LAND CORNER RECORDATION CERTIFICATE  
Filing Requirement of Act 74, Mich. P.A. 1970

SECTION

For corners in

<u>Ottawa</u> (County)	Located In:	Corner Code #
	Crockery Township	
1. Public Land Survey	T <u>8N</u> R <u>15W</u>	L-1
	T ___ R ___	N <u>1/4</u> corner
	T ___ R ___	Section ]
	T ___ R ___	
2. Property Controlling in Section	S ___ T ___ R ___	
	S ___ T ___ R ___	
3. Miscellaneous Property in Sec.	S ___ T ___ R ___	
	S ___ T ___ R ___	

*Sam Whittell*  
REGISTER OF DEEDS  
OTTAWA COUNTY, MI

Register of Deeds Stamp & File Number

4. Lot No. \_\_\_\_\_, Recorded Plat \_\_\_\_\_  
5. Private Claims \_\_\_\_\_

I, Carl P. Englert, in a field survey on 5/28, 19 99 do hereby state that under requirements of P.A. 74, Michigan P.A. of 1970, the corner points mentioned in lines 1 and 2 above were in conformance with regulations and rules therefore as required in the current manual of survey instructions of the United States Department of the Interior, Bureau of Land Management or by a decree of a Court of Law and /or that the corner points mentioned in lines 3, 4 and 5 above were in conformance with the rules of the Michigan Board of Land Surveyors or by a Decree of a Court of Law; established, re-established, monumented, recovered, found as expressed below:

A	B	C	D	E	F	G	H	I	J	K	L
1											
2	6		5		4		3		2		1
3											
4	7		8		9		10		11		12
5											
6	18		17		16		15		14		13
7											
8	19		20		21		22		23		24
9											
10	30		29		28		27		26		25
11											
12	31		32		33		34		35		36
13											

NOTE: Not more than 2 corners, all in the same town and range, may be recorded on this certificate.

A. Description of original monument and accessories and/or subsequent restoration: has been held as  
 L-1 No corner set. L-13, T9N, R15W set by John Mullett 1837. A Common  
 to L-1, T8N, R15W  
 Set 1/4 Section Post  
 Hemlock 30" N81°E 28 Links  
 Beech 8" N17°W 18 Links  
 Liber 5, Page 71, Joiner P.S. 18435,  
 11/1983  
 Found 1/2" Rod & Stone in Fence Corner.  
 Set Cast Iron Monument  
 Fence Post S 10.47'  
 3" Ash N 7.00'  
 Tw. Ash NE 28.77' Fence Post E 8.63'

*see other side*

B. Description of corner evidence found and/or method applied in restoring or reestablishing corner:  
 L-1 Found 4" Cast Iron Monument in Fence Corner at Grade  
 Fence Runs East and South  
 Found Fence Post South 10.47'  
 Found Ash North 7.00'  
 Found Tw. Ash NE 28.77'  
 Found Fence Post East 8.63'

This Monument is accepted as the best available evidence of the position of the corner.

C. Description of monument for corner and accessories established to perpetuate locating the position of the corner:

L-1 4" Harrison Cast Iron Monument  
 O.C. Remon Tag and Nail in West Side 6" Ash S15°W 14.08'  
 O.C. Remon Tag and Nail in North Side 5" Ash S60°W 58.88'  
 O.C. Remon Tag and Nail in West Side 8" Ash North 7.01'  
 O.C. Remon Tag and Nail in South Side 4" Ash East 21.55'  
 L-1, T9N, R15W, held as common to L-13, T9N, R15W.

Signed by *Carl P. Englert*  
 Surveyor's Michigan License No. 18987

Date 8/30/1999

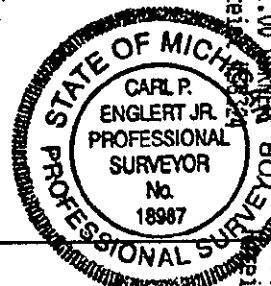

FEB 24 2000

SECTION

L-1, T8N, R15W

LCRC Liber 1297, Page 936, Muskegon County Records  
Recorded as L-13, T9N, R15W by Lewandoski in October, 1984  
Found 4" Cast Iron Monument  
North 4" Ash 7.03'  
N50°E 6" Cherry 17.91'  
N60°E 6" Tw. Ash 28.82'  
South Wood Post 10.55'

LCRC Liber 1810, Page 533, Muskegon County Records  
Recorded as L-13, T9N, R15W, Mr. Vallier December, 1994

Ties Same as above (Liber 1297, Page 936)

T9N, R15W

Sec 36

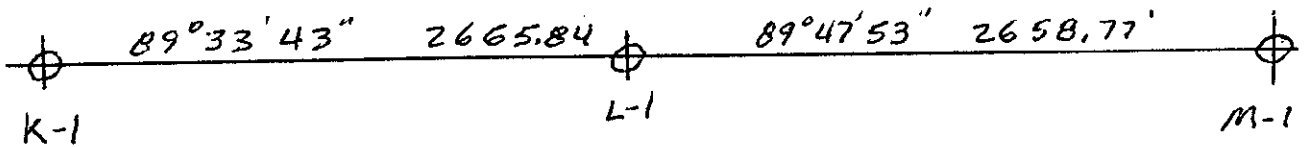

Sec. 1  
T8N, R15W