

FEB 24 2000

OTTAWA COUNTY REMONUMENTATION

RECORDED

99 JUL 30 PM 12: 26

LAND CORNER RECORDATION CERTIFICATE
Filing Requirement of Act 74, Mich. P.A. 1970

SECTION

For corners in
Ottawa

Randy Schellton
REGISTER OF DEEDS
OTTAWA COUNTY, MI

(County)	Located In:		Corner Code #
	Chester Twp.		
1. Public Land Survey	9N	13W	A-5 NW cor.
	T	R	Sec. 18
	T	R	
	T	R	
	T	R	
2. Property Controlling in Section	S	T	R
	S	T	R
3. Miscellaneous Property in Sec.	S	T	R
	S	T	R

Register of Deeds Stamp & File Number

4. Lot No. _____, Recorded Plat _____
5. Private Claims _____

Randal D. Feenstra March 22 99

I, _____, in a field survey on _____, 19____ do hereby state that under requirements of P.A. 74, Michigan P.A. of 1970, the corner points mentioned in lines 1 and 2 above were in conformance with regulations and rules therefore as required in the current manual of survey instructions of the United States Department of the Interior, Bureau of Land Management or by a decree of a Court of Law and /or that the corner points mentioned in lines 3, 4 and 5 above were in conformance with the rules of the Michigan Board of Land Surveyors or by a Decree of a Court of Law, established, re-established, monumented, recovered, found as expressed below:

NOTE: Not more than 2 corners, all in the same town and range, may be recorded on this certificate.

	A	B	C	D	E	F	G	H	I	J	K	L	M
1													
2	6		5		4		3		2		1		
3													
4	7		8		9		10		11		12		
5													
6	18		17		16		15		14		13		
7													
8	19		20		21		22		23		24		
9													
10	30		29		28		27		26		25		
11													
12	31		32		33		34		35		36		
13													

A. Description of original monument and accessories and/or subsequent restoration:

G.L.O. Sept. 17, 1838	L-4	P-236	1981 (Joiner)
Rasselus Whitcomb	Part B Found "T" Iron		Part C Set Cast Iron Monument
Set Post	40" Maple	NW 27.40	42" Maple NW 29.40'
10" Beech S83°W 6 Links	20" Maple	NE 36.4	22" Maple NE 38.19'
8" Sugar Maple N2°E 24 Links	26" Maple	SW 42.36	26" Maple SW 42.42
			St. Sign SE 42.65

(Continued on reverse side)

B. Description of corner evidence found and/or method applied in restoring or reestablishing corner:

A-5 Found: Broken Cast Iron Monument in Gravel
Nail in 24" Maple AZ 221°10' 43.61'
Nail in 40" Maple AZ 288°10' 29.33'

Accepted as a careful and faithful perpetuation of the position of the original corner.

C. Description of monument for corner and accessories established to perpetuate locating the position of the corner:

A-5 Broken Cast Iron Monument in gravel (See Sketch)
Set Ottawa County Remon Tag & Nail in SE side 27" Maple AZ 39°45' 37.88'
Set Ottawa County Remon Tag & Nail in NW side 24" Maple AZ 221°10' 43.61'
Set Ottawa County Remon Tag & Nail in S side 40" Maple AZ 288°10' 29.33'
St. Sign AZ 136°25' 41.66'

Centerline N-S gravel Rd. (Squires Rd.) West 2.0'
Centerline gravel road to E (Hoover Rd.) North 1.0'

P.A. 345 OTTAWA COUNTY
PEER APPROVED 7/12/99
RDF

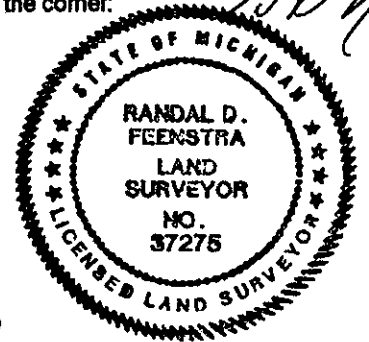

41.00 CORNER
Receipt #52389

Signed by *Randal D. Feenstra*
Surveyor's Michigan License No. 37275

Date May 14, 1999

Muskegon County Information

M-5: L-1301, P-605 1984 (Lewandoski)

Cast Iron Monument

24" Maple N40°E 38.16'
18" Maple S40°W 43.70'
36" Maple N70°W 29.40'

M-5: L-1118, P-937 1977 (Englert)

"T" Iron

24" Maple NE 38.16'
36" Maple NW 29.48'
St. Sign W 21.5'
26" Maple SW 42.28'

FEB 24 2000

SECTION

