

FEB 24 2000

RECORDED

99 JUL 30 PM 12: 26

OTTAWA COUNTY REMONUMENTATION
LAND CORNER RECORDATION CERTIFICATE
Filing Requirement of Act 74, Mich. P.A. 1970

Randy Schell
REGISTER OF DEEDS
OTTAWA COUNTY, MI

For corners in
Ottawa

SECTION

Located In:	Corner Code #
Chester Twp.	A-6 W 1/4 cor.
9N 13W	Sec. 18
T ___ R ___	_____
T ___ R ___	_____
T ___ R ___	_____
T ___ R ___	_____
S ___ T ___ R ___	_____
S ___ T ___ R ___	_____
S ___ T ___ R ___	_____
S ___ T ___ R ___	_____

Register of Deeds Stamp & File Number

1. Public Land Survey

2. Property Controlling in Section

3. Miscellaneous Property in Sec.

4. Lot No. _____, Recorded Plat _____
5. Private Claims _____

Randal D. Feenstra

March 22 99

I, _____, in a field survey on _____, 19____ do hereby state that under requirements of P.A. 74, Michigan P.A. of 1970, the corner points mentioned in lines 1 and 2 above were in conformance with regulations and rules therefore as required in the current manual of survey instructions of the United States Department of the Interior, Bureau of Land Management or by a decree of a Court of Law and /or that the corner points mentioned in lines 3, 4 and 5 above were in conformance with the rules of the Michigan Board of Land Surveyors or by a Decree of a Court of Law; established, re-established, monumented, recovered, found as expressed below:

NOTE: Not more than 2 corners, all in the same town and range, may be recorded on this certificate.

A	B	C	D	E	F	G	H	I	J	K	L	M
1												
2	6	5	4	3	2	1						
3												
4	7	8	9	10	11	12						
5												
6	18	17	16	15	14	13						
7												
8	19	20	21	22	23	24						
9												
10	30	29	28	27	26	25						
11												
12	31	32	33	34	35	36						
13												

A. Description of original monument and accessories and/or subsequent restoration:

G.L.O. not set	L-4 P-236 1981 (Joiner)	
Part B Iron pipe	Part C: Set Cast Iron Monument	
18" Maple NE 45.88	22" Maple ENE	26.02
22" Maple ENE 26.02	42" Maple SE	34.74
42" Maple SE 33.87	30" Maple NW	42.76
	6" Maple SW	38.78

Continued on other side

B. Description of corner evidence found and/or method applied in restoring or reestablishing corner:

A-6 Found: Broken Cast Iron Monument			
Nail in 20" Maple	AZ	35°50'	45.46'
Nail in 42" Maple	AZ	135°15'	34.52'
Nail in 28" Maple	AZ	326°25'	42.78'

PA. 345 OTTAWA COUNTY
PEER APPROVED 7/12/99
YDY

This position not established by original government surveyors. This location is accepted as the best available evidence of the position of the corner.

C. Description of monument for corner and accessories established to perpetuate locating the position of the corner:

A-6	Broken Cast Iron Monument		
Set	Ottawa County Remon Nail & Tag in SE side	20" Maple	AZ 35°50' 45.46'
Set	Ottawa County Remon Nail & Tag in SW side	42" Maple	AZ 135°15' 34.52'
Set	Ottawa County Remon Nail & Tag in SE side	10" Maple	AZ 222°10' 39.20'
Set	Ottawa County Remon Nail & Tag in E side	28" Maple	AZ 326°25' 42.78'
	On CL N-S Gravel Rd. (Squires Rd.)		
	On Fence Row to West		
	Ditch Line to East 4' North		

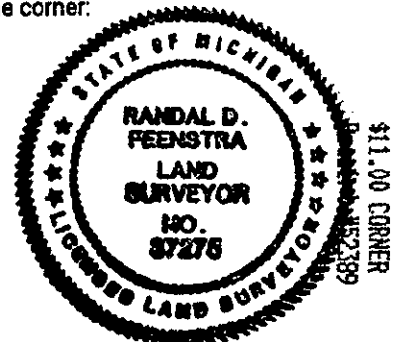

March 22, 1999

Signed by *Randal D. Feenstra*
Surveyor's Michigan License No. 37275

Date _____

Muskegon County Information

M-6 L-1301, P-605 1984 (Lewanoski)

Cast Iron Monument
 18" Maple N35°E 45.77'
 44" Maple S45°E 34.75'
 6" Maple S40°W 38.80'
 22" Maple N35°W 42.75'

M-6 L1118, P-937 1977 (Englert)

3/4" Pipe
 30" Maple NE 26.01'
 24" Maple NNE 45.84'
 30" Maple NW 42.80'
 36" Maple SE 34.70'
 4" Maple SW 38.80'

W. W. W. &
 P. P.

FEB 24 2000

SECTION

