

WILSON & REYNOLDS

RECORDED

FEB 24 2000 OTTAWA COUNTY REMONUMENTATION

99 JUL 30 PM 12: 26

LAND CORNER RECORDATION CERTIFICATE  
Filing Requirement of Act 74, Mich. P.A. 1970

SECTION

*Randy Schultz*  
REGISTER OF DEEDS  
OTTAWA COUNTY, MI

For corners in  
Ottawa

Located In:	Corner Code #
Chester Twp.	A-11 NW cor.
9N 13W	Sec. 31
T___ R___	_____
T___ R___	_____
T___ R___	_____
T___ R___	_____
S___ T___ R___	_____
S___ T___ R___	_____
S___ T___ R___	_____
S___ T___ R___	_____

1. Public Land Survey

2. Property Controlling  
in Section

3. Miscellaneous  
Property in Sec.

4. Lot No. \_\_\_\_\_, Recorded Plat \_\_\_\_\_  
5. Private Claims \_\_\_\_\_

Register of Deeds Stamp & File Number

Randal D. Feenstra

March 15 99

I, Randal D. Feenstra, in a field survey on March 15, 1999 do hereby state that under requirements of P.A. 74, Michigan P.A. of 1970, the corner points mentioned in lines 1 and 2 above were in conformance with regulations and rules therefore as required in the current manual of survey instructions of the United States Department of the Interior, Bureau of Land Management or by a decree of a Court of Law and/or that the corner points mentioned in lines 3, 4 and 5 above were in conformance with the rules of the Michigan Board of Land Surveyors or by a Decree of a Court of Law; established, re-established, monumented, recovered, found as expressed below:

NOTE: Not more than 2 corners, all in the same town and range, may be recorded on this certificate.

1	A	B	C	D	E	F	G	H	I	J	K	L	M
2	6	5	4	3	2	1							
3													
4	7	8	9	10	11	12							
5													
6	18	17	16	15	14	13							
7													
8	19	20	21	22	23	24							
9													
10	30	29	28	27	26	25							
11													
12	31	32	33	34	35	36							
13													

A. Description of original monument and accessories and/or subsequent restoration:

G.L.O. Sept. 17, 1838  
Rasselus Whitcomb  
Set Post  
6" Beech S44°E 9 Links  
8" Beech N47°E 31 Links

L-4 P-222 1981 (Joiner)  
Part B 1" Pipe  
16" Apple NW 77.18'  
P. Pole ESE 75.03'  
12" Apple WNW 79.86'  
St. Sign SW 41.30'

Part C Cast Iron Monument  
16" Apple NW 76.96  
16" Apple WNW 79.60  
St. Sign SW 41.40  
Tel. Pole ENE 82.04  
St. Sign NE 42.55

(Continued on other side)

B. Description of corner evidence found and/or method applied in restoring or reestablishing corner:

A-11 Found: Cast Iron Monument in Gravel  
Nail in P. Pole 68°45' 82.07'  
Nail in 14" Apple 294°10' 79.55'

Accepted as a careful and faithful perpetuation of the position of the original corner.

P.A. 845 OTTAWA COUNTY

PEER APPROVED 7/12/99

C. Description of monument for corner and accessories established to perpetuate locating the position of the corner:

A-11 Cast Iron Monument in gravel (See Sketch)			
Set Ottawa County Remon Tag & Nail in S side P. Pole	AZ 68°45'	82.07'	
Set Ottawa County Remon Tag & Nail in SW side P. Pole	AZ 144°0'	123.94'	
Set Ottawa County Remon Tag & Nail in S side 14" Apple	AZ 294°10'	79.55'	
Set Ottawa County Remon Tag & Nail in E side 16" Maple	AZ 327°50'	132.18'	

Centerline N-S gravel Rd. (48th Ave.) West 1.0'  
On centerline bituminous road to East (Harding St.)  
On centerline gravel road to West (Pontaluna Rd.)

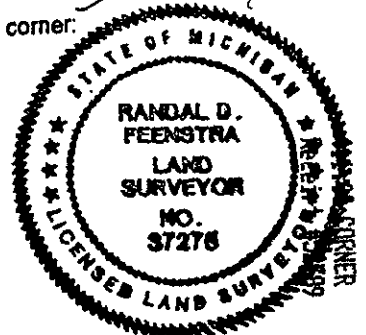

Signed by Randal D. Feenstra  
Surveyor's Michigan License No. 37276

Date May 14, 1999

FEB 24 2000

SECTION

Muskegon County Information

M-11: L-1242, P-323 1982 (Lewandoski)

Cast Iron Monument

P. Pole N70°E 82.12'  
16" Apple N21°W 76.90'  
12" Apple N64°W 79.55'  
P. Pole S35°E 124.00'

