

SURVEY & REMONUMENTATION

APR 05 1996

COMMISSION

**OTTAWA COUNTY REMONUMENTATION
LAND CORNER RECORDATION CERTIFICATE
Filing Requirement of Act 74, Mich. P.A. 1970**

For corners in

Ottawa (County)	Located In:	Corner Code #
1. Public Land Survey	Chester Twp. T <u>9N</u> R <u>13W</u>	B-3, N 1/4 cor.
	T _____ R _____	Sec. 7
	T _____ R _____	
	T _____ R _____	
2. Property Controlling in Section	S _____ T _____ R _____	
	S _____ T _____ R _____	
3. Miscellaneous Property in Sec.	S _____ T _____ R _____	
	S _____ T _____ R _____	

RECORDED

95 NOV 29 PM 1:36

Randy D. Feenstra
REGISTER OF DEEDS
OTTAWA COUNTY, MI

Register of Deeds Stamp & File Number

4. Lot No. _____, Recorded Plat _____
5. Private Claims _____

I, Randal D. Feenstra, in a field survey on November 6, 1995, do hereby certify that under requirements of P.A. 74, Michigan P.A. of 1970, the corner points mentioned in lines 1 and 2 above were in conformance with regulations and rules therefore as required in the current manual of survey instructions of the United States Department of the Interior, Bureau of Land Management or by a decree of a Court of Law and/or that the corner points mentioned in lines 3, 4 and 5 above were in conformance with the rules of the Michigan Board of Land Surveyors or by a Decree of a Court of Law, established, re-established, monumented, re-monumented, recovered, found as expressed below:

	A	B	C	D	E	F	G	H	I	J	K	L
2	6	5	4	3	2	1						
3	7	8	9	10	11	12						
4	19	17	16	15	14	13						
5	18	20	21	22	23	24						
6	30	29	28	27	26	25						
7	31	32	33	34	35	36						
8												
9												
10												
11												
12												
13												

NOTE: Not more than 4 corners, all in the same town and range, may be recorded on this certificate.

A. Description of original monument and accessories and/or subsequent restoration:

G.L.O. (1838)	L-5, P-271, (1987)
Rasselus Whitcomb	1/2" capped rod
10" Beech N85°E 41 lks.	Spike in 15" Willow N55°W 66.43'
12" Beech S62°W 44 lks	Spike in 8" Twin Elm S45°E 55.12'
	Utility Pedestal N10°W 41.4'
	C/L Pav't South 0.4'
	C/L N-S CMP West 157±

B. Description of corner evidence found and/or method applied in restoring or reestablishing corner:

Found: 1/2" Capped Rod	Accepted as a careful and faithful perpetuation of the position of the original corner.
Spike in NE side 15" Willow	N55°W 66.46'
Centerline Pavement	South 0.4'
Centerline N-S CMP	West 157±

PA. 345 OTTAWA COUNTY
PEER APPROVED 11/20/95

Randy D. Feenstra
RDJ

C. Description of monument for corner and accessories established to perpetuate locating the position of the corner:

B-3 Set Ottawa County Bar and Cap in Box	
Ottawa County Remon Nail & Tag in NE side 15" Willow	302° 66.50'
Ottawa County Remon Nail & Tag in SW side 10" Twin Elm	134° 55.59'
Ottawa County Remon Nail & Tag in W side 6"x6 Post	333° 49.33'
SE Bolt on S'ly End C.M.P.	257° 159.71'

0.4' South of Centerline Truman St.

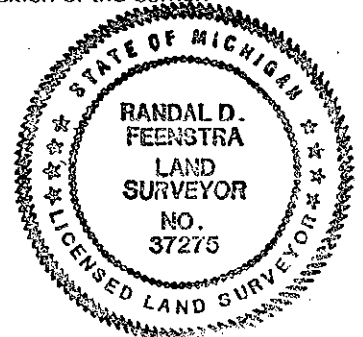

Signed by Randal D. Feenstra
37275

Date November 6, 1995

Surveyor's Michigan License No. _____