

OTTAWA COUNTY REMONUMENTATION

LAND CORNER RECORDATION CERTIFICATE Filing Requirement of Act 74, Mich. P.A. 1970

For corners in
Ottawa

Located In:

Corner Code #

(County)

Chester Twp.

T 9N R 13W

C-3, N W cor.

Sec. 8

1. Public Land Survey

T R

T R

T R

T R

2. Property Controlling
in Section

S

S

S

S

T R

T R

T R

3. Miscellaneous
Property in Sec.

S

S

T R

T R

4. Lot No. _____, Recorded Plat _____

5. Private Claims _____

I, Randal D. Feenstra, in a field survey on Sept. 10, 1996 do hereby state that under requirements of P.A. 74, Michigan P.A. of 1970, the corner points mentioned in lines 1 and 2 above were in conformance with regulations and rules therefore as required in the current manual of survey instructions of the United States Department of the Interior, Bureau of Land Management or by a decree of a Court of Law and for that the corner points mentioned in lines 3, 4 and 5 above were in conformance with the rules of the Michigan Board of Land Surveyors or by a Decree of a Court of Law; established, re-established, monumented, recovered, found as expressed below:

NOTE: Not more than 2 corners, all in the same town and range, may be recorded on this certificate.

RECORDED
97 JUL 24 PM 2:24
Randal D. Feenstra
REGISTER OF DEEDS
OTTAWA COUNTY, MI
Register of Deeds Stamp & File Number

	A	B	C	D	E	F	G	H	I	J	K	L	M
1													
2		6		5		4		3		2		1	
3			●										
4		7		8		9		10		11		12	
5													
6		18		17		16		15		14		13	
7													
8		19		20		21		22		23		24	
9													
10		30		29		28		27		26		25	
11													
12		31		32		33		34		35		36	
13													

A. Description of original monument and accessories and/or subsequent restoration:

G.L.O. (1838)

Rasselas Whitcomb

Post

14" Sugar Maple S78°E 12 lks

18" Sugar Maple N20°W 34 lks

L-3, P-337, (1979)

R.R. Spike

P. Pole

St. Sign

Flag Pole

T. Pole

SW 59.04'

SE 35.25'

NE 59.70'

NW 63.55'

L-5, P-50 (1983)

Cast Iron Monument

P. Pole SW 59.03'

T. Pole NW 63.54'

St. Sign SE 43.00'

31" Walnut WNW 98.40'

B. Description of corner evidence found and/or method applied in restoring or reestablishing corner:

C-3 Found: Cast Iron Monument

Nail in NW side P. Pole	SW	59.05'
Nail & Tag in S side 32" Walnut	WNW	98.43'
Nail in NE side T. Pole	NW	63.43'

P.A. 345 OTTAWA COUNTY
PEER APPROVED 12-9-96
R.D.F.

Accepted as a careful and faithful perpetuation of the position of the original corner.

C. Description of monument for corner and accessories established to perpetuate locating the position of the corner:

C-3 Cast Iron Monument in New Monument Box

Ottawa County Remon Nail & Tag in NW side P. Pole	S50°W	59.01'
Ottawa County Remon Nail & Tag in NE side T. Pole	N45°W	63.34'
SW Cor. Conc. Block Foundation to house	N50°E	112.15'
Ottawa County Remon Nail & Tag in S side 12" CSP	N20°E	142.35'
On Centerline 40th Ave. and Centerline Truman to East		

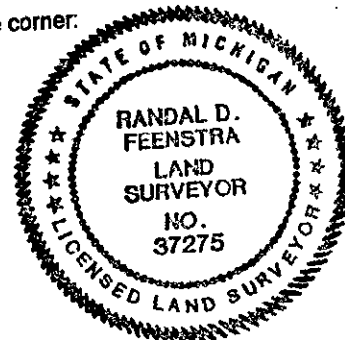

Signed by *Randal D. Feenstra*
Surveyor's Michigan License No. 37275

Date Sept. 10, 1996