

SURVEY &  
REMONUMENTATION

FEB 18 1994

COMMISSION

OTTAWA COUNTY REMONUMENTATION  
LAND CORNER RECORDATION CERTIFICATE  
Filing Requirement of Act 74, Mich. P.A. 1970

RECORDED

93 NOV -8 PM 1:59

*Phyllis Robinson*  
REGISTER OF DEEDS  
OTTAWA COUNTY, MI

For corners in

Ottawa  
(County)

Located In:

Corner Code =#

- |                                    |   |           |   |            |                         |
|------------------------------------|---|-----------|---|------------|-------------------------|
| 1. Public Land Survey              | T | <u>9N</u> | R | <u>13W</u> | <u>C-6, W 1/4 COR.</u>  |
|                                    | T |           | R |            | <u>Sec. 17, Chester</u> |
|                                    | T |           | R |            |                         |
|                                    | T |           | R |            |                         |
| 2. Property Controlling in Section | S |           | T | R          |                         |
|                                    | S |           | T | R          |                         |
| 3. Miscellaneous Property in Sec.  | S |           | T | R          |                         |
|                                    | S |           | T | R          |                         |

Register of Deeds Stamp & File Number

4. Lot No. \_\_\_\_\_, Recorded Plat \_\_\_\_\_  
5. Private Claims \_\_\_\_\_

I, Randal D. Feenstra in a field survey on October 14, 19 93, do hereby certify that under requirements of P.A. 74, Michigan P.A. of 1970, the corner points mentioned in lines 1 and 2 above were in conformance with regulations and rules therefore as required in the current manual of survey instructions of the United States Department of the Interior, Bureau of Land Management or by a decree of a Court of Law and/or that the corner points mentioned in lines 3, 4 and 5 above were in conformance with the rules of the Michigan Board of Land Surveyors or by a Decree of a Court of Law; established, re-established, monumented, re-monumented, recovered, found as expressed below:

**NOTE: Not more than 4 corners, all in the same town and range, may be recorded on this certificate.**

	A	B	C	D	E	F	G	H	I	J	K	L	M
2	6	5	4	3	2	1							
3													
4	7	8	9	10	11	12							
5													
6	18	17	16	15	14	13							
7													
8	19	20	21	22	23	24							
9													
10	30	29	28	27	26	25							
11													
12	31	32	33	34	35	36							
13													

A. Description of original monument and accessories and/or subsequent restoration:

- C-6:  
L.C.R.C.# L-4, P-257 (12-3-81)  
Cast Iron Monument  
Fence Post E. 32.70'  
Fence Post W. 36.43'  
Power Pole W. 64.46'  
4th Fence Post South SW. 51.81'

B. Description of corner evidence found and/or method applied in restoring or reestablishing corner:

- C-6: Found Cast Iron Monument in Box - accepted as a careful and faithful perpetuation of the position of the original corner.  
PK on N. side P.P. N90°W 64.42  
PK & Tag on N. side P.P. N90°W 64.48

C. Description of monument for corner and accessories established to perpetuate locating the position of the corner:

- C-6: Cast Iron Monument in Box  
O.C. Remon. Nail & Tag in N. side P.P. N90°W 64.46'  
"X" in N. end 15" CSP N60°E 30.60  
"X" in S. end 15" CSP S70°E 28.83  
O.C. Remon. Nail & Tag in E. side fence post S20°W 143.31'  
0.5' W. of 40th Ave., fence line to West, brush line to East.

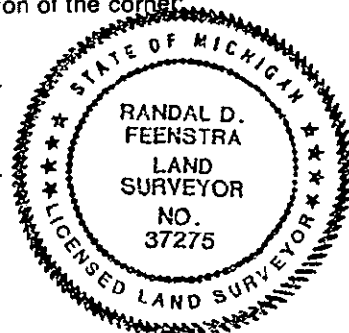

Signed by Randal D. Feenstra Date 10-18-93

Surveyor's Michigan License No. 37275